

**SOIL/SITE EVALUATION
 for ON-SITE WASTEWATER SYSTEM**

Owner: Applicant: New Home Inc
 Address: 54 Yates Mill Drive Date Evaluated: 11-28-23
 Proposed Facility: SFD 40' x 72' Design Flow (.1949): 480

Property Size:

Location of Site: Property Recorded:
 Water Supply: Public Individual Well Spring Other
 Evaluation Method: Auger Boring Pit Cut
 Type of Wastewater: Sewage Industrial Process Mixed

P R O F I L E #	.1940 Landscape Position/ Slope %	Horizon Depth (In.)	SOIL MORPHOLOGY .1941		OTHER PROFILE FACTORS				Profile Class & LTAR
			.1941 Structure/ Texture	.1941 Consistence Mineralogy	.1942 Soil Wetness/ Color	.1943 Soil Depth (IN.)	.1956 Sapro Class	.1944 Restr Horiz	
1	4-5%	0-28	SL, gr	F _r , NS, NP, SE					
		28-46	SL, SBK	F _r , SS, NP, SE	mottles ≥ 2% at 46"	48"			.4
2.	2-3%	0-19	SL, gr	F _r , NS, NP, SE					
		19-38	SCL, SBK	F _r , SS, NP, SE					
		38-48	SCL, SBK	F _r , SS, NP, SE	mottles ≥ 2% at 38"	48"			.4
3	2-3%	0-22	SL, gr	F _r , NS, NP, SE					
		22-42	SCL, SBK	F _r , SS, NP, SE					
		42-48	SCL, SBK	F _r , SS, NP, SE	mottles ≥ 2% at 42"	48"			.4
4	2-3%	0-26	SL, gr	F _r , NS, NP, SE					
		26-46	SCL, SBK	F _r , SS, NP, SE					
		46-48	CL, SBK	F _r , SS, NP, SE	mottles ≥ 2% at 46"				.4

Description	Initial System	Repair System	Other Factors (.1946): Site Classification (.1948): <u>PS</u> Evaluated By: <u>RL/STH</u> Others Present:
Available Space (.1945)	<input checked="" type="checkbox"/>	<input checked="" type="checkbox"/>	
System Type(s)	<u>25% Red</u>	<u>25% Red</u>	
Site LTAR	<u>.4</u>	<u>.4</u>	

COMMENTS: _____

LANDSCAPE POSITIONS	GROUP	TEXTURES	.1955 LTAR	CONSISTENCE MOIST	WET
R-RIDGE	I	S-SAND	1.2 - 0.8	VFR-VERY FRIABLE FR-FRIABLE	NS-NON-STICKY SS-SLIGHTLY STICKY
S-SHOULDER SLOPE		LS-LOAMY SAND			
L-LINEAR SLOPE	II	SL-SANDY LOAM	0.8 - 0.6	FI-FIRM VFI-VERY FIRM EFI-EXTREMELY FIRM	S-STICKY VS-VERY STICKY NP-NON-PLASTIC SP-SLIGHTLY STICKY
FS-FOOT SLOPE		L-LOAM			
N-NOSE SLOPE	III	SI-SILT	0.6 - 0.3		P-PLASTIC VP-VERY PLASTIC
H-HEAD SLOPE		SIL-SILT LOAM			
CC-CONCLAVE SLOPE		CL-CLAY LOAM			
CV-CONVEX SLOPE		SCL-SANDY CLAY LOAM			
T-TERRACE	IV	SIC-SILTY CLAY	0.4 - 0.1		
FP-FLOOD PLAN		C-CLAY			
		SC-SANDY CLAY			

- | | |
|-----------------------|--------------------|
| <u>STRUCTURE</u> | <u>MINERALOGY</u> |
| SG-SINGLE GRAIN | SLIGHTLY EXPANSIVE |
| M-MASSIVE | |
| CR-CRUMB | EXPANSIVE |
| GR-GRANULAR | |
| SBK-SUBANGULAR BLOCKY | |
| ABK-ANGULAR BLOCKY | |
| PL-PLATY | |
| PR-PRISMATIC | |

Show profile locations and other site features (dimensions, references or benchmark, and North)

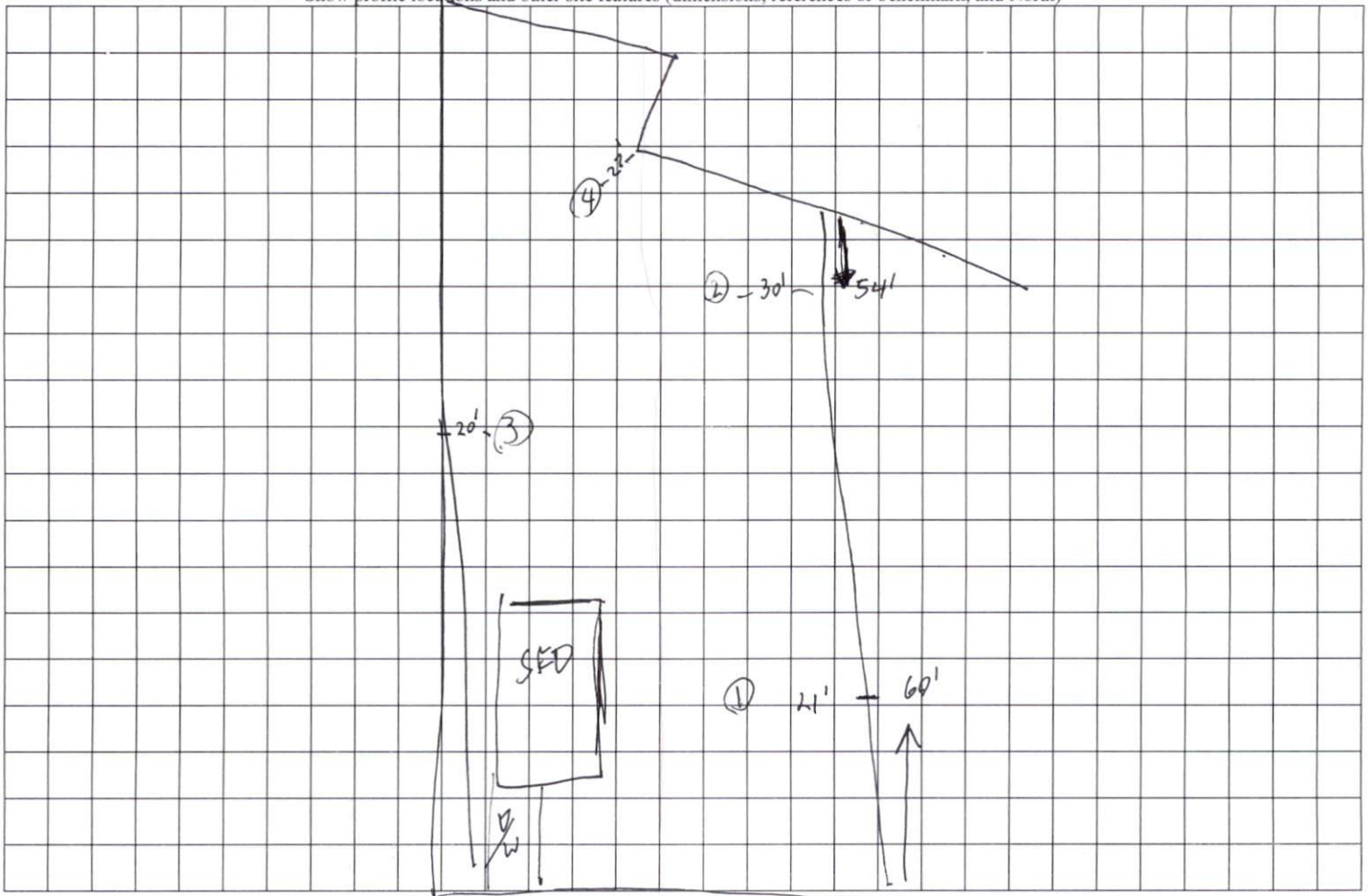

Yates mill Dr.

PLOT PLAN FOR
NEW HOME INC., LLC
 54 YATES MILL DRIVE
 LOT 2, WOODBRIDGE SOUTH
 BUCKHORN TOWNSHIP, HARNETT COUNTY, NORTH CAROLINA

LEGEND

- AC AIR CONDITIONER
- BC BACK OF CURB
- BFP BACK FLOW PREVENTER
- C CLEANOUT
- CI CURB INLET
- DHS DRILL HOLE SET
- ECM EXISTING CONCRETE MONUMENT
- EDH EXISTING DRILL HOLE
- EIS EXISTING IRON STAKE
- EIP EXISTING IRON PIPE
- EM ELECTRIC METER
- EPK EXISTING PK NAIL
- ES ELECTRIC STUB
- FLA FLARED END SECTION
- FR FIRE HYDRANT
- FOP FIBER OPTIC PEDESTAL
- GM GAS METER
- GUY GUY
- INV INVERT
- IPS IRON PIPE SET
- IRS IRON ROD SET
- LP LIGHT POLE
- MNS MAGNETIC NAIL SET
- MS MANHOLE SANITARY SEWER
- MS MANHOLE STORM SEWER
- OHV OVERHEAD WIRES
- PKS PK NAIL SET
- PNS POINT NAIL SET
- RRS RAIL ROAD SPIKE
- TEP TELEPHONE PEDESTAL
- TR TRANSFORMER
- UTV UTILITY POLE
- WM WATER METER
- WV WATER VALVE
- YI YARD INLET
- () FIELD MEASUREMENT

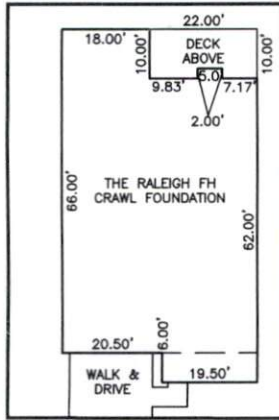

INSET
SCALE: 1"=30'

15' UTILITY EASEMENT

YATES MILL DRIVE
 50' PUBLIC R/W & UTILITY EASEMENT

LINE	BEARING	DISTANCE
L1	S 88°31'39" E	27.00'

NUM	RADIUS	ARC	DELTA	CHORD BRG	CHORD
C1	475.00'	59.53'	7°10'50"	S 31°44'02" E	59.49'

IMPERVIOUS SURFACES	
HOUSE	2,550 S.F.
WALK & DRIVE	760 S.F.
DECK (210 S.F.)	0 S.F.
TOTAL	3,310 S.F.
MAXIMUM IMPERVIOUS	4,000 S.F.

REFERENCES:
 P.B. 2023, PGS 92-94

SETBACK INFO

FRONT: _____ 35'
 REAR: _____ 25'
 SIDES: _____ 10'
 CORNER SIDE: _____ 20'



NOTES
 SCALE: 1" = 50'

1. THIS SURVEY SUBJECT TO ANY FACTS THAT MAY BE DISCLOSED BY A FULL AND ACCURATE TITLE SEARCH.
2. THIS MAP MAY NOT BE A CERTIFIED SURVEY AND HAS NOT BEEN REVIEWED BY A LOCAL GOVERNMENT AGENCY FOR COMPLIANCE WITH ANY APPLICABLE LAND DEVELOPMENT REGULATIONS AND HAS NOT BEEN REVIEWED FOR COMPLIANCE WITH RECORDING REQUIREMENTS FOR PLATS.

PLOT PLAN
 PRELIMINARY PLAT- NOT FOR RECORDATION,
 CONVEYANCE OR SALES

REV CODE: 1.FLP, 2.PLAN, 3.ROTATE, 4.MOVE, 5.SS
 6.SEVERAL OF ABOVE, 7.LAND FEATURE, 8. OTHER

DATE: NOV. 1, 2023

F.B. _____

RWK, PA
ENGINEERING - SURVEYING
 CORPORATE LICENSE: C-1771
 101 W. MAIN ST., SUITE 202
 GARNER, NC 27529
 PHONE (919) 779-4854
 FAX (919) 779-4056

4-5% LS
6, 0-28 SL
28-46 SCL Fr, S~~SL~~, SS, NP, SE .4
46-48 SCL out 46"

2-3% LS
2, 0-19 SL
19-38 SCL Fr, S~~SL~~, SS, NP, SE .4
38-48 SCL out 38"

2-3% LS
3, 0-22 SL S~~SL~~, Fr, SS, NP, SE
22-42 SCL
42-48 CL out 42"

2-3% LS
4, 0-26 SL
26-46 SCL Fr, S~~SL~~, SS, NP, SE
46-48 EL out 46"