

**WARNING!** Long span trusses, 60' or greater in length, require extreme care and experience for proper and safe handling and installation. For general handling and installation guidance, see the "Guide to Good Practice for Handling, Installing, Restraining & Bracing of Metal Plate Connected Wood Trusses" ("BCSI"), JOINTLY PRODUCED BY SBCA and TPI. For project specific guidance, consult with a registered design professional. ATLANTIC assumes no responsibility for the handling, installation or bracing of trusses.

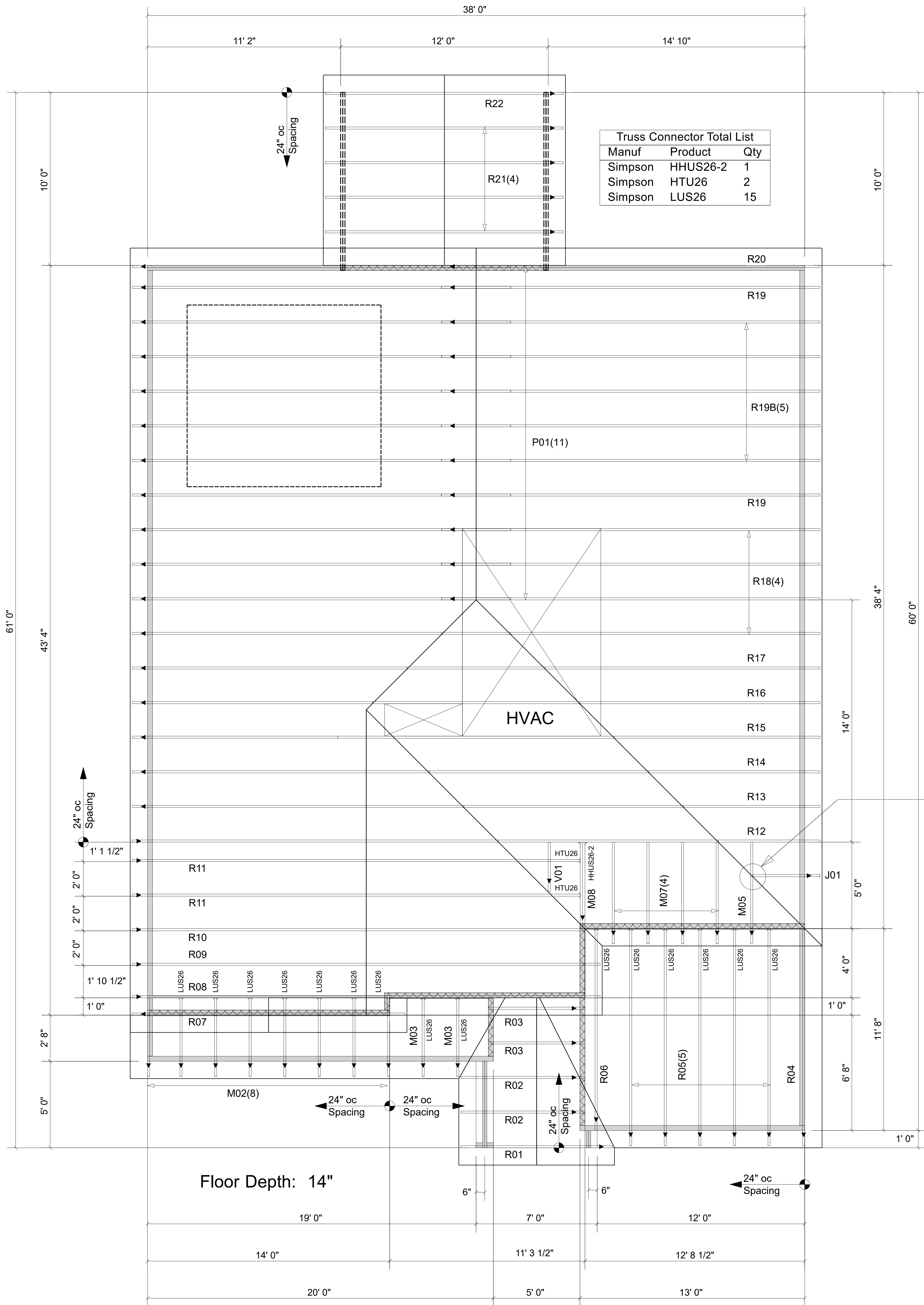

| Truss Connector Total List |          |     |
|----------------------------|----------|-----|
| Manuf                      | Product  | Qty |
| Simpson                    | HHUS26-2 | 1   |
| Simpson                    | HTU26    | 2   |
| Simpson                    | LUS26    | 15  |

Extreme care must be taken to not set any of these trusses backwards.

For all small open-ended mono trusses, use (3) 10d toe nails in the top chord and (3) 10d toe nails in the bottom chord.

▲ = LEFT END OF TRUSS

FOR PERMIT



Moncks Corner/Easley, SC (800) 475-3999  
Sparta, NC (336) 372-2226

REVISIONS:

Client: **MATTAMY HOMES-RALEIGH**  
Job: **LOT 37 PROVIDENCE CREEK**  
Plan Information:  
**SEQUOIA-FC**

NOT TO SCALE

Date: 10/19/23

Drawn By: MBB

Job #: Sales Rep: KYLE GIBSON  
23-7731-R01 Phone:

ROOF