

Products				
PlotID	Length	Product	Plies	Net Qty
J2-1	38' 0"	14" BCI® 6000s-1.8	1	10
J2-2	26' 0"	14" BCI® 6000s-1.8	1	2
J2-3	21' 0"	14" BCI® 6000s-1.8	1	19
J2-4	20' 0"	14" BCI® 6000s-1.8	1	1
J2-5	19' 0"	14" BCI® 6000s-1.8	1	3
J2-6	17' 0"	14" BCI® 6000s-1.8	1	9
J2-7	13' 0"	14" BCI® 6000s-1.8	1	2
J2-8	7' 0"	14" BCI® 6000s-1.8	1	2
J2-9	5' 0"	14" BCI® 6000s-1.8	1	1
J2-10	4' 0"	14" BCI® 6000s-1.8	1	1
BM2-3 (D)	10' 0"	1-3/4" x 9-1/2" VERSA-LAM® 2.0 3100 SP	2	2
BM2-1 (D)	8' 0"	1-3/4" x 9-1/2" VERSA-LAM® 2.0 3100 SP	2	4
BM2-2 (D)	20' 0"	1-3/4" x 11-7/8" VERSA-LAM® 2.0 3100 SP	2	2
BM2-4 (R)	20' 0"	1-3/4" x 14" VERSA-LAM® 2.0 3100 SP	3	3
BM2-5 (R)	10' 0"	1-3/4" x 14" VERSA-LAM® 2.0 3100 SP	2	2
Rim1	12' 0"	1-1/8" x 14" BC RIM BOARD OSB	1	16
Blk1	2' 0"	14" BLOCKING	1	13

Connector Summary			
Qty	Manuf	Product	Flange
15	Simpson	IUS2.37/14	None

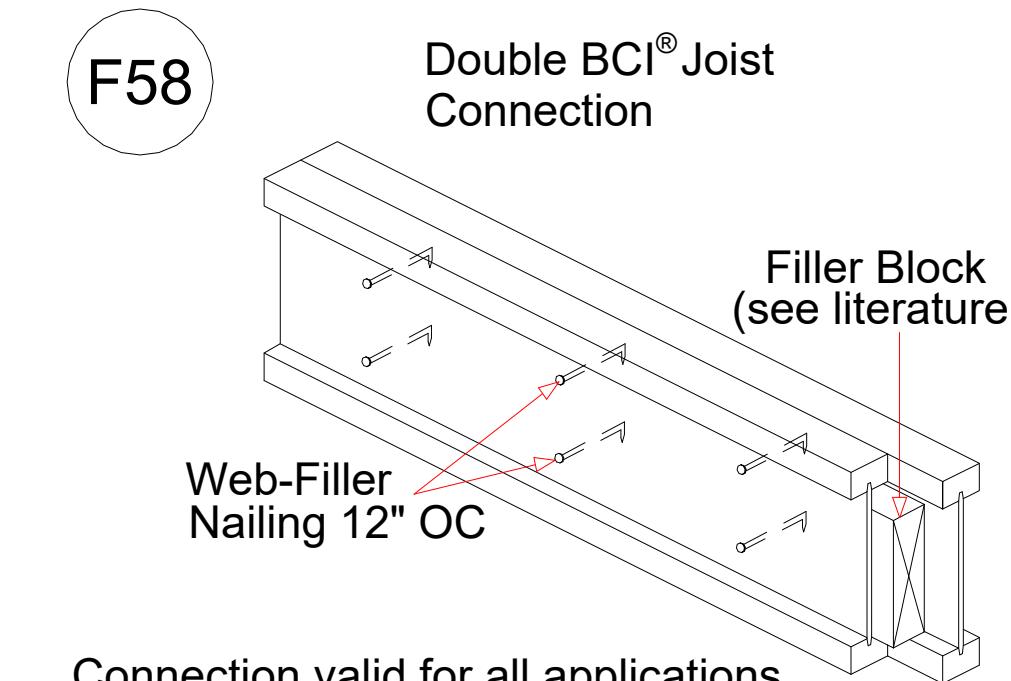

FOR PERMIT

Client: **MATTAMY HOMES-RALEIGH**
 Job: **LOT 37 PROVIDENCE CREEK**
 Plan Information: **SEQUOIA-FC**
 NOT TO SCALE
 Date: 10/19/23
 Job #: 23-7731-J02
 Sales Rep: KYLE GIBSON
 Drawn By: MBB
 Phone: 843-729-3249

▲ = LEFT END OF TRUSS

REVISIONS:



Moncks Corner/Easley, SC (800) 475-3999
 Sparta, NC (336) 372-2226