

Second Floor:

Products				
PlotID	Net Qty	Product	Length	Plies
FJ1	5	14" BCI@ 5000s-1.8	27' 0"	1
FJ2	7	14" BCI@ 5000s-1.8	26' 0"	1
FJ3	11	14" BCI@ 5000s-1.8	18' 0"	1
FJ4	5	14" BCI@ 5000s-1.8	17' 0"	1
FJ5	9	14" BCI@ 5000s-1.8	10' 0"	1
FJ6	1	14" BCI@ 5000s-1.8	8' 0"	1
BM1	2	1-3/4" x 14" VERSA-LAM@ 2.0 3 100 5P	10' 0"	2
BM2	2	1-3/4" x 14" VERSA-LAM@ 2.0 3 100 5P	6' 0"	2
BBO1	2	1 3/4" x 1' 6" Generic Material	22' 0"	2
RB1	13	1" x 14" BC RIM BOARD OSB	12' 0"	1
BK1	1	14" BCI@ 5000s-1.8	17' 0"	1

Connector Summary			
PlotID	Qty	Manuf	Product
H1	15	Simpson	US2.06/14

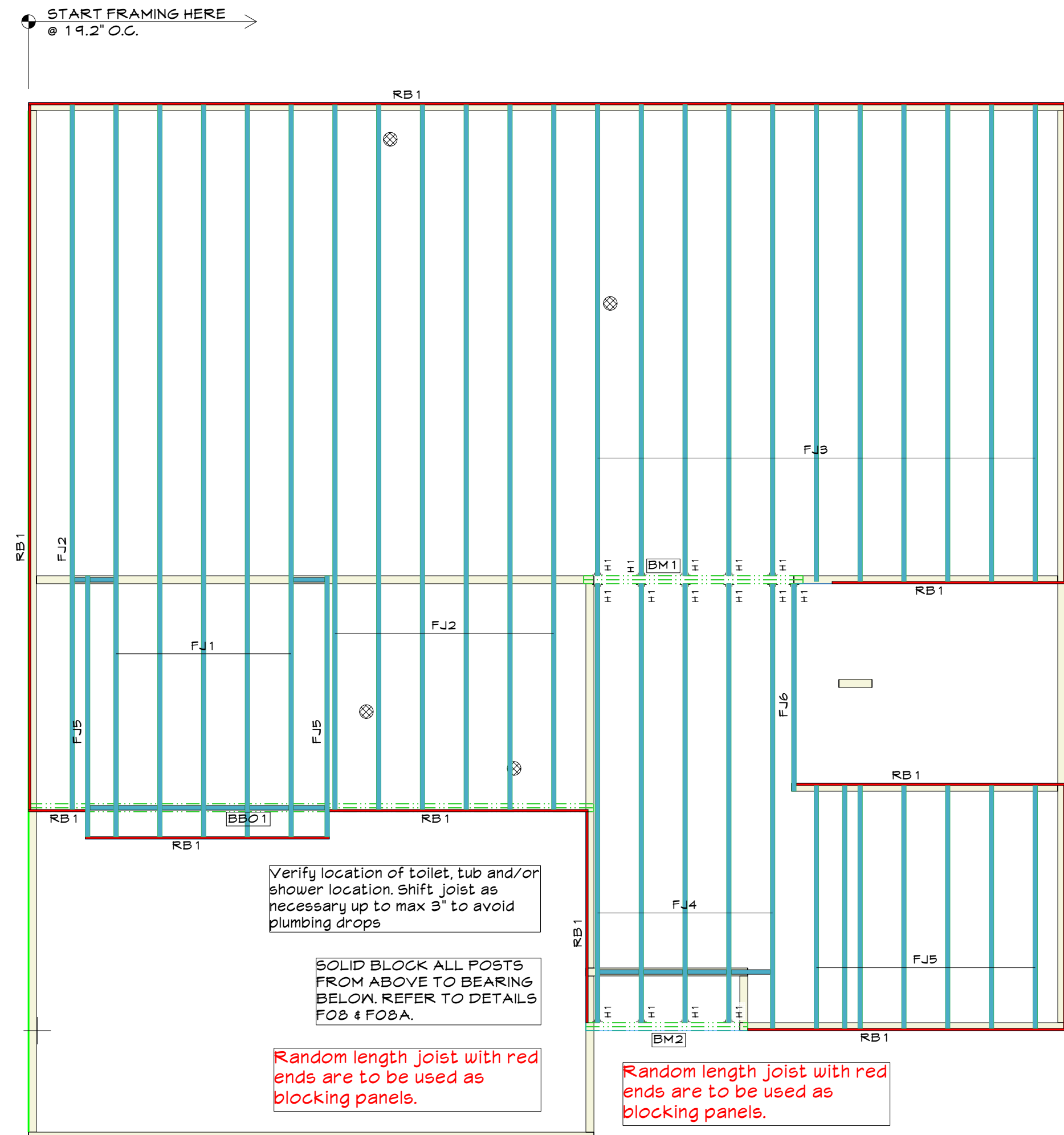

General Notes:

- See Boise Cascade Installation Guide for installation/framing details.
- All Measurements to be verified in the field.
- All I-Joist, LVL beams, and Rim Board must be field cut to length.
- Contractor to verify and approve the provided material list on this layout.
- The material provided is sold as a complete package, custom cut for this job; therefore, any cut lengths or pieces of cut lengths MAY NOT be returned for credit.
- Any material discrepancies must be reported before installation. Contact Talbert Building Supply at 336-599-1135.
- See original blueprints for additional structural notes.
- Ceramic tiles floors should be supported per APA standards. Additional joists may be required.
- Plumbing, HVAC, and Electrical trade to reference Boise Cascade Specifier or Installation Guide for hole cutting information.
- Boise Cascade/Talbert Building Supply is NOT the Engineer of Record. These plans are for the EoR to review and verify all bracing/load points are picked up properly. These plans are for gravity loads only and NOT lateral. Design and pricing hinges on EoR review/approval.
- Framer Note: Install all LVL with stamps/printing facing out for visibility.
- This layout was designed based on the Construction Documents and instruction provided to Talbert Building Supply by the contractor/home owner.

Builder:
Drees Homes
Job Name:
Lot 234 Serenity
Address:

Fuqua Varina, NC

Date: 1/8/2023

By: Wallace



DN01 DO NOT cut, notch or drill flanges

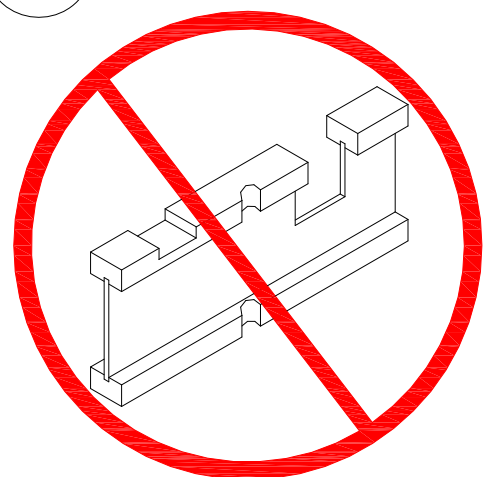

F06

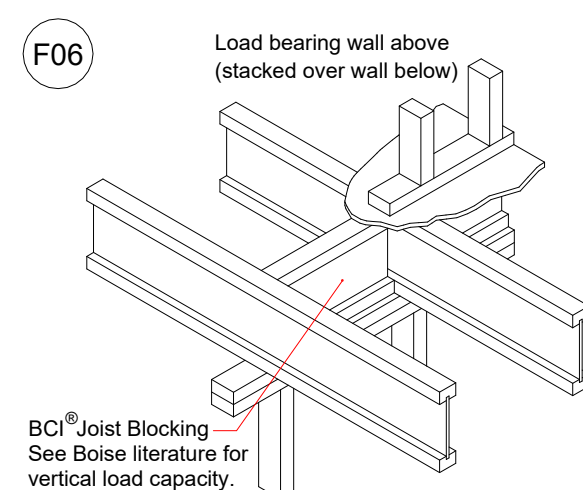

BCI® Joist Blocking. See Boise literature for vertical load capacity.

F07

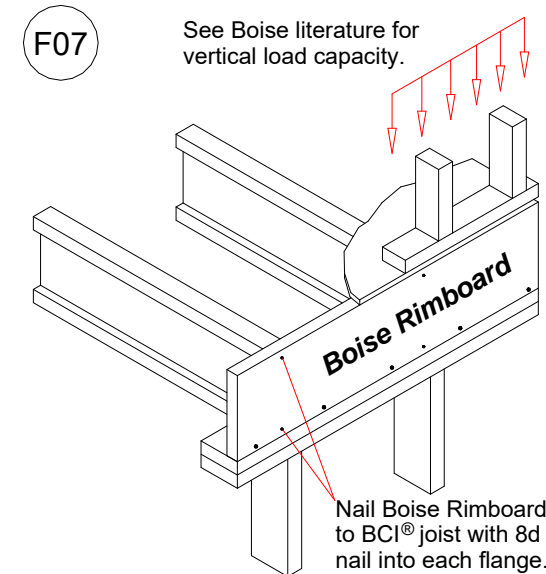

Nail Boise Rimboard to BCI® joist with 8d nail into each flange.

F08

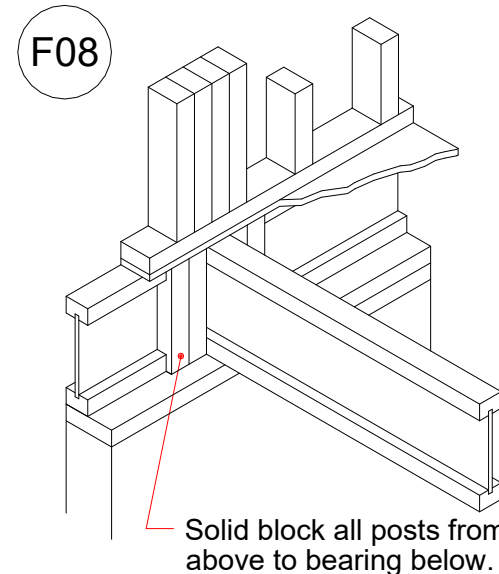

Solid block all posts from above to bearing below.

OJ-A

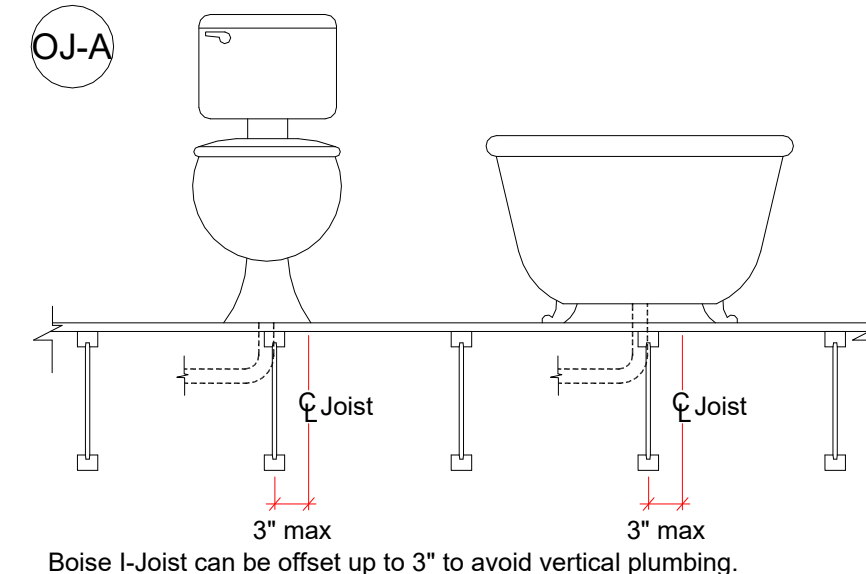

Boise I-Joist can be offset up to 3" to avoid vertical plumbing.