

VICINITY MAP
Not To Scale

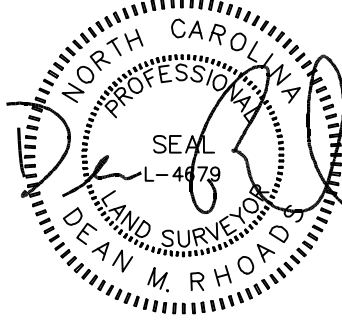

IMPERVIOUS SURFACE AREA	
DESCRIPTION	AREA
HOUSE w/ PORCH	3,335 S.F.
SC PORCH/MISC	304 S.F.
DRIVEWAY & WALKS	987 S.F.
TOTAL (PROPOSED)=	4,626 S.F.
*TOTAL (ALLOWED)=	4,208 S.F.

*PB 2023 PG 241

SETBACKS: (PB 2023 PG 240)

FRONT: 35' FROM R/W
REAR: 25'
SIDE: 10'
CORNER LOT SIDE: 20'



N/F
RUBY B. FORE
MARSHA F. BOWLES
DB 3880 PG 220

N/F
RODNEY W. TROGDON
LYNN H. TROGDON
DB 3474 PG 818

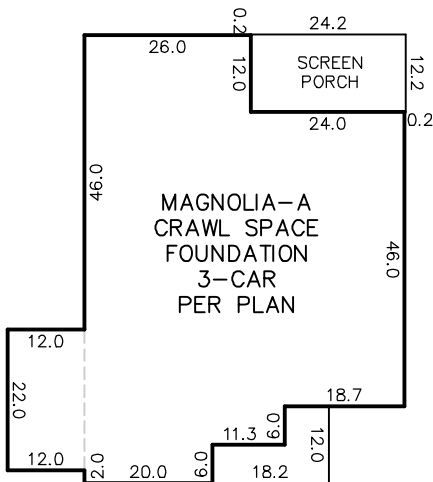

INSET
N.T.S.

FENCE ENCKROACHES
±17.7' ONTO EASEMENT

42

15' PUBLIC
UTILITY EASEMENT

CASTLE POND WAY
50' PUBLIC R/W & UTILITY EASEMENT

LINE	BEARING	DISTANCE
L1	N86°05'00"E	22.51'

CURVE	RADIUS	ARC LENGTH	CH LENGTH	CH BEARING
C1	50.00'	6.98'	6.97'	N51°15'00"E
C2	25.00'	28.47'	26.96'	S79°52'55"W
C3	255.00'	117.61'	116.57'	S80°42'15"E

THIS PROPERTY MAY BE SUBJECT TO ANY AND ALL APPLICABLE DEED RESTRICTIONS, EASEMENTS, RIGHT-OF-WAY, UTILITIES AND RESTRICTIVE COVENANTS WHICH MAY BE OF RECORD OR IMPLIED

THIS DRAWING DOES NOT
REFLECT AS-BUILT INFORMATION

PRELIMINARY PLAT
NOT FOR RECORDATION, CONVEYANCES, OR SALES.

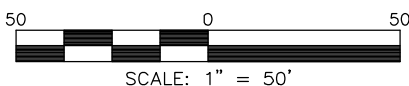

SCALE: 1" = 50'

**RESIDENTIAL
LAND SERVICES, PLLC.**

1917 Evans Road
Cary, North Carolina 27513
Phone (919) 378-9316
Firm License # P-0873

HOUSE LOCATION PLOT PLAN

FOR
#345 CASTLE POND WAY
LOT 43, PRINCE PLACE, PHASE 2

Hectors Creek Township, Harnett County, North Carolina

PROPERTY OF: DAVIDSON HOMES

PLAT BOOK 2023 PAGE 240-241 DEED REFERENCE _____

DRAWN: JLA

SURVEYED: N/A

CHECKED: DMR

DATE: SEPTEMBER 26, 2023