

Revised For well location

HARNETT DEPARTMENT OF PUBLIC HEALTH PERMIT
TO CONSTRUCT A DRINKING WATER SUPPLY WELL.

PIN #: Parcel #: Application #: Subdivision: _____ Lot #:

SFD 2310-0026

Applicant Name: Nicholas Thompson

Address: 178 Collins Rd (SR 1259)

Type of Facility Served by Well: SFD 50' x 44' SFD

Sewage System: Existing Septic System, 25% reduction (6 Br Design)

Permit Conditions: Well to be drilled in Well Area

General Permit Conditions:

- Drinking water supply well construction must meet 15A NCAC 02C.100 rules
- The permitted drinking water supply well shall be located in accordance with the **SITE PLAN**
- **ANY ALTERATION** of the site of the site (including location of structures and appurtenance) or modification in use of the well, may subject this Permit to revocation

Authorized State Agent Mohamed A. AHS Date _____ Expiration Date 11-3-28
* Construction Authorization Expires within five years of issue

Grouting Inspection Witnessed _____ Date 12-14-23
 Grouting self-certified by driller GW-1 provided? Yes No

See attachment for construction sketch

WELL CERTIFICATE OF COMPLETION

Date: _____ Application #: _____ Well Contractor: _____

Applicant Name: _____

Address: _____

Directions to Site: _____

Use of Well: _____ Date Drilled: _____ Total Depth: _____ Replacement Well? Yes No
Static Water Level: _____ Top of Casing is _____ in. above surface. Yield: _____ gpm at _____ ft.
Disinfection: Type _____ Amount _____

Water Zone (depth)

From _____ To _____

From _____ To _____

From _____ To _____

Casing

From _____ To _____ Diameter: _____ Material: _____ Thickness: _____

From _____ To _____ Diameter: _____ Material: _____ Thickness: _____

From _____ To _____ Diameter: _____ Material: _____ Thickness: _____

From _____ To _____ Diameter: _____ Material: _____ Thickness: _____

From _____ To _____ Diameter: _____ Material: _____ Thickness: _____

From _____ To _____ Diameter: _____ Material: _____ Thickness: _____

From _____ To _____ Diameter: _____ Material: _____ Thickness: _____

Grout

From 0 To _____ Material: _____ Method: _____

From _____ To _____ Material: _____ Method: _____

From _____ To _____ Material: _____ Method: _____

From _____ To _____ Material: _____ Method: _____

From _____ To _____ Material: _____ Method: _____

From _____ To _____ Material: _____ Method: _____

From _____ To _____ Material: _____ Method: _____

Inspector: _____ On Hold Date: _____ Release Date: _____

Remarks: _____

Well Head Information

Casing Height: _____ (above finished grade) Access Port _____ Vent Stack: _____

Well ID Tag: _____ Pump ID Tag: _____ Sampling Tap: _____ Backflow Preventer: _____

Sample Taken? Yes No Well Head properly sealed _____

Remarks: _____

Authorized State Agent _____ Date _____

See Attachment for completion sketch

Application #: Applicant Name: Subdivision: Lot #:
SFD2310-0026 Nicholas Thompson

Well Construction Sketch

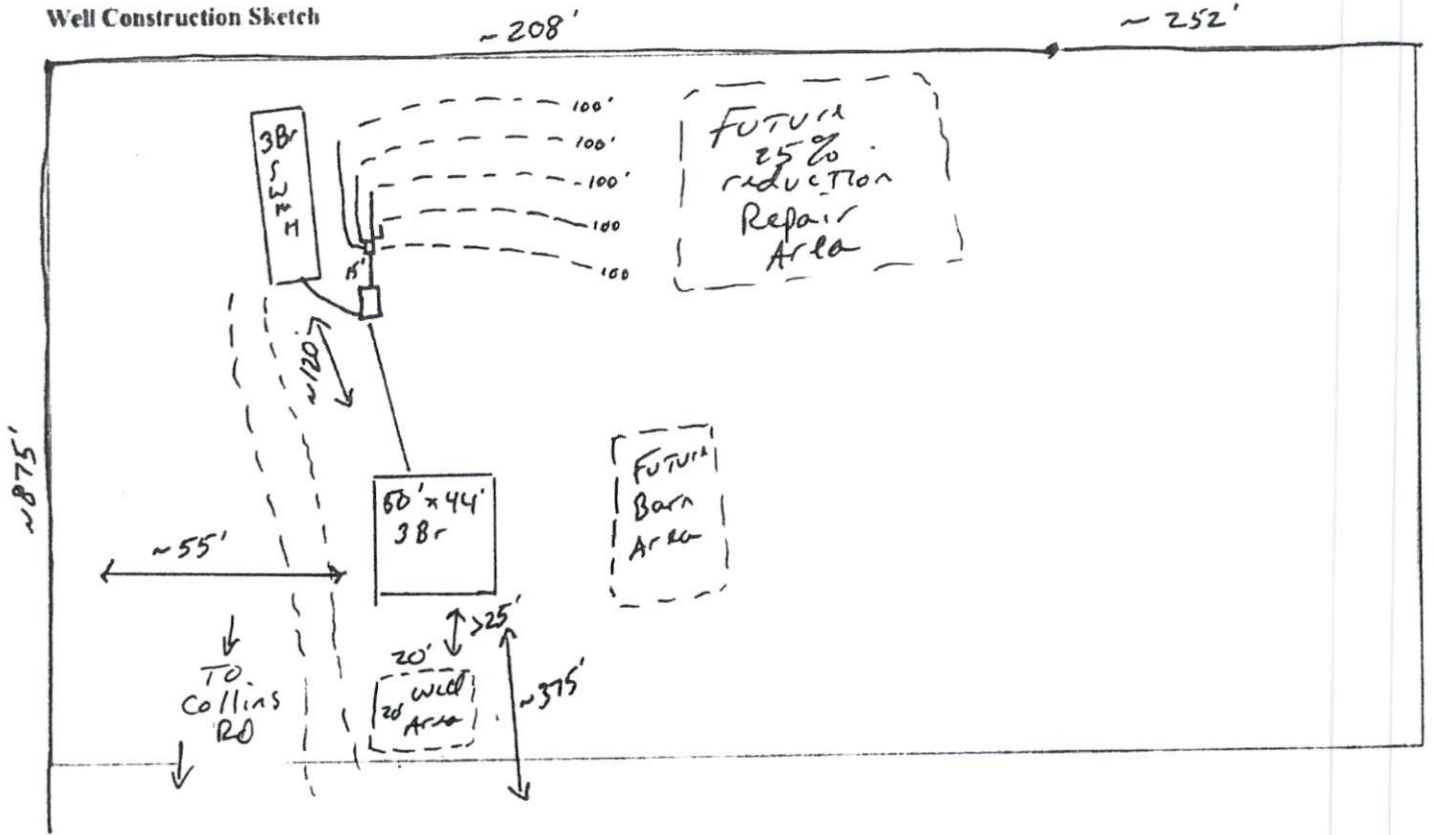

Well Completion Sketch

