

PLOT PLAN FOR  
**NEW HOME INC., LLC**  
 338 YATES MILL DRIVE  
 LOT 9, WOODBRIDGE SOUTH  
 BUCKHORN TOWNSHIP, HARNETT COUNTY, NORTH CAROLINA

OPEN SPACE

N 38°59'21" W 91.67' N 00°52'43" E 128.19'

SETBACK LINES

9

46,721 S.F.  
 1.073 AC.

N/F  
 RANDY & JOSHUA JONES  
 DB 3515, PG 836

**LEGEND**

- ◻ AIR CONDITIONER
- BC BACK OF CURB
- BFP BACK FLOW PREVENTER
- CLEANOUT
- ◻ CURB INLET
- DHS DRILL HOLE SET
- ECM EXISTING CONCRETE MONUMENT
- EDH EXISTING DRILL HOLE
- EIS EXISTING IRON STAKE
- EIP EXISTING IRON PIPE
- EM ELECTRIC METER
- EPK EXISTING PK NAIL
- ES ELECTRIC STUB
- FLR FLARED END SECTION
- FHY FIRE HYDRANT
- FOP FIBER OPTIC PEDESTAL
- GM GAS METER
- GUY GUY
- INV. INVERT
- IPS IRON PIPE SET
- IRS IRON ROD SET
- LP LIGHT POLE
- MNS MAGNETIC NAIL SET
- MS MANHOLE SANITARY SEWER
- MSW MANHOLE STORM SEWER
- OHW OVERHEAD WIRES
- PKS PK NAIL SET
- PNS POINT NOT SET
- RRS RAIL ROAD SPIKE
- TEP TELEPHONE PEDESTAL
- TRF TRANSFORMER
- CTV CABLE TV PEDESTAL
- UP UTILITY POLE
- WM WATER METER
- WV WATER VALVE
- YI YARD INLET
- ( ) FIELD MEASUREMENT

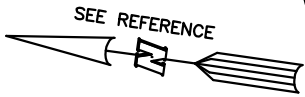

(10)

N 66°39'40" E 355.62'

L1

N 88°54'40" E 198.62'

(8)

SEE INSET

IMPERVIOUS SURFACES	
HOUSE	1,600 S.F.
WALK & DRIVE	800 S.F.
DECK (150 S.F.)	0 S.F.
<b>TOTAL</b>	<b>2,400 S.F.</b>
<b>MAX. IMPERVIOUS</b>	<b>4,000 S.F.</b>

**SETBACK INFO**

- FRONT: \_\_\_\_\_ 35'
- REAR: \_\_\_\_\_ 25'
- SIDES: \_\_\_\_\_ 10'
- CORNER SIDE: \_\_\_\_\_ 20'

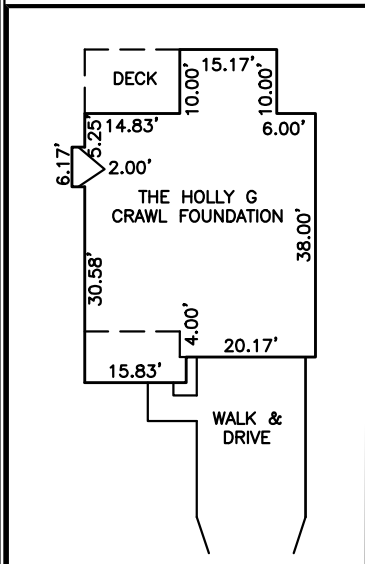

INSET: SCALE: 1"=30'

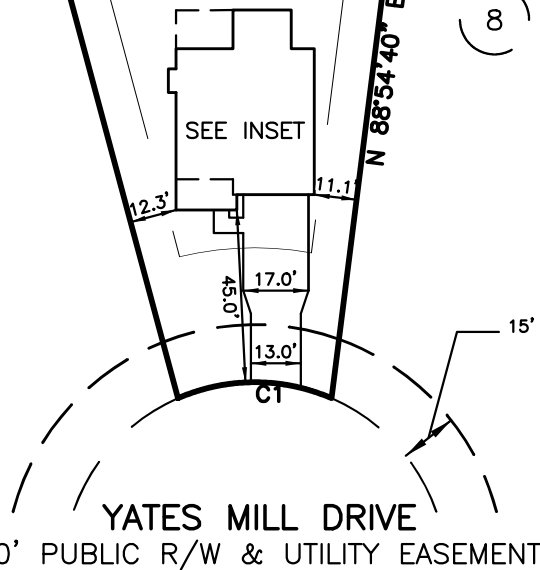

NUM	RADIUS	ARC	DELTA	CHORD BRG	CHORD
C1	50.00'	41.15'	47°09'21"	N 08°16'51" W	40.00'

LINE	BEARING	DISTANCE
L1	S 00°23'45" W	20.00'



SCALE: 1" = 50'

**NOTES**

1. THIS SURVEY SUBJECT TO ANY FACTS THAT MAY BE DISCLOSED BY A FULL AND ACCURATE TITLE SEARCH.
2. THIS MAP MAY NOT BE A CERTIFIED SURVEY AND HAS NOT BEEN REVIEWED BY A LOCAL GOVERNMENT AGENCY FOR COMPLIANCE WITH ANY APPLICABLE LAND DEVELOPMENT REGULATIONS AND HAS NOT BEEN REVIEWED FOR COMPLIANCE WITH RECORDING REQUIREMENTS FOR PLATS.

**REFERENCES:**

P.B. 2023, PGS 92-94

PLOT PLAN  
 PRELIMINARY PLAT- NOT FOR RECORDATION,  
 CONVEYANCE OR SALES

REV CODE: 1.FLIP, 2.PLAN, 3.ROTATE, 4.MOVE, 5.SS  
 6.SEVERAL OF ABOVE, 7.LAND FEATURE, 8. OTHER

REV1: OCT. 12, 2023(4)  
 DATE: OCT. 6, 2023

F.B. \_\_\_\_\_

**RWK, PA**

ENGINEERING ~ SURVEYING

CORPORATE LICENSE: C-1771  
 101 W. MAIN ST., SUITE 202  
 GARNER, NC 27529  
 PHONE (919) 779-4854  
 FAX (919) 779-4056