

Products				
PlotID	Length	Product	Plies	Net Qty
J2-1	36-0-0	14" BCI@ 6000s-1.8	1	7
J2-2	21-0-0	14" BCI@ 6000s-1.8	1	3
J2-3	20-0-0	14" BCI@ 6000s-1.8	1	5
J2-4	20-0-0	14" BCI@ 6000s-1.8	2	2
J2-5	18-0-0	14" BCI@ 6000s-1.8	1	8
J2-6	17-0-0	14" BCI@ 6000s-1.8	1	13
J2-7	12-0-0	14" BCI@ 6000s-1.8	1	3
J2-8	9-0-0	14" BCI@ 6000s-1.8	1	1
J2-9	5-0-0	14" BCI@ 6000s-1.8	1	3
J2-10	4-0-0	14" BCI@ 6000s-1.8	1	11
BM2-1	10-0-0	1-3/4" x 11-7/8" VERSA-LAM@ 2.0 3100 SP	2	2
BM2-2	20-0-0	1-3/4" x 14" VERSA-LAM@ 2.0 3100 SP	2	2
BM2-3	12-0-0	1-3/4" x 14" VERSA-LAM@ 2.0 3100 SP	2	4
BM2-4	8-0-0	1-3/4" x 14" VERSA-LAM@ 2.0 3100 SP	2	2
Rim1	12-0-0	1-1/8" x 14" BC RIM BOARD OSB	1	16
Blk1	2-0-0	14" BLOCKING	1	24

Connector Summary			
Qty	Manuf	Product	Flange
21	Simpson	IUS2.37/14	None

F58

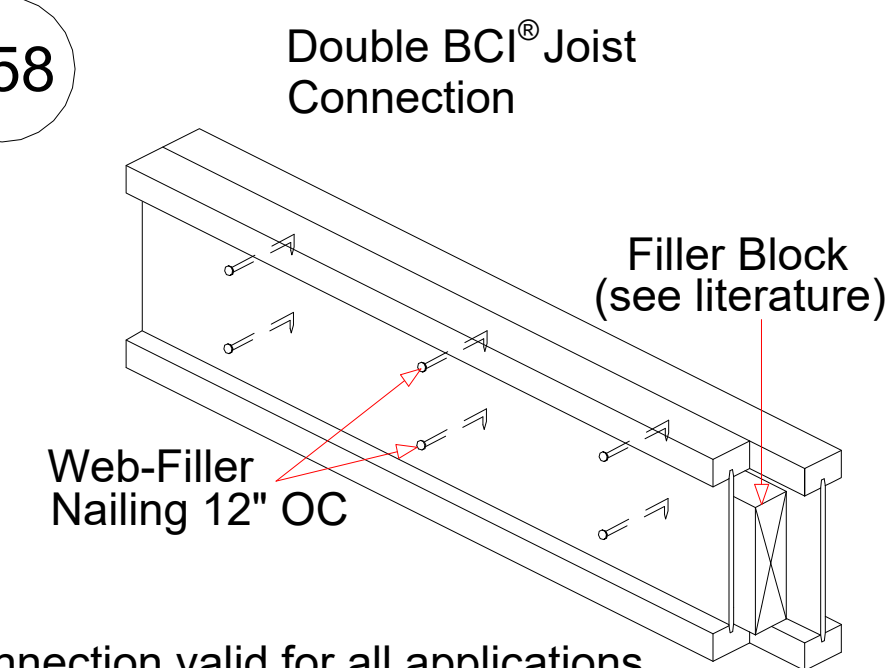

Connection valid for all applications. Contact Boise EWP Engineering for specific conditions.

FOR PERMIT

Client: **MATTAMY HOMES-RALEIGH**
 Job: **LOT 51 PROVIDENCE CREEK**
 Plan Information: **REDWOOD-FH**
 NOT TO SCALE
 Drawn By: MBB
 Date: 09/14/23
 Job #: 23-6773-J02
 Sales Rep: KYLE GIBSON
 Phone: 843-729-3249

▲ = LEFT END OF TRUSS

REVISIONS:



Moncks Corner/Easley, SC (800) 475-3999
 Sparta, NC (336) 372-2226

I-JOISTS