

**SOIL/SITE EVALUATION
 for ON-SITE WASTEWATER SYSTEM**

Owner: Weaver Applicant:
 Address: 58 Hillwood Dr
 Proposed Facility: SFD

Date Evaluated: 10-13-23

Lot 50

Location of Site: Property Recorded: Property Size:
 Water Supply: Public Individual Well Spring Other
 Evaluation Method: Auger Boring Pit Cut
 Type of Wastewater: Sewage Industrial Process Mixed

| P R O F I L E # | .1940 Landscape Position/ Slope % | Horizon Depth (In.) | SOIL MORPHOLOGY .1941 | | OTHER PROFILE FACTORS | | | | Profile Class & LTAR |
|--------------------------------------|--|---------------------------|--------------------------------|------------------------------------|------------------------------------|------------------------------|-------------------------|-------------------------|----------------------------|
| | | | .1941 Structure/ Texture | .1941 Consistence Mineralogy | .1942 Soil Wetness/ Color | .1943 Soil Depth (IN.) | .1956 Sapro Class | .1944 Restr Horiz | |
| 1,2 | L | 0-30 | LS | Fr/usp/ncp | >48" | >48" | — | — | PS-5 |
| | 2-5% | 30-48 | sc1 | Fr/ssp/ncp | | | | | |
| 3 | L | | | Fr/usp/ncp | >48" | >48" | — | — | S.6 |
| | 2-5% | 0-30 | LS | Fr/usp/ncp | | | | | |
| | | 30-48 | SL | | | | | | |

| | | | |
|-------------------------|-------------------------------------|-------------------------------------|--|
| Description | Initial System | Repair System | Other Factors (.1946): |
| Available Space (.1945) | <input checked="" type="checkbox"/> | <input checked="" type="checkbox"/> | PS |
| System Type(s) | <input checked="" type="checkbox"/> | <input checked="" type="checkbox"/> | Site Classification (.1948): Evaluated By: <u>M. W. RETTS</u> |
| Site LTAR | <u>.5</u> | <u>.5</u> | Others Present: <u>A. T.</u> |

COMMENTS: _____

| LANDSCAPE POSITIONS | GROUP | TEXTURES | .1955 LTAR | CONSISTENCE MOIST | WET |
|---------------------|-------|---------------------|------------|--------------------|--------------------|
| R-RIDGE | I | S-SAND | 1.2 - 0.8 | VFR-VERY FRIABLE | NS-NON-STICKY |
| S-SHOULDER SLOPE | | LS-LOAMY SAND | | FR-FRIABLE | SS-SLIGHTLY STICKY |
| L-LINEAR SLOPE | II | SL-SANDY LOAM | 0.8 - 0.6 | FI-FIRM | S-STICKY |
| FS-FOOT SLOPE | | L-LOAM | | VFI-VERY FIRM | VS-VERY STICKY |
| N-NOSE SLOPE | III | SI-SILT | 0.6 - 0.3 | EFI-EXTREMELY FIRM | NP-NON-PLASTIC |
| H-HEAD SLOPE | | SIL-SILT LOAM | | | SP-SLIGHTLY STICKY |
| CC-CONCLAVE SLOPE | IV | CL-CLAY LOAM | 0.4 - 0.1 | | P-PLASTIC |
| CV-CONVEX SLOPE | | SCL-SANDY CLAY LOAM | | | VP-VERY PLASTIC |
| T-TERRACE | | SIC-SILTY CLAY | | | |
| FP-FLOOD PLAN | | C-CLAY | | | |
| | | SC-SANDY CLAY | | | |

STRUCTURE
 SG-SINGLE GRAIN
 M- MASSIVE
 CR-CRUMB
 GR-GRANULAR
 SBK-SUBANGULAR BLOCKY
 ABK-ANGULAR BLOCKY
 PL-PLATY
 PR-PRISMATIC

MINERALOGY
 SLIGHTLY EXPANSIVE
 EXPANSIVE

Show profile locations and other site features (dimensions, references or benchmark, and North)

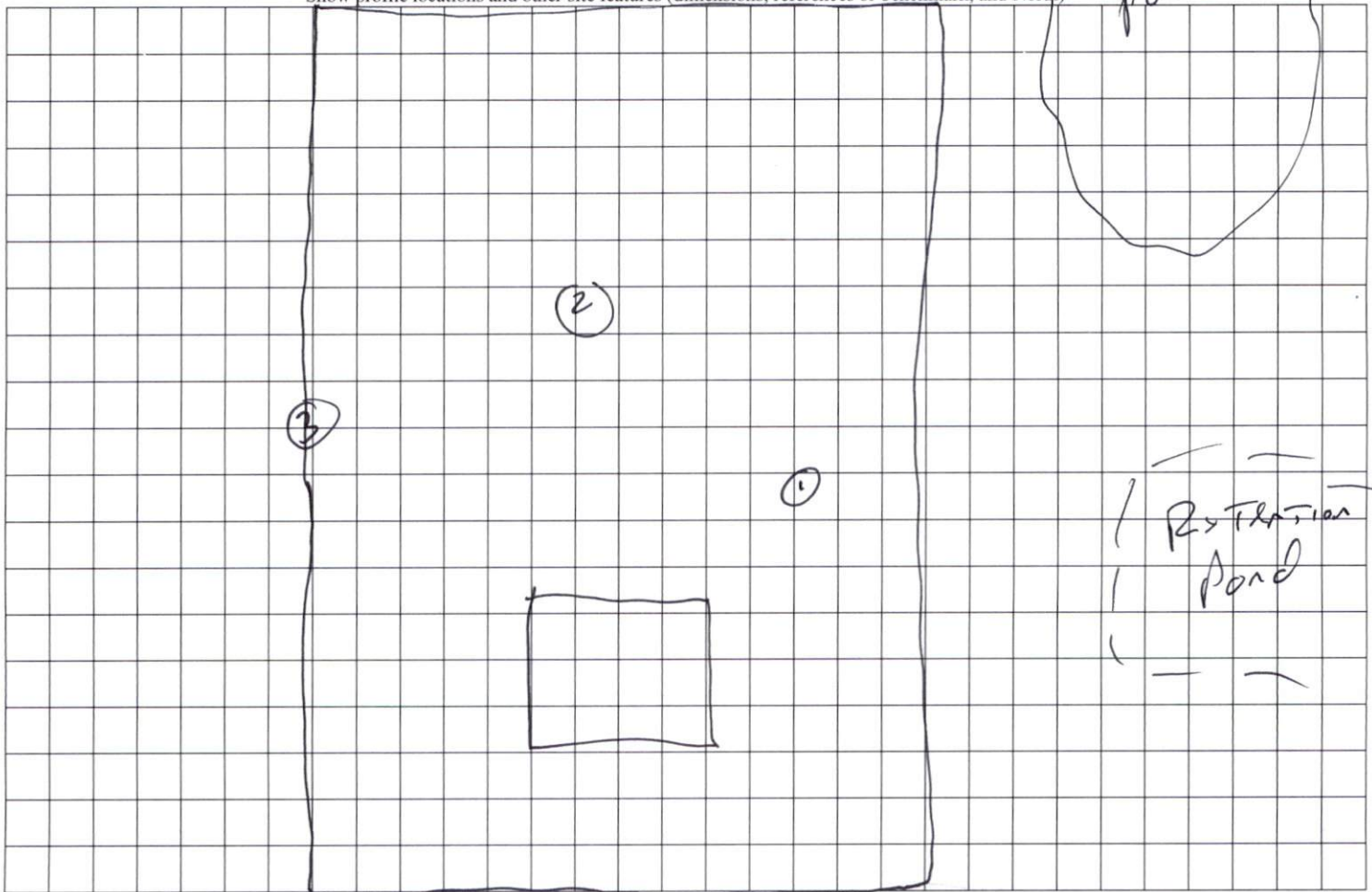

Hillwood