

SOIL/SITE EVALUATION
for ON-SITE WASTEWATER SYSTEM

Owner: *New Home Inc*
 Applicant:
 Address: *92 Bracon Hill*

Date Evaluated: *11-1-23*
 Design Flow (.1949): *360 GPD*

Property Size:

Proposed Facility: *SFD*
 Location of Site:
 Water Supply: Public Individual Well Spring Other
 Evaluation Method: Auger Boring Pit Cut
 Type of Wastewater: Sewage Industrial Process Mixed

P R O F I L E #	.1940 Landscape Position/ Slope %	Horizon Depth (In.)	SOIL MORPHOLOGY .1941		OTHER PROFILE FACTORS				Profile Class & LTAR
			.1941 Structure/ Texture	.1941 Consistence Mineralogy	.1942 Soil Wetness/ Color	.1943 Soil Depth (IN.)	.1956 Sapro Class	.1944 Restr Horiz	
<i>P.T.1</i>	<i>L</i>	<i>0-30</i>	<i>LS</i>	<i>Fi/usp/NXP</i>	<i>10 yr 7/2</i>	<i>>48"</i>	<i>—</i>	<i>—</i>	<i>PS. 4</i>
	<i>2-5%</i>	<i>30-49</i>	<i>scr</i>	<i>Fi/sspl/xp</i>	<i>≥ 38"</i>				
<i>P.T.2</i>	<i>L</i>	<i>0-23</i>	<i>Fill</i>						
	<i>2-5%</i>	<i>23-38</i>	<i>LS</i>	<i>Fi/usp/NXP</i>	<i>>48"</i>	<i>>48"</i>	<i>—</i>	<i>—</i>	<i>PS. 4</i>
		<i>38-48</i>	<i>scr</i>	<i>Fi/sspl/xp</i>		<i>(will need 6" of cover)</i>			

Description	Initial System	Repair System	Other Factors (.1946):
Available Space (.1945)	<i>✓</i>	<i>✓</i>	Site Classification (.1948): <i>PS</i>
System Type(s)	<i>✓</i>	<i>✓</i>	Evaluated By: <i>MD RETH</i>
Site LTAR	<i>.4</i>	<i>.4</i>	Others Present:

COMMENTS: _____

LANDSCAPE POSITIONS	GROUP	TEXTURES	.1955 LTAR	CONSISTENCE MOIST	WET
R-RIDGE	I	S-SAND	1.2 - 0.8	VFR-VERY FRIABLE FR-FRIABLE	NS-NON-STICKY SS-SLIGHTLY STICKY
S-SHOULDER SLOPE		LS-LOAMY SAND			
L-LINEAR SLOPE	II	SL-SANDY LOAM	0.8 - 0.6	FI-FIRM VFI-VERY FIRM	S-STICKY VS-VERY STICKY
FS-FOOT SLOPE		L-LOAM			
N-NOSE SLOPE	III	SI-SILT	0.6 - 0.3	EFI-EXTREMELY FIRM	NP-NON-PLASTIC SP-SLIGHTLY STICKY P-PLASTIC VP-VERY PLASTIC
H-HEAD SLOPE		SIL-SILT LOAM			
CC-CONCLAVE SLOPE		CL-CLAY LOAM			
CV-CONVEX SLOPE		SCL-SANDY CLAY LOAM			
T-TERRACE	IV	SIC-SILTY CLAY	0.4 - 0.1	C-CLAY SC-SANDY CLAY	
FP-FLOOD PLAN					

STRUCTURE
 SG-SINGLE GRAIN
 M-MASSIVE
 CR-CRUMB
 GR-GRANULAR
 SBK-SUBANGULAR BLOCKY
 ABK-ANGULAR BLOCKY
 PL-PLATY
 PR-PRISMATIC

MINERALOGY
 SLIGHTLY EXPANSIVE
 EXPANSIVE

Show profile locations and other site features (dimensions, references or benchmark, and North)

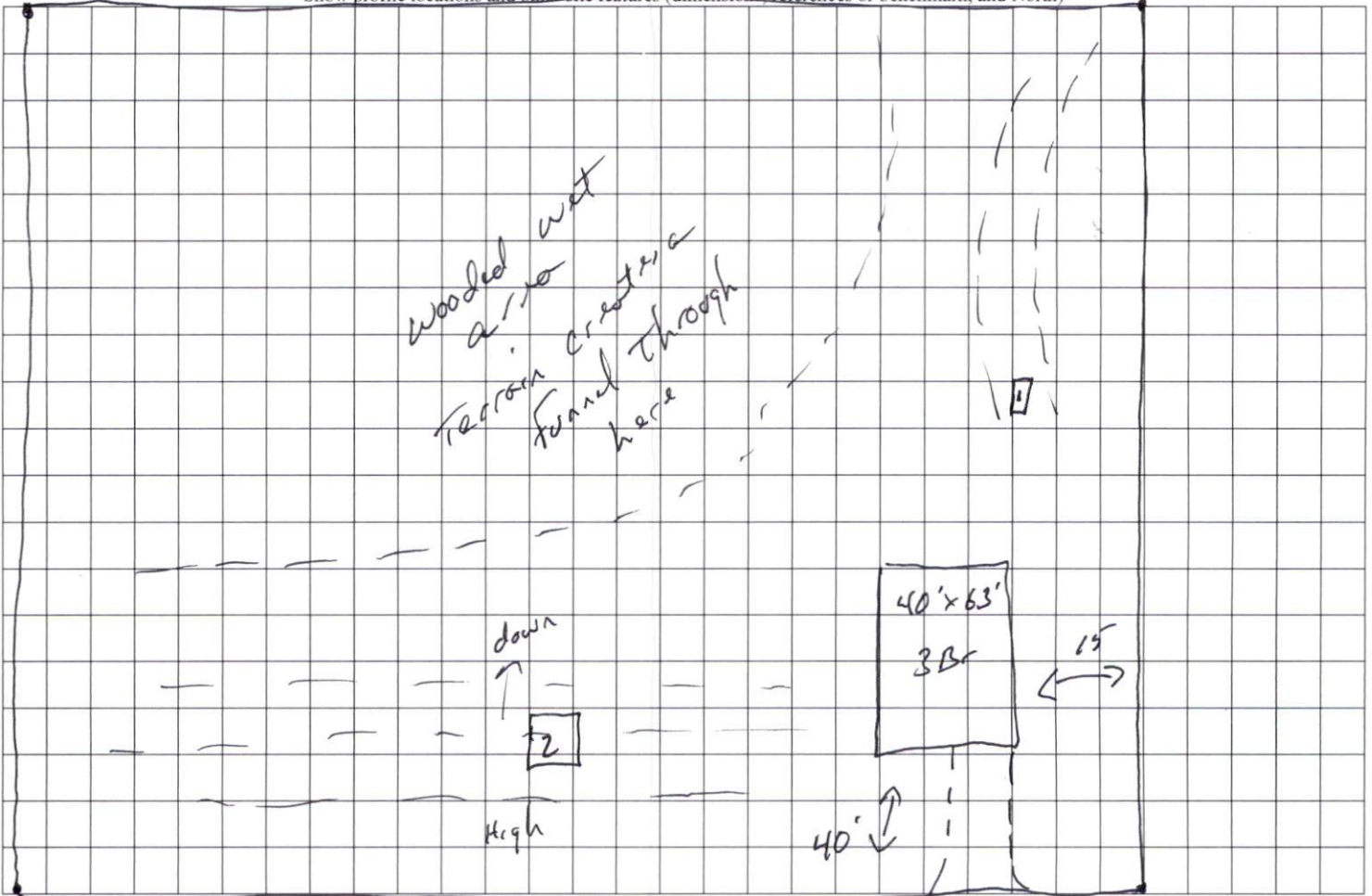

Beacon Hill