

**FB1-1 2.0E 2900Fb PWT LVL 1.750" X 24.000" 2-Ply - PASSED**

Level: Level  
Ticket: INC0020127

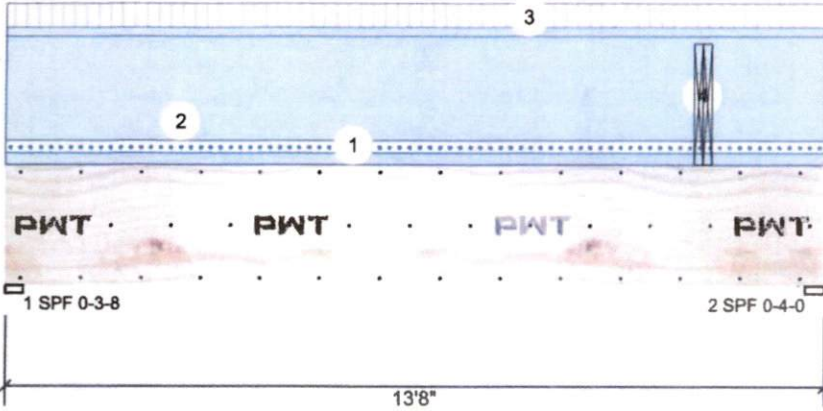

**Member Information**

Type: Girder  
Plies: 2  
Moisture Condition: Dry  
Deflection LL: 480  
Deflection TL: 240  
Importance: Normal - II  
Temperature: Temp <= 100°F

Application: Floor  
Design Method: ASD  
Building Code: IBC/IRC 2015  
Load Sharing: No  
Deck: Not Checked

**Reactions PATTERNED lb (Uplift)**

Brg	Direction	Live	Dead	Snow	Wind	Const
1	Vertical	395	2115	555	0	0
2	Vertical	1056	3468	1349	0	0

**Bearings**

Bearing	Length	Dir.	Cap.	React D/L lb	Total	Ld. Case	Ld. Comb.
1 - SPF	3.500"	Vert	54%	2115 / 712	2827	L	D+0.75(L+S)
2 - SPF	4.000"	Vert	89%	3468 / 1804	5272	L	D+0.75(L+S)

**Analysis Results**

Analysis	Actual	Location	Allowed	Capacity	Comb.	Case
Moment	9488 ft-lb	7'11 7/8"	70689 ft-lb	13%	D+L	L
Shear	3972 lb	11'4"	18354 lb	22%	D+0.75(L+S)	L
LL Defl inch	0.017 (L/9512)	7'6 13/16"	0.330 (L/480)	5%	0.75(L+S)	L
TL Defl inch	0.058 (L/2743)	7'3 5/16"	0.659 (L/240)	9%	D+0.75(L+S)	L

The signature has been electronically transmitted

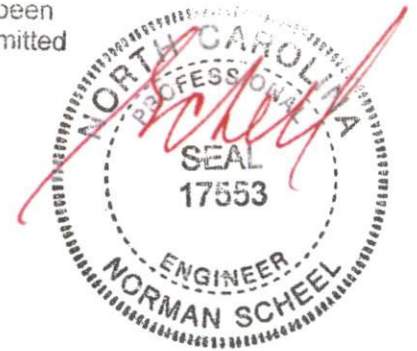

**Design Notes**

- 1 Provide support to prevent lateral movement and rotation at the end bearings.
- 2 Dead Load Deflection: Instant = 0.041", Long Term = 0.062".
- 3 Fasten all plies using 3 rows of 12d Box nails (.128x3.25") at 12" o.c. Maximum end distance not to exceed 6". Clinch Nails where possible.
- 4 Refer to last page of calculations for fasteners required for specified loads.
- 5 Girders are designed to be supported on the bottom edge only.
- 6 Top loads must be supported equally by all plies.
- 7 Top must be laterally braced at end bearings.
- 8 Bottom must be laterally braced at end bearings.

ID	Load Type	Location	Trib Width	Side	Dead 0.9	Live 1	Snow 1.15	Wind 1.6	Const. 1.25	Comments
1	Uniform		3-0-0	Top	20 PSF	0 PSF	20 PSF	0 PSF	0 PSF	rt
2	Uniform			Top	175 PLF	0 PLF	0 PLF	0 PLF	0 PLF	gable
3	Uniform		1-0-0	Top	15 PSF	40 PSF	0 PSF	0 PSF	0 PSF	ft
4	Point	11-7-8		Top	1838 lb	904 lb	1084 lb	0 lb	0 lb	FB2-1 Brg 2
	Bearing Length	0-3-8								
	Self Weight				24 PLF					

**Notes**

This component analysis is based on the loads, geometry and other conditions as entered by the user and listed in this report. The user is responsible to ensure the accuracy of the input and the applicability to the actual conditions of the structure for which this component is intended. This analysis is valid only for the product listed.

Copyright 2023 All rights reserved by Pacific Woodtech Corp 1850 Park Lane, Burlington, WA 98233

**Manufacturer Info**

Pacific Woodtech Corp  
1850 Park Lane  
Burlington, WA 98233  
(800) 515-7570  
www.pwtewp.com  
ICC-ES: ESR-2909 ESR-2403 APA:  
PR-L233 PR-L280

U.S. Lumber  
2160 Satellite Blvd., Suite 450, GA  
U.S.A  
30097  
888-613-5078



This design is valid until 11/16/2026

**FB1-1 2.0E 2900Fb PWT LVL 1.750" X 24.000" 2-Ply - PASSED**

Level: Level  
Ticket: INC0020127

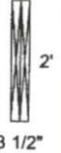
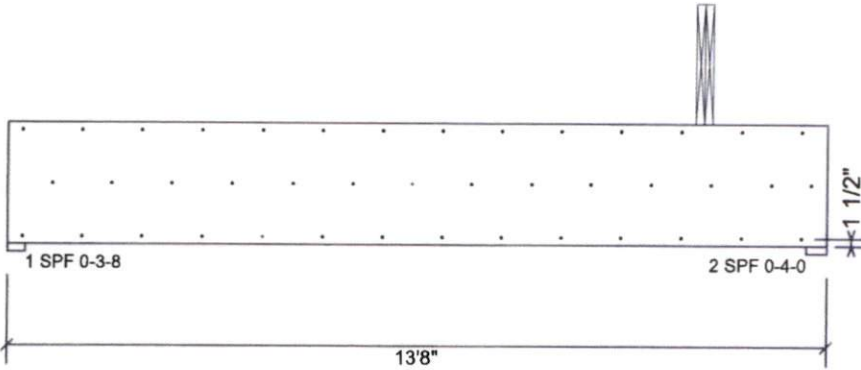

**Multi-Ply Analysis**

Fasten all plies using 3 rows of 12d Box nails (.128x3.25") at 12" o.c.. Maximum end distance not to exceed 6". Clinch Nails where possible.

Capacity	0.0 %
Load	0.0 PLF
Yield Limit per Foot	278.2 PLF
Yield Limit per Fastener	92.7 lb.
CM	1
Yield Mode	IV
Edge Distance	1 1/2"
Min. End Distance	3"
Load Combination	
Duration Factor	1.00

**Notes**

This component analysis is based on the loads, geometry and other conditions as entered by the user and listed in this report. The user is responsible to ensure the accuracy of the input and the applicability to the actual conditions of the structure for which this component is intended. This analysis is valid only for the product listed.

Copyright 2023 All rights reserved by Pacific Woodtech Corp 1850 Park Lane, Burlington, WA 98233

**Manufacturer Info**

Pacific Woodtech Corp  
1850 Park Lane  
Burlington, WA 98233  
(800) 515-7570  
www.pwtewp.com  
ICC-ES: ESR-2909 ESR-2403 APA:  
PR-L233 PR-L280

U.S. Lumber  
2160 Satellite Blvd., Suite 450, GA  
U.S.A  
30097  
888-613-5078



**U.S. LUMBER**

This design is valid until 11/16/2026

**FB2-1 2.0E 2900Fb PWT LVL 1.750" X 24.000" 2-Ply - PASSED**

Level: Level  
Ticket: INC0020127

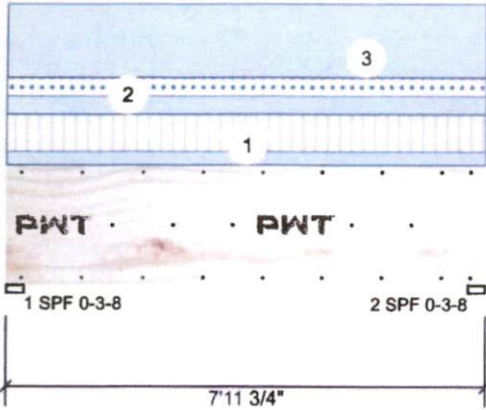

**Member Information**

Type: Girder  
Plies: 2  
Moisture Condition: Dry  
Deflection LL: 480  
Deflection TL: 240  
Importance: Normal - II  
Temperature: Temp <= 100°F

Application: Floor  
Design Method: ASD  
Building Code: IBC/IRC 2015  
Load Sharing: No  
Deck: Not Checked

**Reactions PATTERNED lb (Uplift)**

Brg	Direction	Live	Dead	Snow	Wind	Const
1	Vertical	904	1838	1084	0	0
2	Vertical	904	1838	1084	0	0

**Bearings**

Bearing	Length	Dir.	Cap.	React D/L lb	Total	Ld. Case	Ld. Comb.
1 - SPF	3.500"	Vert	64%	1838 / 1491	3329	L	D+0.75(L+S)
2 - SPF	3.500"	Vert	64%	1838 / 1491	3329	L	D+0.75(L+S)

**Analysis Results**

Analysis	Actual	Location	Allowed	Capacity	Comb.	Case
Moment	5933 ft-lb	3'11 7/8"	81292 ft-lb	7%	D+0.75(L+S)	L
Shear	1417 lb	5'8 1/4"	18354 lb	8%	D+0.75(L+S)	L
LL Defl inch (L/12896)	0.007	3'11 15/16"	0.189 (L/480)	4%	0.75(L+S)	L
TL Defl inch	0.016 (L/5776)	3'11 15/16"	0.377 (L/240)	4%	D+0.75(L+S)	L

The signature has been electronically transmitted



**Design Notes**

- 1 Provide support to prevent lateral movement and rotation at the end bearings.
- 2 Dead Load Deflection: Instant = 0.009", Long Term = 0.013".
- 3 Fasten all plies using 3 rows of 12d Box nails (.128x3.25") at 12" o.c. Maximum end distance not to exceed 6". Clinch Nails where possible.
- 4 Refer to last page of calculations for fasteners required for specified loads.
- 5 Girders are designed to be supported on the bottom edge only.
- 6 Top loads must be supported equally by all plies.
- 7 Top must be laterally braced at end bearings.
- 8 Bottom must be laterally braced at end bearings.

ID	Load Type	Location	Trib Width	Side	Dead 0.9	Live 1	Snow 1.15	Wind 1.6	Const. 1.25	Comments
1	Uniform		5-8-0	Top	15 PSF	40 PSF	0 PSF	0 PSF	0 PSF	ft
2	Uniform		13-7-0	Top	20 PSF	0 PSF	20 PSF	0 PSF	0 PSF	rt
3	Uniform			Top	80 PLF	0 PLF	0 PLF	0 PLF	0 PLF	wall
	Self Weight				24 PLF					

**Notes**  
This component analysis is based on the loads, geometry and other conditions as entered by the user and listed in this report. The user is responsible to ensure the accuracy of the input and the applicability to the actual conditions of the structure for which this component is intended. This analysis is valid only for the product listed.  
Copyright 2023 All rights reserved by Pacific Woodtech Corp 1850 Park Lane, Burlington, WA 98233

**Manufacturer Info**  
Pacific Woodtech Corp  
1850 Park Lane  
Burlington, WA 98233  
(800) 515-7570  
www.pwtwep.com  
ICC-ES: ESR-2909 ESR-2403 APA:  
PR-L233 PR-L280

U.S. Lumber  
2160 Satellite Blvd., Suite 450, GA  
U.S.A  
30097  
888-613-5078



This design is valid until 11/16/2026



**FB2-1 2.0E 2900Fb PWT LVL 1.750" X 24.000" 2-Ply - PASSED**

Level: Level  
Ticket: INC0020127

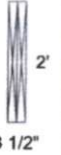
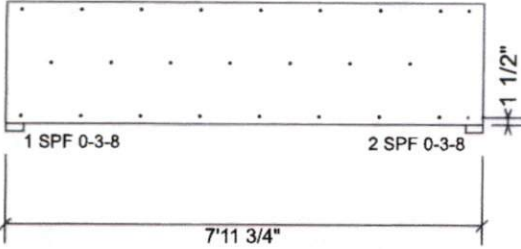

**Multi-Ply Analysis**

Fasten all plies using 3 rows of 12d Box nails (.128x3.25") at 12" o.c.. Maximum end distance not to exceed 6". Clinch Nails where possible.

Capacity	0.0 %
Load	0.0 PLF
Yield Limit per Foot	278.2 PLF
Yield Limit per Fastener	92.7 lb.
C <sub>M</sub>	1
Yield Mode	IV
Edge Distance	1 1/2"
Min. End Distance	3"
Load Combination	
Duration Factor	1.00

**Notes**

This component analysis is based on the loads, geometry and other conditions as entered by the user and listed in this report. The user is responsible to ensure the accuracy of the input and the applicability to the actual conditions of the structure for which this component is intended. This analysis is valid only for the product listed.  
Copyright 2023 All rights reserved by Pacific Woodtech Corp 1850 Park Lane, Burlington, WA 98233

**Manufacturer Info**

Pacific Woodtech Corp  
1850 Park Lane  
Burlington, WA 98233  
(800) 515-7570  
www.pwtwep.com  
ICC-ES: ESR-2909 ESR-2403 APA-  
PR-L233 PR-L280

U.S. Lumber  
2160 Satellite Blvd., Suite 450, GA  
U.S.A  
30097  
888-613-5078



**U.S. LUMBER**

This design is valid until 11/16/2026

**FB3-1 2.0E 2900Fb PWT LVL 1.750" X 24.000" 3-Ply - PASSED**

Level: Level  
Ticket: INC0020127

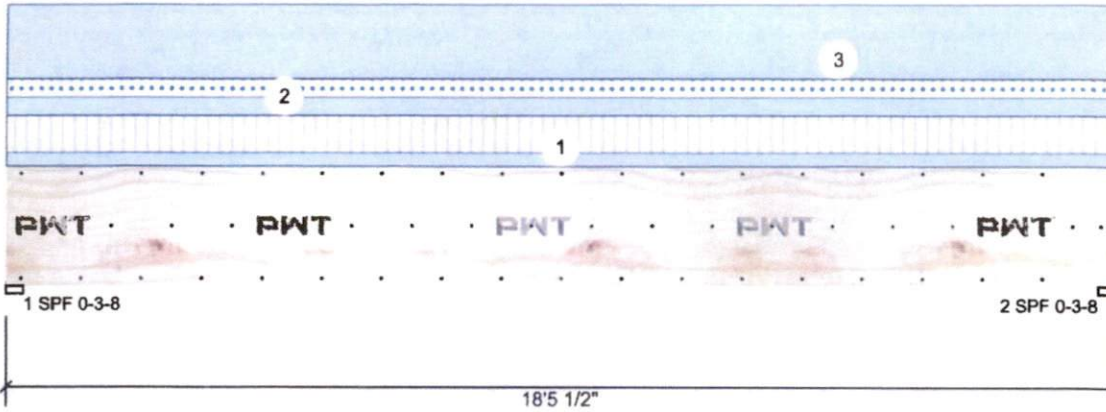

**Member Information**

Type: Girder  
Plies: 3  
Moisture Condition: Dry  
Deflection LL: 480  
Deflection TL: 240  
Importance: Normal - II  
Temperature: Temp <= 100°F

Application: Floor  
Design Method: ASD  
Building Code: IBC/IRC 2015  
Load Sharing: Yes  
Deck: Not Checked

**Reactions PATTERNED lb (Uplift)**

Brg	Direction	Live	Dead	Snow	Wind	Const
1	Vertical	369	4147	2938	0	0
2	Vertical	369	4147	2938	0	0

**Bearings**

Bearing	Length	Dir.	Cap.	React D/L lb	Total	Ld. Case	Ld. Comb.
1 - SPF	3.500"	Vert	91%	4147 / 2938	7085	L	D+S
2 - SPF	3.500"	Vert	91%	4147 / 2938	7085	L	D+S

**Analysis Results**

Analysis	Actual	Location	Allowed	Capacity	Comb.	Case
Moment	31165 ft-lb	9'2 3/4"	126816 ft-lb	25%	D+S	L
Shear	5326 lb	16'2"	27531 lb	19%	D+S	L
LL Defl inch	0.074 (L/2912)	9'2 13/16"	0.451 (L/480)	16%	S	L
TL Defl inch	0.179 (L/1207)	9'2 13/16"	0.901 (L/240)	20%	D+S	L

**Design Notes**

- 1 Provide support to prevent lateral movement and rotation at the end bearings.
- 2 Dead Load Deflection: Instant = 0.105", Long Term = 0.157".
- 3 Fasten all plies using 3 rows of 12d Box nails (.128x3.25") at 12" o.c. Maximum end distance not to exceed 6". Nail from both sides. Clinch Nails where possible.
- 4 Refer to last page of calculations for fasteners required for specified loads.
- 5 Girders are designed to be supported on the bottom edge only.
- 6 Top loads must be supported equally by all plies.
- 7 Top must be laterally braced at a maximum of 10'9 11/16" o.c.
- 8 Bottom must be laterally braced at end bearings.



The signature has been electronically transmitted

ID	Load Type	Location	Trib Width	Side	Dead 0.9	Live 1	Snow 1.15	Wind 1.6	Const. 1.25	Comments
1	Uniform		1-0-0	Top	15 PSF	40 PSF	0 PSF	0 PSF	0 PSF	floor
2	Uniform		15-11-0	Top	20 PSF	0 PSF	20 PSF	0 PSF	0 PSF	rt
3	Uniform			Top	80 PLF	0 PLF	0 PLF	0 PLF	0 PLF	wall
	Self Weight				36 PLF					

**Notes**

This component analysis is based on the loads, geometry and other conditions as entered by the user and listed in this report. The user is responsible to ensure the accuracy of the input and the applicability to the actual conditions of the structure for which this component is intended. This analysis is valid only for the product listed.  
Copyright 2023 All rights reserved by Pacific Woodtech Corp 1850 Park Lane, Burlington, WA 98233

**Manufacturer Info**

Pacific Woodtech Corp  
1850 Park Lane  
Burlington, WA 98233  
(800) 515-7570  
www.pwtewp.com  
ICC-ES: ESR-2909 ESR-2403 APA:  
PR-L233 PR-L280

U.S. Lumber  
2160 Satellite Blvd., Suite 450, GA  
U.S.A  
30097  
888-613-5078



**FB3-1 2.0E 2900Fb PWT LVL 1.750" X 24.000" 3-Ply - PASSED**

Level: Level  
Ticket: INC0020127

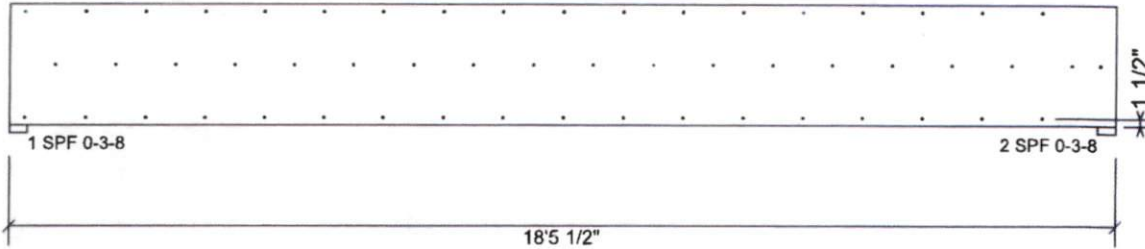

**Multi-Ply Analysis**

Fasten all plies using 3 rows of 12d Box nails (.128x3.25") at 12" o.c.. Nail from both sides. Maximum end distance not to exceed 6". Clinch Nails where possible.

Capacity	0.0 %
Load	0.0 PLF
Yield Limit per Foot	278.2 PLF
Yield Limit per Fastener	92.7 lb.
C <sub>M</sub>	1
Yield Mode	IV
Edge Distance	1 1/2"
Min. End Distance	3"
Load Combination	
Duration Factor	1.00

**Notes**

This component analysis is based on the loads, geometry and other conditions as entered by the user and listed in this report. The user is responsible to ensure the accuracy of the input and the applicability to the actual conditions of the structure for which this component is intended. This analysis is valid only for the product listed.  
Copyright 2023 All rights reserved by Pacific Woodtech Corp 1850 Park Lane, Burlington, WA 98233

**Manufacturer Info**

Pacific Woodtech Corp  
1850 Park Lane  
Burlington, WA 98233  
(800) 515-7570  
www.pwtewp.com  
ICC-ES: ESR-2909 ESR-2403 APA:  
PR-L233 PR-L280

U.S. Lumber  
2160 Satellite Blvd., Suite 450, GA  
U.S.A  
30097  
888-613-5078



**U.S. LUMBER**

This design is valid until 11/16/2026



**FB4-1 2.0E 2900Fb PWT LVL 1.750" X 24.000" 2-Ply - PASSED**

Level: Level  
Ticket: INC0020127

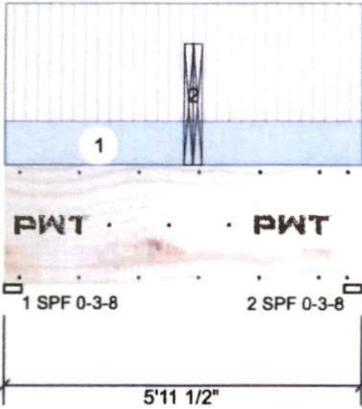

**Member Information**

Type: Girder  
Plies: 2  
Moisture Condition: Dry  
Deflection LL: 480  
Deflection TL: 240  
Importance: Normal - II  
Temperature: Temp <= 100°F

Application: Floor  
Design Method: ASD  
Building Code: IBC/IRC 2015  
Load Sharing: No  
Deck: Not Checked

**Reactions PATTERNED lb (Uplift)**

Brg	Direction	Live	Dead	Snow	Wind	Const
1	Vertical	394	264	0	0	0
2	Vertical	430	284	0	0	0

**Bearings**

Bearing	Length	Dir.	Cap.	React D/L lb	Total	Ld. Case	Ld. Comb.
1 - SPF	3.500"	Vert	13%	264 / 394	659	L	D+L
2 - SPF	3.500"	Vert	14%	284 / 430	713	L	D+L

**Analysis Results**

Analysis	Actual	Location	Allowed	Capacity	Comb.	Case
Moment	1539 ft-lb	3'1 3/4"	70689 ft-lb	2%	D+L	L
Shear	532 lb	3'8"	15960 lb	3%	D+L	L
LL Defl inch	0.002 (L/35775)	3'1 3/4"	0.138 (L/480)	1%	L	L
TL Defl inch	0.003 (L/22189)	3'1 3/4"	0.276 (L/240)	1%	D+L	L

The signature has been electronically transmitted

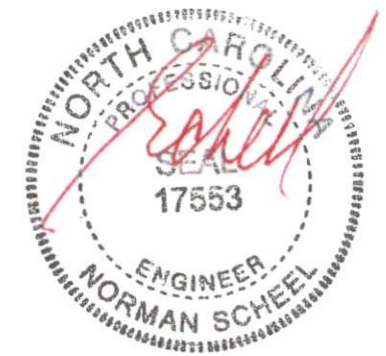

**Design Notes**

- 1 Provide support to prevent lateral movement and rotation at the end bearings.
- 2 Dead Load Deflection: Instant = 0.001", Long Term = 0.002".
- 3 Fasten all plies using 3 rows of 12d Box nails (.128x3.25") at 12" o.c. Maximum end distance not to exceed 6". Clinch Nails where possible.
- 4 Refer to last page of calculations for fasteners required for specified loads.
- 5 Girders are designed to be supported on the bottom edge only.
- 6 Top loads must be supported equally by all plies.
- 7 Top must be laterally braced at end bearings.
- 8 Bottom must be laterally braced at end bearings.

ID	Load Type	Location	Trib Width	Side	Dead 0.9	Live 1	Snow 1.15	Wind 1.6	Const. 1.25	Comments
1	Uniform		1-0-0	Top	15 PSF	40 PSF	0 PSF	0 PSF	0 PSF	
2	Point	3-1-12		Top	315 lb	585 lb	0 lb	0 lb	0 lb	FB5-1 Brg 2
	Bearing Length	0-3-8								
	Self Weight				24 PLF					

**Notes**

This component analysis is based on the loads, geometry and other conditions as entered by the user and listed in this report. The user is responsible to ensure the accuracy of the input and the applicability to the actual conditions of the structure for which this component is intended. This analysis is valid only for the product listed.

Copyright 2023 All rights reserved by Pacific Woodtech Corp 1850 Park Lane, Burlington, WA 98233

**Manufacturer Info**

Pacific Woodtech Corp  
1850 Park Lane  
Burlington, WA 98233  
(800) 515-7570  
www.pwtewp.com  
ICC-ES: ESR-2909 ESR-2403 APA:  
PR-L233 PR-L280

U.S. Lumber  
2160 Satellite Blvd., Suite 450, GA  
U.S.A  
30097  
888-613-5078



This design is valid until 11/16/2026

**FB4-1 2.0E 2900Fb PWT LVL 1.750" X 24.000" 2-Ply - PASSED**

Level: Level  
Ticket: INC0020127

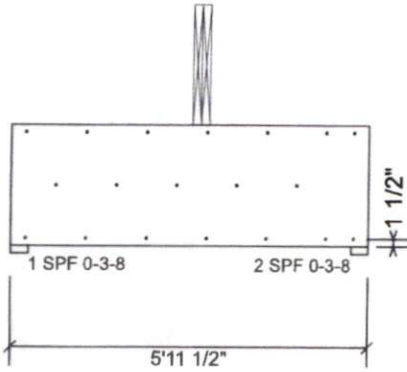

**Multi-Ply Analysis**

Fasten all plies using 3 rows of 12d Box nails (.128x3.25") at 12" o.c.. Maximum end distance not to exceed 6". Clinch Nails where possible.

Capacity	0.0 %
Load	0.0 PLF
Yield Limit per Foot	278.2 PLF
Yield Limit per Fastener	92.7 lb.
CM	1
Yield Mode	IV
Edge Distance	1 1/2"
Min. End Distance	3"
Load Combination	
Duration Factor	1.00

**Notes**

This component analysis is based on the loads, geometry and other conditions as entered by the user and listed in this report. The user is responsible to ensure the accuracy of the input and the applicability to the actual conditions of the structure for which this component is intended. This analysis is valid only for the product listed.  
Copyright 2023 All rights reserved by Pacific Woodtech Corp 1850 Park Lane, Burlington, WA 98233

**Manufacturer Info**

Pacific Woodtech Corp  
1850 Park Lane  
Burlington, WA 98233  
(800) 515-7570  
www.pwtewp.com  
ICC-ES: ESR-2909 ESR-2403 APA:  
PR-L233 PR-L280

U.S. Lumber  
2160 Satellite Blvd., Suite 450, GA  
U.S.A  
30097  
888-613-5078



**U.S. LUMBER**

This design is valid until 11/16/2026



**FB5-1 2.0E 2900Fb PWT LVL 1.750" X 24.000" 2-Ply - PASSED**

Level: Level  
Ticket: INC0020127

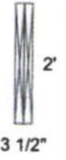
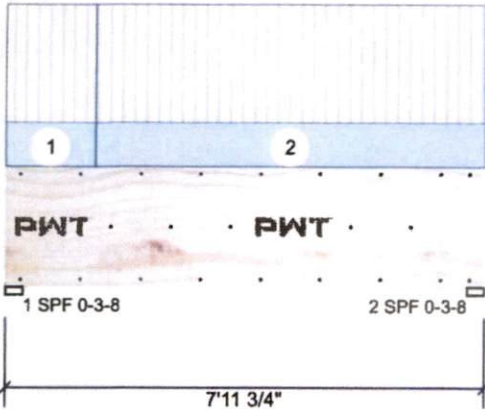

**Member Information**

Type: Girder  
Plies: 2  
Moisture Condition: Dry  
Deflection LL: 480  
Deflection TL: 240  
Importance: Normal - II  
Temperature: Temp <= 100°F

Application: Floor  
Design Method: ASD  
Building Code: IBC/IRC 2015  
Load Sharing: No  
Deck: Not Checked

**Reactions PATTERNED lb (Uplift)**

Brg	Direction	Live	Dead	Snow	Wind	Const
1	Vertical	902	434	0	0	0
2	Vertical	585	315	0	0	0

**Bearings**

Bearing	Length	Dir.	Cap. React	D/L lb	Total	Ld. Case	Ld. Comb.
1 - SPF	3.500"	Vert	26%	434 / 902	1336	L	D+L
2 - SPF	3.500"	Vert	17%	315 / 585	901	L	D+L

**Analysis Results**

Analysis	Actual	Location	Allowed	Capacity	Comb.	Case
Moment	1682 ft-lb	3'9 13/16"	70689 ft-lb	2%	D+L	L
Shear	405 lb	5'8 1/4"	15960 lb	3%	D+L	L
LL Defl inch	0.003 (L/30975)	3'10 1/2"	0.189 (L/480)	2%	L	L
TL Defl inch	0.004 (L/20254)	3'10 5/8"	0.377 (L/240)	1%	D+L	L

The signature has been electronically transmitted



**Design Notes**

- 1 Provide support to prevent lateral movement and rotation at the end bearings.
- 2 Dead Load Deflection: Instant = 0.002", Long Term = 0.002".
- 3 Fasten all plies using 3 rows of 12d Box nails (.128x3.25") at 12" o.c. Maximum end distance not to exceed 6". Clinch Nails where possible.
- 4 Refer to last page of calculations for fasteners required for specified loads.
- 5 Girders are designed to be supported on the bottom edge only.
- 6 Top loads must be supported equally by all plies.
- 7 Top must be laterally braced at end bearings.
- 8 Bottom must be laterally braced at end bearings.

ID	Load Type	Location	Trib Width	Side	Dead 0.9	Live 1	Snow 1.15	Wind 1.6	Const. 1.25	Comments
1	Part. Uniform	0-0-0 to 1-6-0	9-8-0	Top	15 PSF	40 PSF	0 PSF	0 PSF	0 PSF	ft
2	Part. Uniform	1-6-0 to 7-11-12	3-6-0	Top	15 PSF	40 PSF	0 PSF	0 PSF	0 PSF	ft
	Self Weight				24 PLF					

**Notes**  
This component analysis is based on the loads, geometry and other conditions as entered by the user and listed in this report. The user is responsible to ensure the accuracy of the input and the applicability to the actual conditions of the structure for which this component is intended. This analysis is valid only for the product listed.  
Copyright 2023 All rights reserved by Pacific Woodtech Corp 1850 Park Lane, Burlington, WA 98233

**Manufacturer Info**  
Pacific Woodtech Corp  
1850 Park Lane  
Burlington, WA 98233  
(800) 515-7570  
www.pwtwp.com  
ICC-ES: ESR-2909 ESR-2403 APA:  
PR-L233 PR-L280

U.S. Lumber  
2160 Satellite Blvd., Suite 450, GA  
U.S.A  
30097  
888-613-5078



This design is valid until 11/16/2026

**FB5-1 2.0E 2900Fb PWT LVL 1.750" X 24.000" 2-Ply - PASSED**

Level: Level  
Ticket: INC0020127

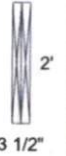
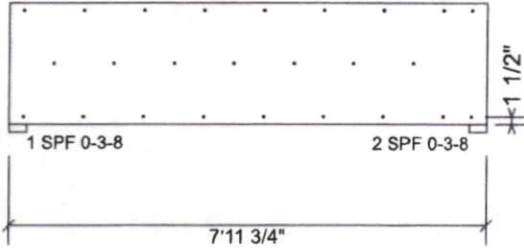

**Multi-Ply Analysis**

Fasten all plies using 3 rows of 12d Box nails (.128x3.25") at 12" o.c.. Maximum end distance not to exceed 6". Clinch Nails where possible.

Capacity	0.0 %
Load	0.0 PLF
Yield Limit per Foot	278.2 PLF
Yield Limit per Fastener	92.7 lb.
CM	1
Yield Mode	IV
Edge Distance	1 1/2"
Min. End Distance	3"
Load Combination	
Duration Factor	1.00

**Notes**

This component analysis is based on the loads, geometry and other conditions as entered by the user and listed in this report. The user is responsible to ensure the accuracy of the input and the applicability to the actual conditions of the structure for which this component is intended. This analysis is valid only for the product listed.  
Copyright 2023 All rights reserved by Pacific Woodtech Corp 1850 Park Lane, Burlington, WA 98233

**Manufacturer Info**

Pacific Woodtech Corp  
1850 Park Lane  
Burlington, WA 98233  
(800) 515-7570  
www.pwtewp.com  
ICC-ES: ESR-2909 ESR-2403 APA:  
PR-L233 PR-L280

U.S. Lumber  
2160 Satellite Blvd., Suite 450, GA  
U.S.A  
30097  
888-613-5078



**U.S. LUMBER**

This design is valid until 11/16/2026

**FB6-1 2.0E 2900Fb PWT LVL 1.750" X 24.000" 4-Ply - PASSED**

Level: Level  
Ticket: INCO020127

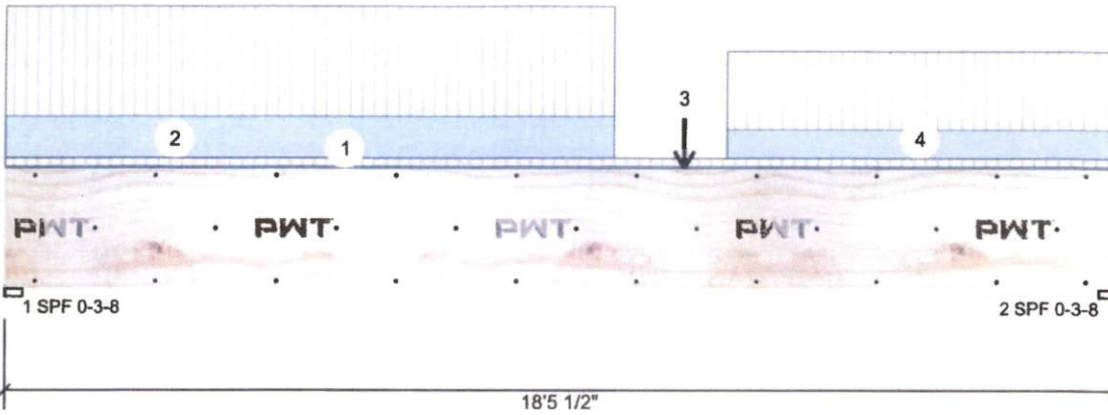

**Member Information**

Type: Girder  
Plies: 4  
Moisture Condition: Dry  
Deflection LL: 480  
Deflection TL: 240  
Importance: Normal - II  
Temperature: Temp <= 100°F

Application: Floor  
Design Method: ASD  
Building Code: IBC/IRC 2015  
Load Sharing: Yes  
Deck: Not Checked

**Reactions PATTERNED lb (Uplift)**

Brg	Direction	Live	Dead	Snow	Wind	Const
1	Vertical	5502	2488	0	0	0
2	Vertical	4984	2272	0	0	0

**Bearings**

Bearing	Length	Dir.	Cap.	React D/L lb	Total	Ld. Case	Ld. Comb.
1 - SPF	3.500"	Vert	77%	2488 / 5502	7990	L	D+L
2 - SPF	3.500"	Vert	70%	2272 / 4984	7256	L	D+L

**Analysis Results**

Analysis	Actual	Location	Allowed	Capacity	Comb.	Case
Moment	35469 ft-lb	9'3 3/4"	147033 ft-lb	24%	D+L	L
Shear	6023 lb	2'3 1/2"	31920 lb	19%	D+L	L
LL Defl inch	0.105 (L/2063)	9'2 13/16"	0.451 (L/480)	23%	L	L
TL Defl inch	0.152 (L/1422)	9'2 13/16"	0.901 (L/240)	17%	D+L	L

The signature has been electronically transmitted

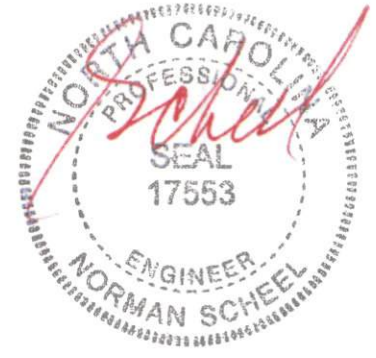

**Design Notes**

- 1 Provide support to prevent lateral movement and rotation at the end bearings.
- 2 Dead Load Deflection: Instant = 0.047", Long Term = 0.071".
- 3 Fasten all plies using 3 rows of SDW22634 at 24" o.c. Maximum end distance not to exceed 12".
- 4 Refer to last page of calculations for fasteners required for specified loads.
- 5 Simpson fasteners applied from a single side of the member use tip values where published.
- 6 Girders are designed to be supported on the bottom edge only.
- 7 Top loads must be supported equally by all plies.
- 8 Top must be laterally braced at a maximum of 12'7 5/8" o.c.
- 9 Bottom must be laterally braced at end bearings.

ID	Load Type	Location	Trib Width	Side	Dead 0.9	Live 1	Snow 1.15	Wind 1.6	Const. 1.25	Comments
1	Uniform		1-0-0	Top	10 PSF	40 PSF	0 PSF	0 PSF	0 PSF	
2	Part. Uniform	0-0-0 to 10-1-8		Top	210 PLF	550 PLF	0 PLF	0 PLF	0 PLF	F9 LL
3	Point	11-3-8		Top	625 lb	1660 lb	0 lb	0 lb	0 lb	F1
	Bearing Length	0-3-8								
4	Part. Uniform	12-0-0 to 18-5-8		Top	145 PLF	390 PLF	0 PLF	0 PLF	0 PLF	
	Self Weight				48 PLF					

**Notes**

This component analysis is based on the loads, geometry and other conditions as entered by the user and listed in this report. The user is responsible to ensure the accuracy of the input and the applicability to the actual conditions of the structure for which this component is intended. This analysis is valid only for the product listed.

Copyright 2023 All rights reserved by Pacific Woodtech Corp 1850 Park Lane, Burlington, WA 98233

**Manufacturer info**

Pacific Woodtech Corp  
1850 Park Lane  
Burlington, WA 98233  
(800) 515-7570  
www.pwtewp.com  
ICC-ES: ESR-2909 ESR-2403 APA:  
PR-L233 PR-L280

U.S. Lumber  
2160 Satellite Blvd., Suite 450, GA  
U.S.A.  
30097  
888-613-5078



**U.S. LUMBER**

This design is valid until 11/16/2026



**FB6-1 2.0E 2900Fb PWT LVL 1.750" X 24.000" 4-Ply - PASSED**

Level: Level  
Ticket: INC0020127

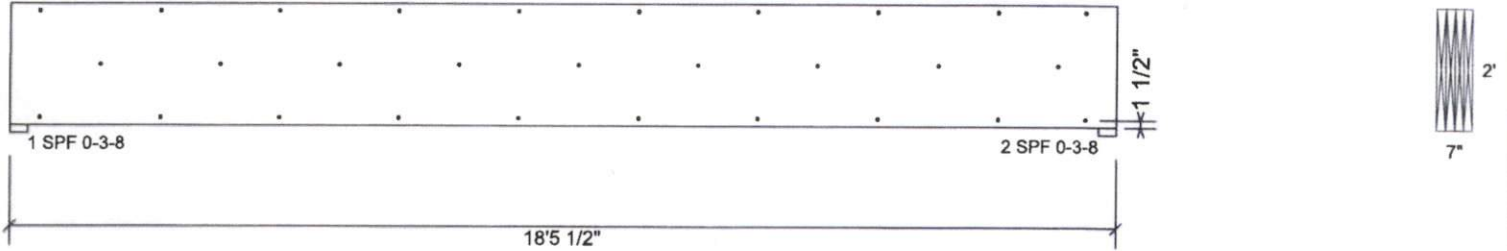

**Multi-Ply Analysis**

Fasten all plies using 3 rows of SDW22634 at 24" o.c.. Maximum end distance not to exceed 12".

Capacity	0.0 %
Load	0.0 PLF
Yield Limit per Foot	450.0 PLF
Yield Limit per Fastener	300.0 lb.
C <sub>m</sub>	1
Yield Mode	Lookup
Edge Distance	1 1/2"
Min. End Distance	6"
Load Combination	
Duration Factor	1.00

**Notes**

This component analysis is based on the loads, geometry and other conditions as entered by the user and listed in this report. The user is responsible to ensure the accuracy of the input and the applicability to the actual conditions of the structure for which this component is intended. This analysis is valid only for the product listed.  
Copyright 2023 All rights reserved by Pacific Woodtech Corp 1850 Park Lane, Burlington, WA 98233

**Manufacturer Info**

Pacific Woodtech Corp  
1850 Park Lane  
Burlington, WA 98233  
(800) 515-7570  
www.pwtewp.com  
ICC-ES: ESR-2909 ESR-2403 APA:  
PR-L233 PR-L280

U.S. Lumber  
2160 Satellite Blvd., Suite 450, GA  
U.S.A  
30097  
888-613-5078



**U.S. LUMBER**

This design is valid until 11/16/2026