

THIS LAYOUT IS TO BE USED AS A TRUSS PLACEMENT GUIDE ONLY.
PLEASE REFER TO BUILDING PLANS FOR BUILDING CONSTRUCTION AND DETAILS,
SUCH AS PLUMBING OR DUCT DROPS.

PROPOSED DESIGN-
NOT FOR
CONSTRUCTION

Job #
Q-2301964

1254 S
Hamilton Rd
Dunn
UNIT / Lot:

Notes:
1. Exterior dimensions shown are assumed to be:
 Out-to-out of stud
 Out-to-out of sheathing
 Out-to-out of _____
2. Adjust truss locations as needed for plumbing and mechanical clearance. Unless otherwise noted, trusses may be shifted as long as O.C. spacing shown is not exceeded.
3. Do not cut, drill, or otherwise damage any part of any truss without prior approval from Peak Truss.
4. Do not approve drawings if any information herein is unclear. Once ordered trusses will be fabricated as approved.
5. Please contact Peak Truss Builders with any questions. We are available to help any way we can. We can be reached at 919-545-5555 or sales@peaktruss.com

Roof Truss Loading specified by building designer on Residential jobs
Top Chord Live Load 20.0 lb/ft²
Top Chord Dead Load 10.0 lb/ft²
Bottom Chord Live Load 0.0 lb/ft²
Bottom Chord Dead Load 10.0 lb/ft²

Trusses are designed for additional storage load wherever a 42"x24" box will fit between the webs.

Floor Truss Loading specified by building designer on Residential jobs

Top Chord Live Load 40.0 lb/ft²
Top Chord Dead Load 10.0 lb/ft²
Bottom Chord Live Load 0.0 lb/ft²
Bottom Chord Dead Load 5.0 lb/ft²

Floor Live Load deflection limit L/480
Roof Live Load deflection limit L/240

This layout has been designed using the IRC2015 building code.

Model created using a wind speed of 120 mph specified for Harnett County.

Layout Creation Date:

10/2/2023

Sales: Le Greene - Designs: Katie Bailey

PBS - Raleigh
10405 Chapel Hill Rd.
Morrisville, NC
27577

Peak Truss
Builders, LLC

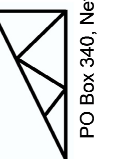

PO Box 340, New Hill, NC 27562

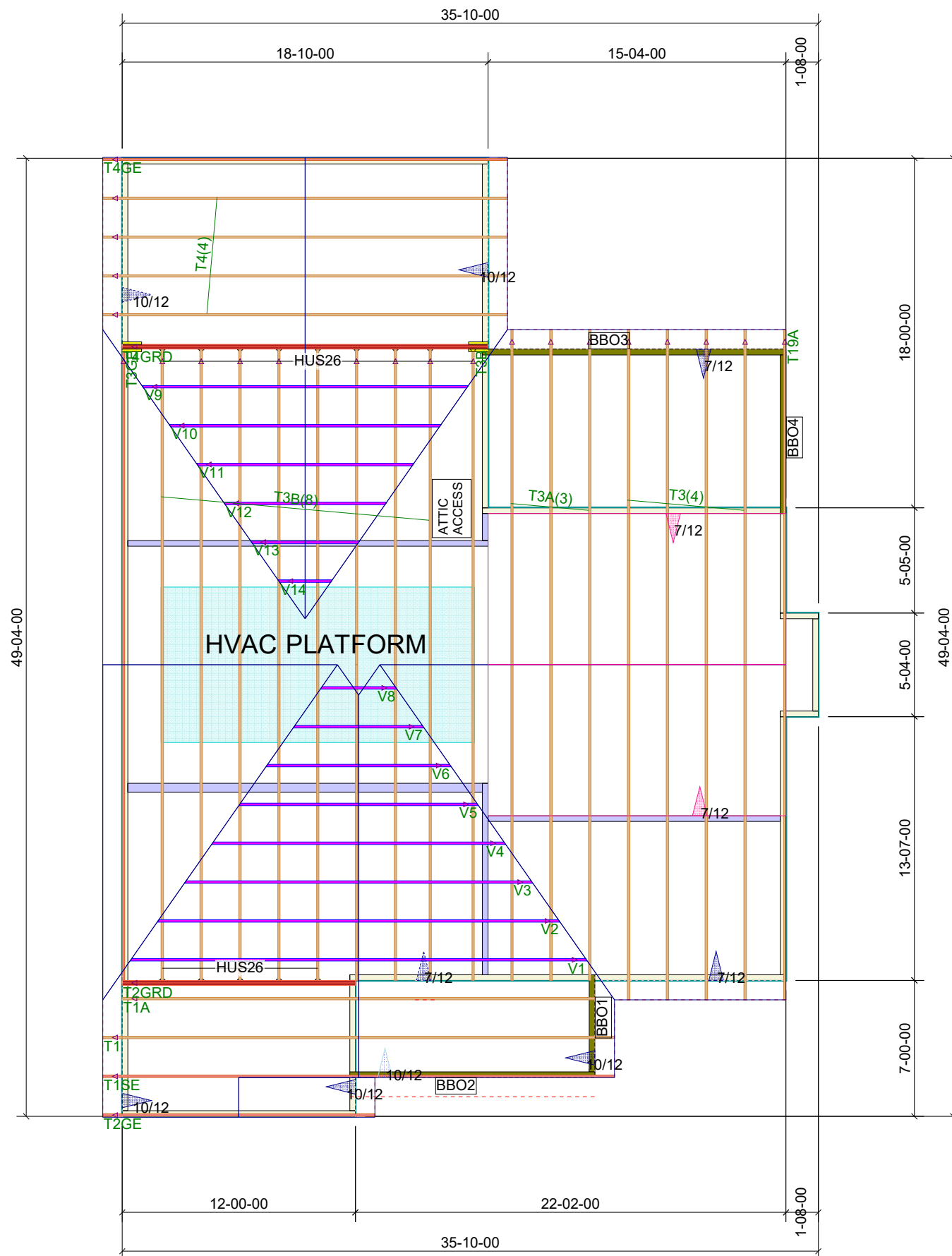

△ - This symbol denotes left end of truss as shown on truss drawings
● - Approximate location of toilet drop. Builder please confirm.

Truss connections by others:
⊕ - Nailed
⊔ - Ledger

Overhang: 12"
Depth: NA
Spacing: 2' OC

Wall Types	
	Load Bearing
	Non Load Bearing

Truss Connector Total List		
Manuf	Product	Qty
MiTek	HUS26	14