

I, MICHAEL P. GRIFFIN, certify that under my direction and supervision this map was drawn from an actual field survey; that the error of closure of the survey as calculated by coordinates is 1: 10,000+; that the area shown hereon was calculated by coordinates.

Witness my hand and seal this 9TH day of FEBRUARY 2024.

*Michael P. Griffin*

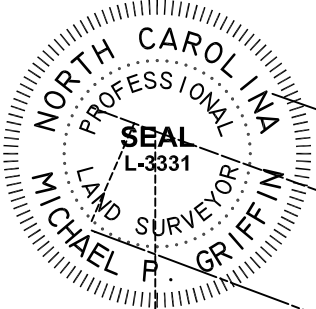

HARNETT CO. REGISTRY  
BM 2023 PGS 14-15, 306-307

SETBACKS

FRONT 35'  
REAR 25'  
SIDE 10'  
CORNER SIDE 20'

TIM CURRIN ROAD  
60' PUBLIC R/W NCSR 1250

THERESA McNEILL  
LASHONE GREEN  
PIN #0528-57-5321.00  
D.B. 2664 PG. 314

30' STREETSCAPE BUFFER

41  
0.756 AC.

42

15' UTILITY EASEMENT

40

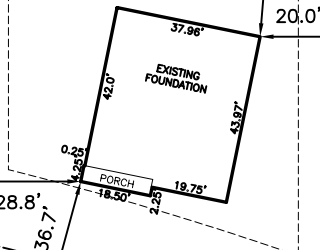

HAWKSMOORE LANE  
50' PUBLIC R/W & UTILITY

C1 R=825.00' L=100.06' S19°14'17"E 100.00'

LEGEND

THIS PROPERTY IS NOT LOCATED  
IN THE 100 YEAR FLOOD ZONE.

- EIP EXISTING IRON PIPE
- IPS IRON PIPE SET
- R/W RIGHT OF WAY
- N/F NOW OR FORMERLY
- EIS EXISTING IRON STAKE
- FES FLARED END SECTION
- WM WATER METER
- CO CLEAN OUT
- FH FIRE HYDRANT
- CB CATCH BASIN

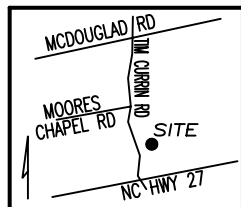

GRIFFIN LAND SURVEYING, INC.

P.O. BOX 148  
FUQUAY-VARINA, NC 27526  
(919) - 567-1963

FOUNDATION SURVEY  
FOR

D.R. HORTON

MCKAY PLACE

LOT 41

HAWKSMOORE LANE

LILLINGTON, N.C.

HARNETT COUNTY UPPER LITTLE RIVER TOWNSHIP

DRAWN BY KDF

DATE 2/9/24

CHECKED BY MPG

SCALE 1" = 50'