



ECS Southeast, LLC

6151 Raeford Road, Suite A
Fayetteville, NC 28304
9104013288
9103230539

LETTER OF TRANSMITTAL

February 08, 2024
W.S. Wellons Realty
PO Box 766
Spring Lake, NC 28390
ATTN: Chandler Jones

RE: **Lot 3 OHC**
ECS Job # **33:6230-N**

Permits:
Location: **330 Caldwell St**
Spring Lake, NC 28390

Field Reports For your use As requested

CC:

ENCL: Field Report # 1 2/5/2024

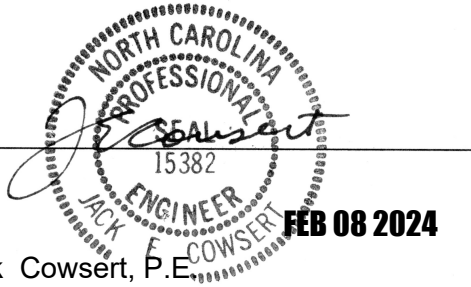
Jack Cowsert, P.E.
Office Manager

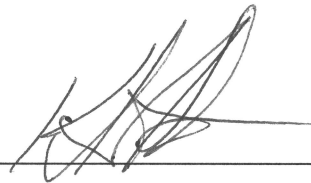
Aaron Kyle Adair
CMT Senior Project Coordinator

Disclaimer

1. This report (and any attachments) shall not be reproduced except in full without prior written approval of ECS.
2. The information in this report relates only to the activities performed on the report date.
3. Where appropriate, this report includes statements as to compliance with applicable project drawings, and specifications for the activities, performed on this report date.
4. Incomplete or non-conforming work will be reported for future resolution.
5. The results of samples and/or specimens obtained or prepared for subsequent laboratory testing will be presented in separate reports/documents.



ECS Southeast, LLC
6151 Raeford Road, Suite A
Fayetteville, NC 28304
(910) 401-3288 [Phone]
(910) 323-0539 [Fax]

FIELD REPORT

Project **Lot 3 OHC**
Location **Spring Lake, NC**
Client **W.S. Wellons Realty**
Contractor **W.S. Wellons Realty**

Project No. **33:6230-N**
Report No. **1**
Day & Date **Monday 2/5/2024**
Weather **50 °/ Sunny**
On-Site Time **1.75**
Lab Time **0.00**
Travel Time* **0.00**
Total **1.75**
Re Obs Time **0.00**

Remarks

Trip Charges*	Tolls/Parking*	Mileage*	Time of Arrival	Departure
Chargeable Items			9:45A	11:30A

* Travel time and mileage will be billed in accordance with the contract.

Summary of Services Performed (field test data, locations, elevations & depths are estimates) & Individuals Contacted.

An ECS representative arrived on site, as requested, to check the bearing capacity of soils via hand auger/DCP method (ASTM STP-399) for house pad continuous foundation footings. Please see the attached sketch and data sheet for details.

A total of 4 hand auger/DCP evaluations were performed to a depth of approximately 3 feet below the current footing sub grade elevation. Test results indicated that the materials in place (at the locations and elevations tested) did appear to be suitable to support the design bearing capacity of 2,000 psf.

ECS will return, as requested, for additional services.

Attachments



IMG_1393[1]

Figure 1

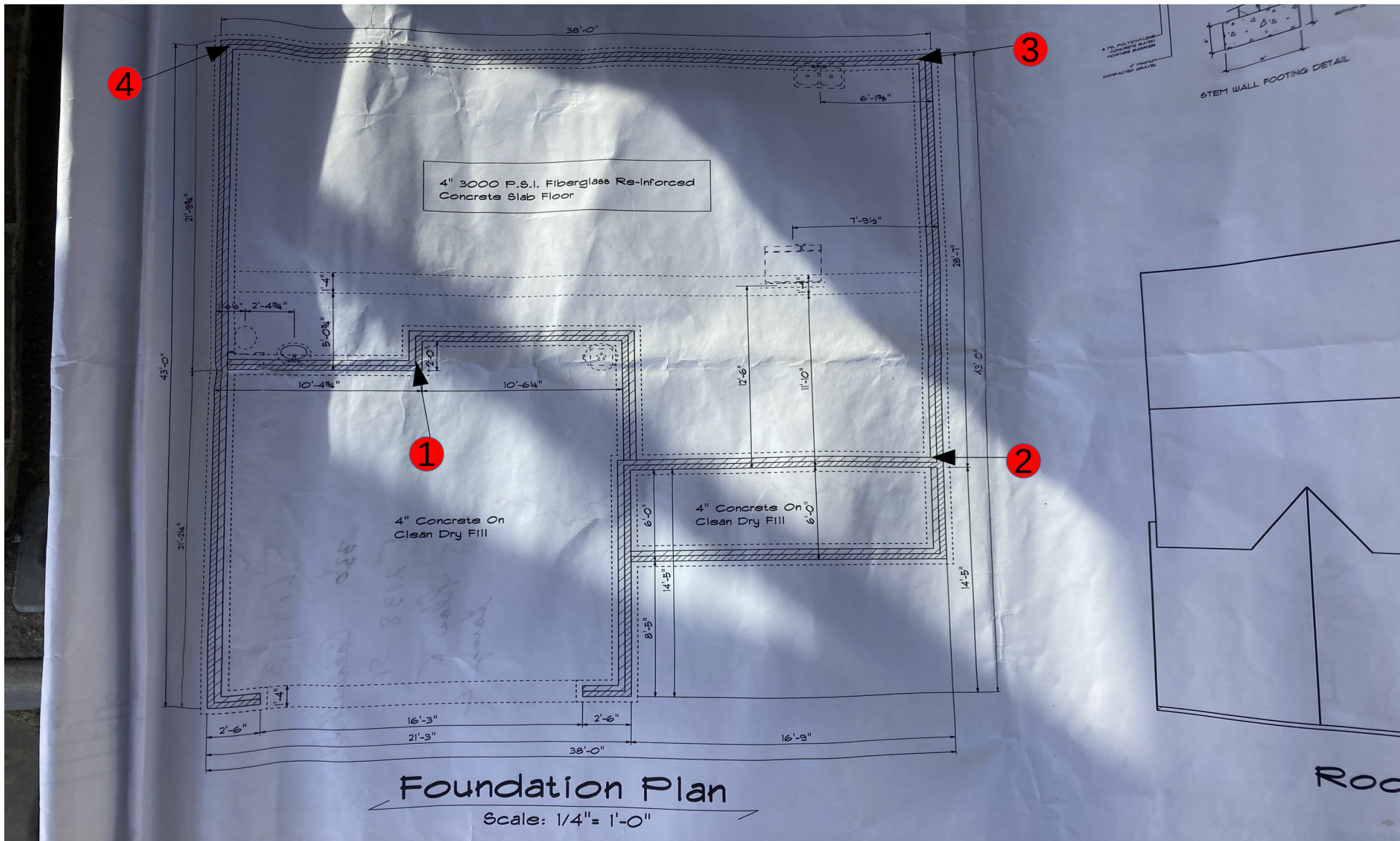

Chris Johnson
 2/5/2024
 Lot 3 OHC
 Proj #: 6230-N
 W/O # 76257

Key (NTS)
 DCP Test Location

#



NORTH



Report of Spread Footing - Foundation Observations

Project: Lot 3 OHC
 Location: 330 Caldwell St
 Spring Lake - Cumberland - NC - 28390
 Contractor: W.S. Wellons Realty

Project No.: 33:6230-N
 Day/Date: 2/5/2024

Footing Number	Location	Size (W x H x L)		Footing Bottom Elevation		Description of Steel Placed	Description of Subgrade Material	Required Blow Counts	Design Bearing Pressure
		Design	Actual	Design **	Depth of Undercut (in)			# of Blows / Increment	
1	Upper Middle Corner of Garage Continuous Footing	x x	x x	N/A			(0)tan/grey sand (-1)tan clayey sand (-2, -3)white clay	6	2000
								(0)6,7,6 (-1)5,6,5 (-2) 4,5,4 (-3)3,2,3	
2	Rear Right Corner of Continuous Footing For Front Stoup	x x	x x	N/A			(0)tan clayey sand (-1)tan sandy clay with trace of white clay (-2) tan/white clay (-3)white clay	6	2000
								(0)6,7,7 (-1)5,5,5 (-2) 3,5,4 (-3)5,4,5	
3	Rear Right Corner of Building Pad For Continuous Footing	x x	x x	N/A	N/A		(0,-1)tan clayey sand (-2) tan/white/grey sandy clay (-3) white clay	6	2000
								(0)7,6,7 (-1)4,6,6 (-2) 4,3,4 (-3)4,4,4	
4	Rear Left Corner of Building Pad For Continuous Footing	x x	x x	N/A			(0)tan clayey sand (-1) tan/white clayey sand(-2)white sandy clay (-3) white clay	6	2000
								(0)8,8,9 (-1)7,5,5 (-2) 5,4,4 (-3)3,4,3	

** SGE: Subgrade Elevation to be determined by surveyor.

By: Christopher H Johnson

ECS Southeast, LLC

WO: 76257