

I, MICHAEL P. GRIFFIN, certify that under my direction and supervision this map was drawn from an actual field survey; that the error of closure of the survey as calculated by coordinates is 1: 10,000+; that the area shown hereon was calculated by coordinates.

Witness my hand and seal this 9TH day of NOVEMBER 2023.

PB 2002 PG 89
HARNETT CO. REGISTRY



VATER A. BUIE
DB 702 PG 30

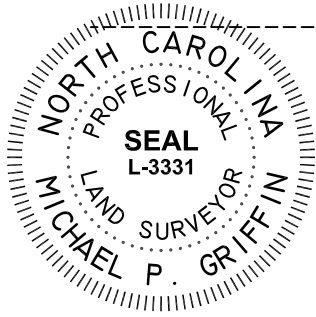

S 07°41'52" W → 100.00'

38

39

0.69 AC.

40

298.05'

226.2'

299.94'

S 82°18'08" E

N 82°18'08" W

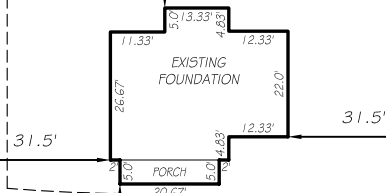

CI N 07°41'52" E ← 61.94'

RAY BYRD ROAD
50' PUBLIC R/W

SETBACKS

FRONT 35'
REAR 25'
SIDE 10'
CORNER SIDE 20'

CI R=383.22' L=38.12' N 10°32'51" E 38.11'

THIS PROPERTY IS NOT LOCATED
IN THE 100 YEAR FLOOD ZONE.

LEGEND

- | | | | |
|-----|---------------------|-----|--------------------|
| EIP | EXISTING IRON PIPE | FES | FLARED END SECTION |
| IPS | IRON PIPE SET | WM | WATER METER |
| R/W | RIGHT OF WAY | CO | CLEAN OUT |
| N/F | NOW OR FORMERLY | FH | FIRE HYDRANT |
| EIS | EXISTING IRON STAKE | CB | CATCH BASIN |

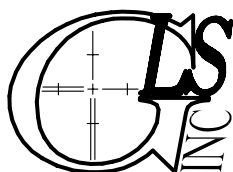
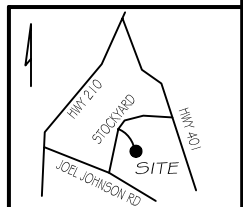

GRIFFIN LAND SURVEYING, INC.

P. O. BOX 148
FUQUAY-VARINA, NC 27526
(919) - 567 - 1963

FOUNDATION SURVEY
FOR

SBM HOMES LLC

STOCKYARD ROAD ESTATES II

LOT 39

325 RAY BYRD ROAD

LILLINGTON, N.C.

HARNETT COUNTY LILLINGTON TOWNSHIP

DRAWN BY KDF

DATE 11/9/23

CHECKED BY MPG

SCALE 1" = 40'