

Signing Here Indicates Approval of All Drawings and Related Specifications  
Owners Understand and Agree that these Plans and Specs are Final and are to be used for the construction of the home. Owners also Agree and understand that there are to be no changes from these plans and specs without the consideration fee paid upfront and any charges for the change if made, will be paid upfront before construction resumes.

APPROVED BY \_\_\_\_\_ DATE \_\_\_\_\_

Builder: \_\_\_\_\_

Designer: \_\_\_\_\_

Owner: \_\_\_\_\_

Owner: \_\_\_\_\_

Superintendent: \_\_\_\_\_

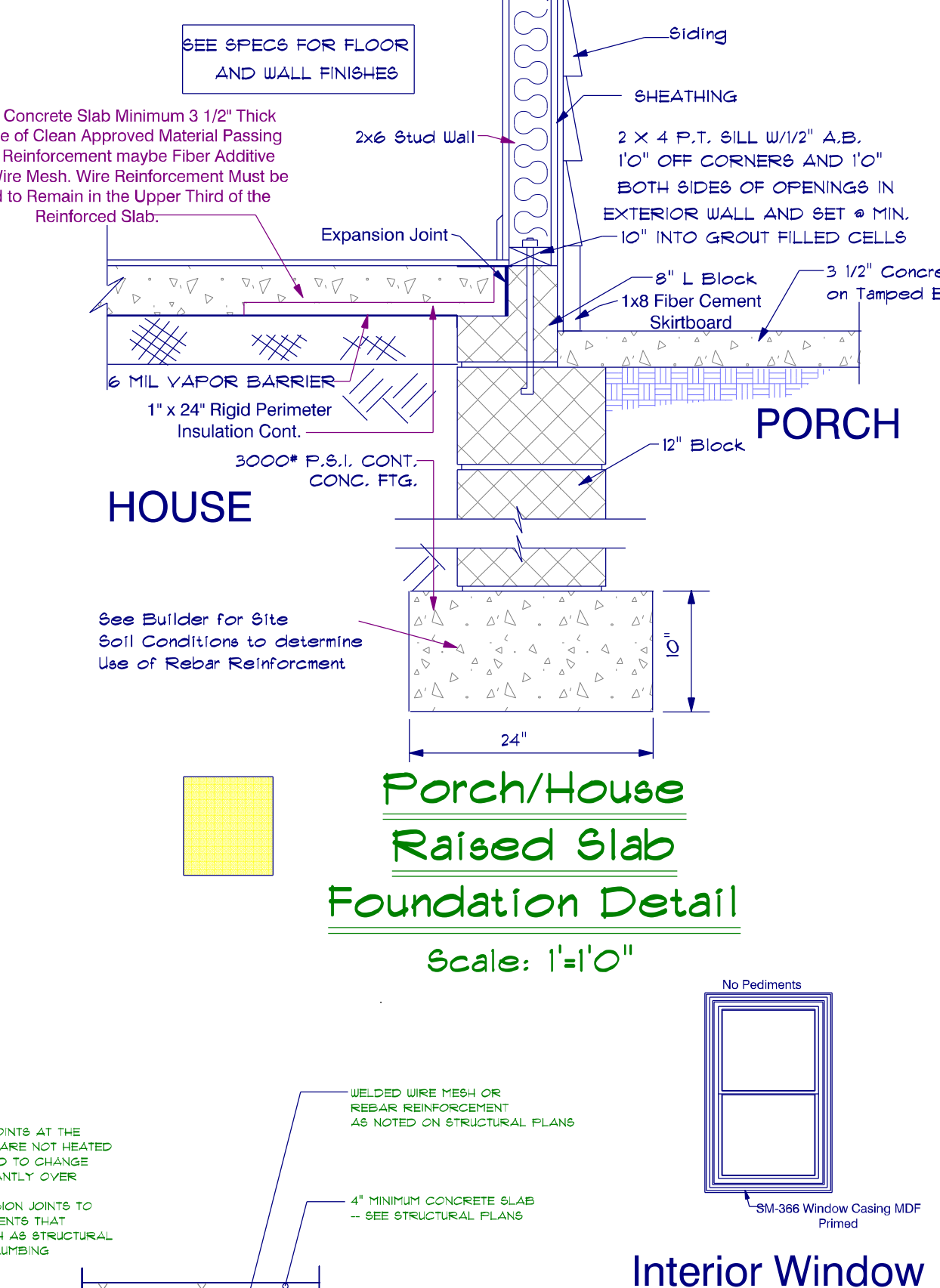
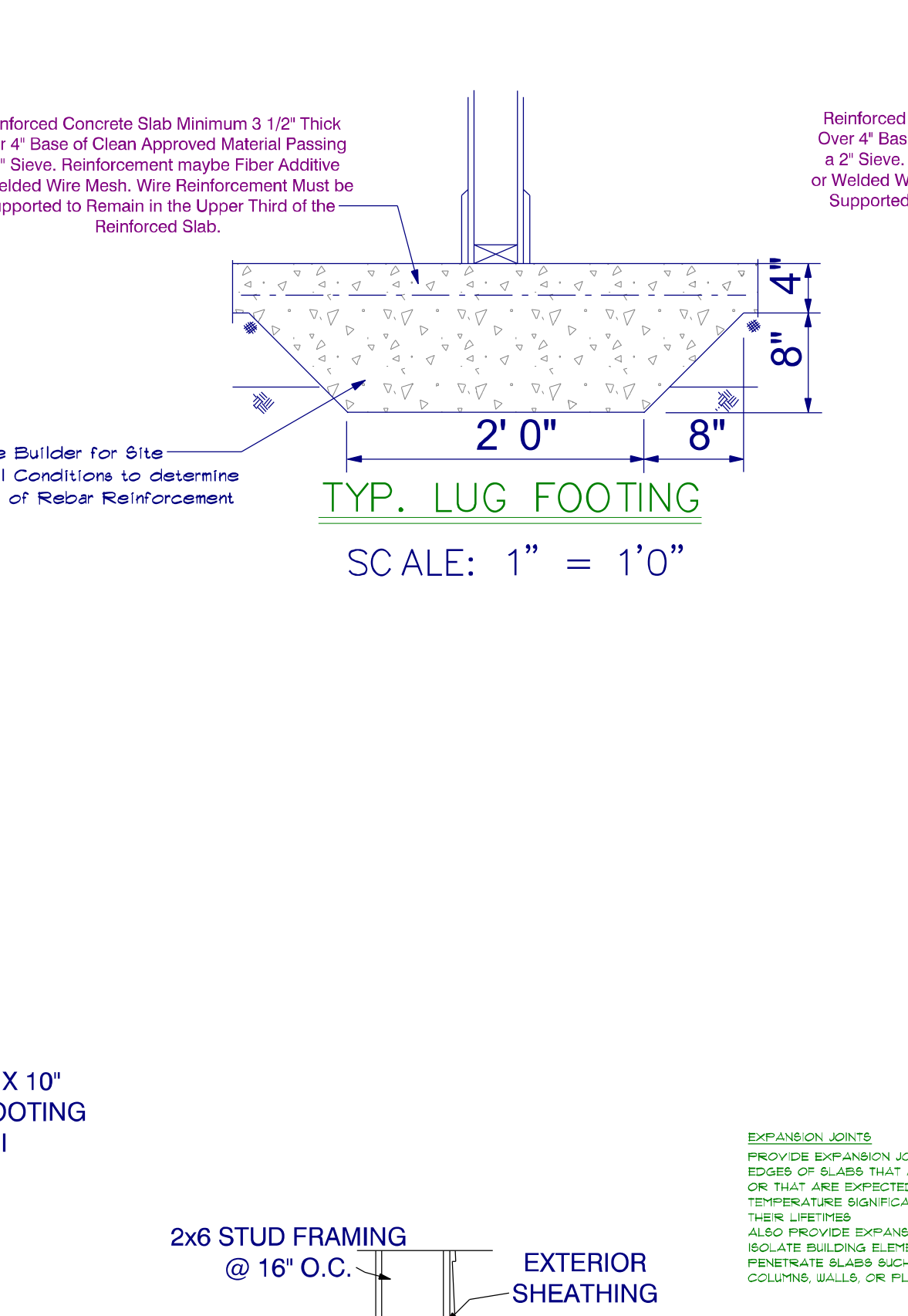
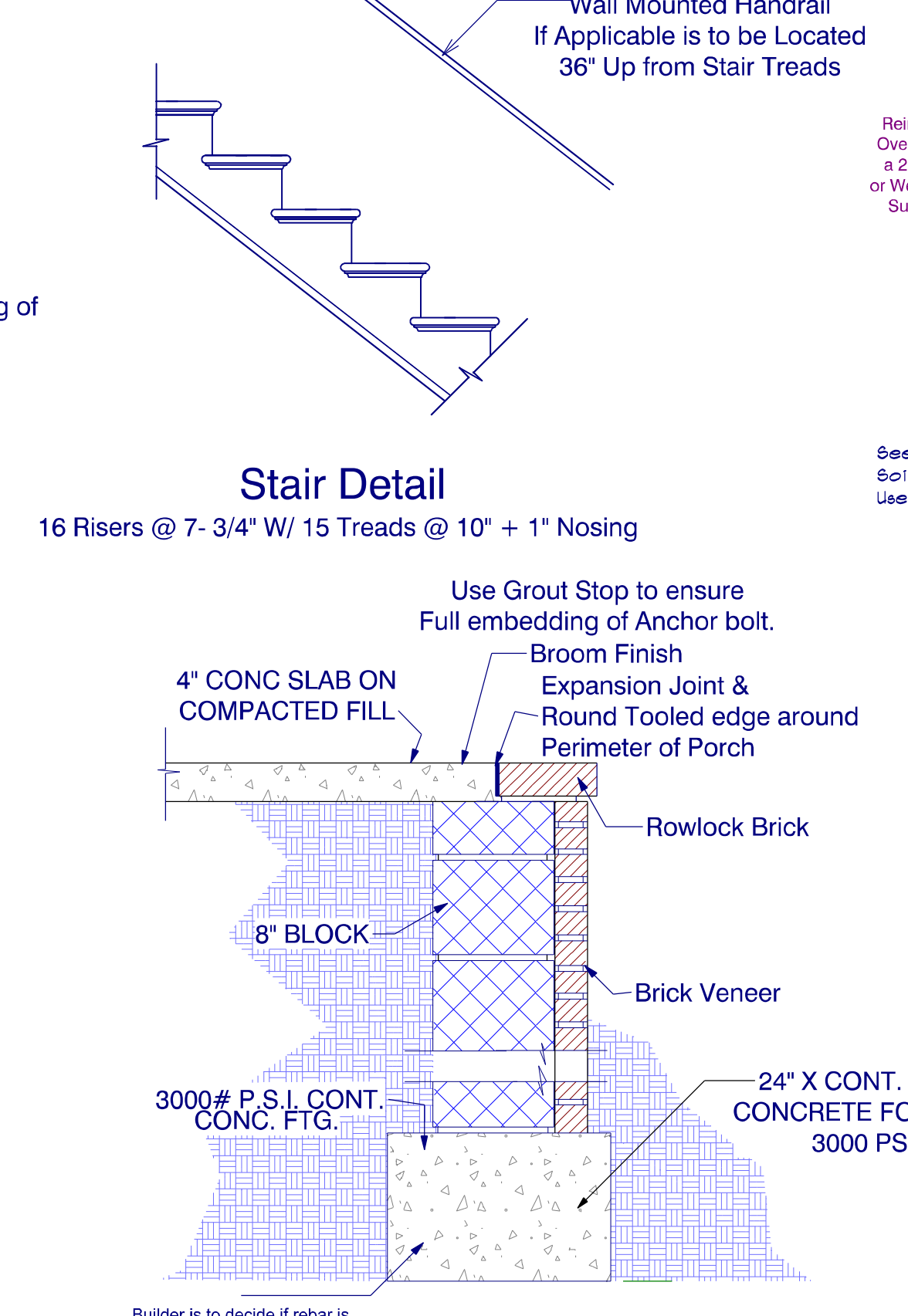
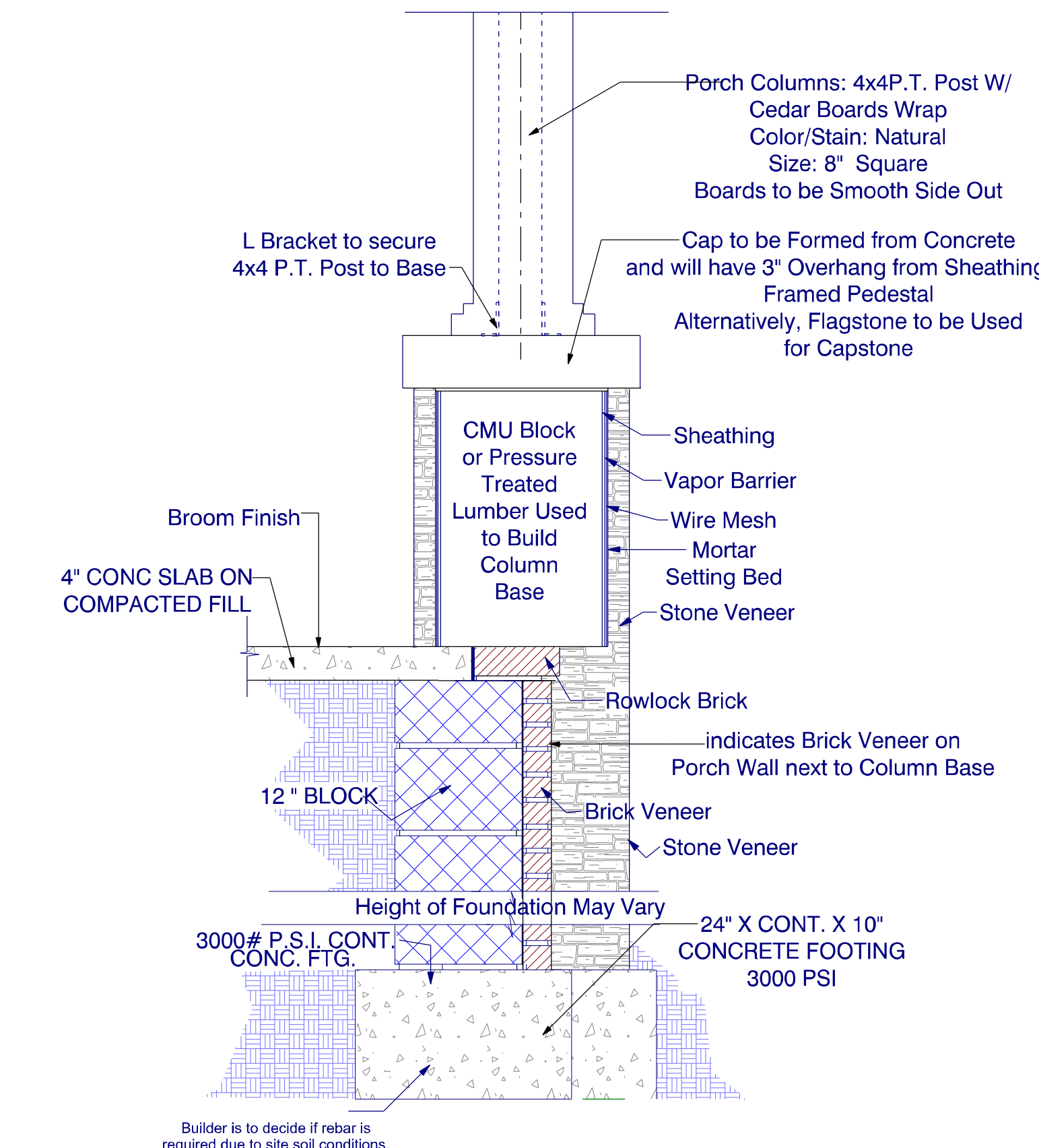

Project: Freshman Residence

MODEL: SEGC-2081

BUILDER: Southeastern General Contractors

DATE PRINTED: July 2023

DRAWN BY: ATF

Construction Details

SHEET 3

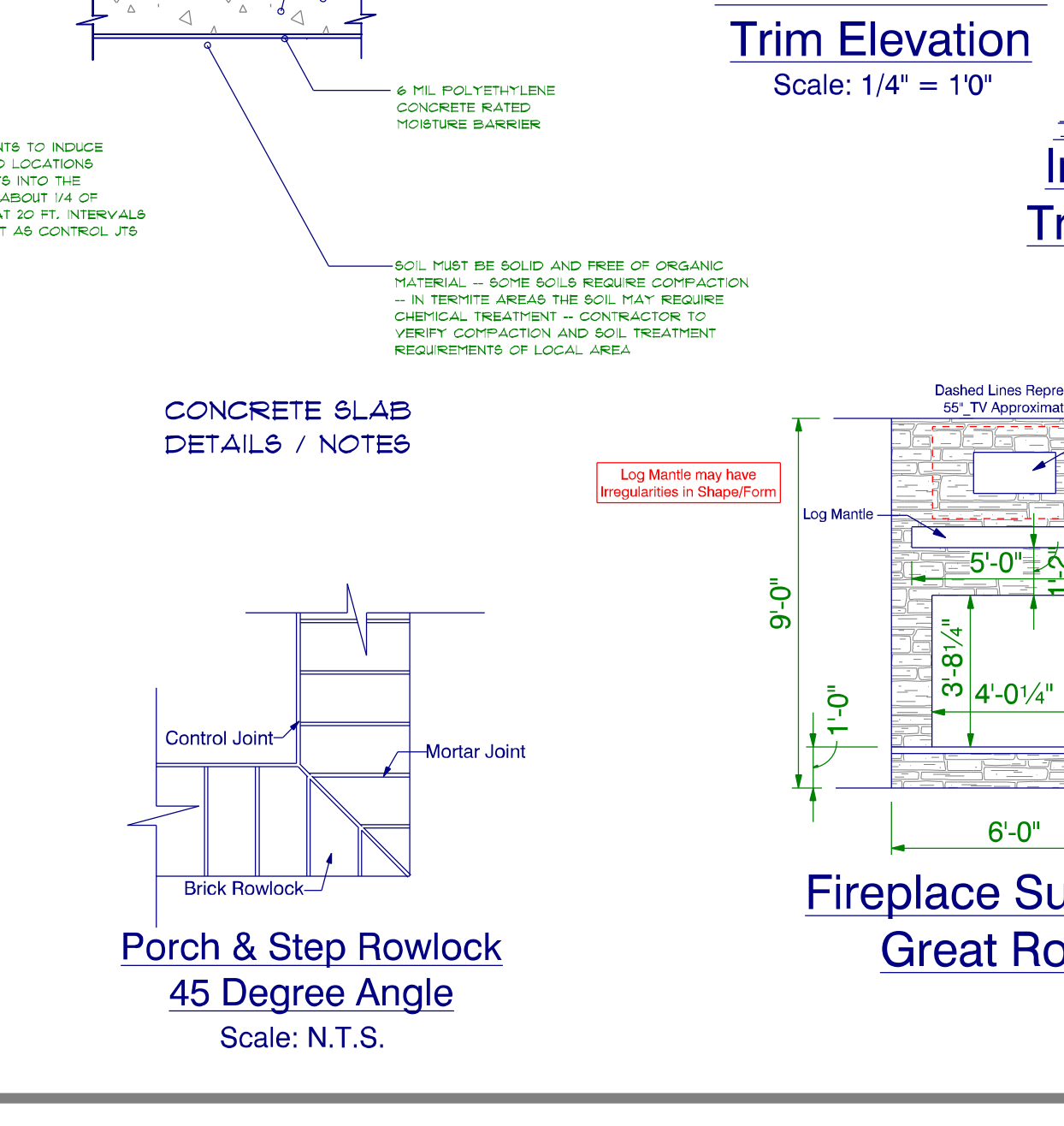
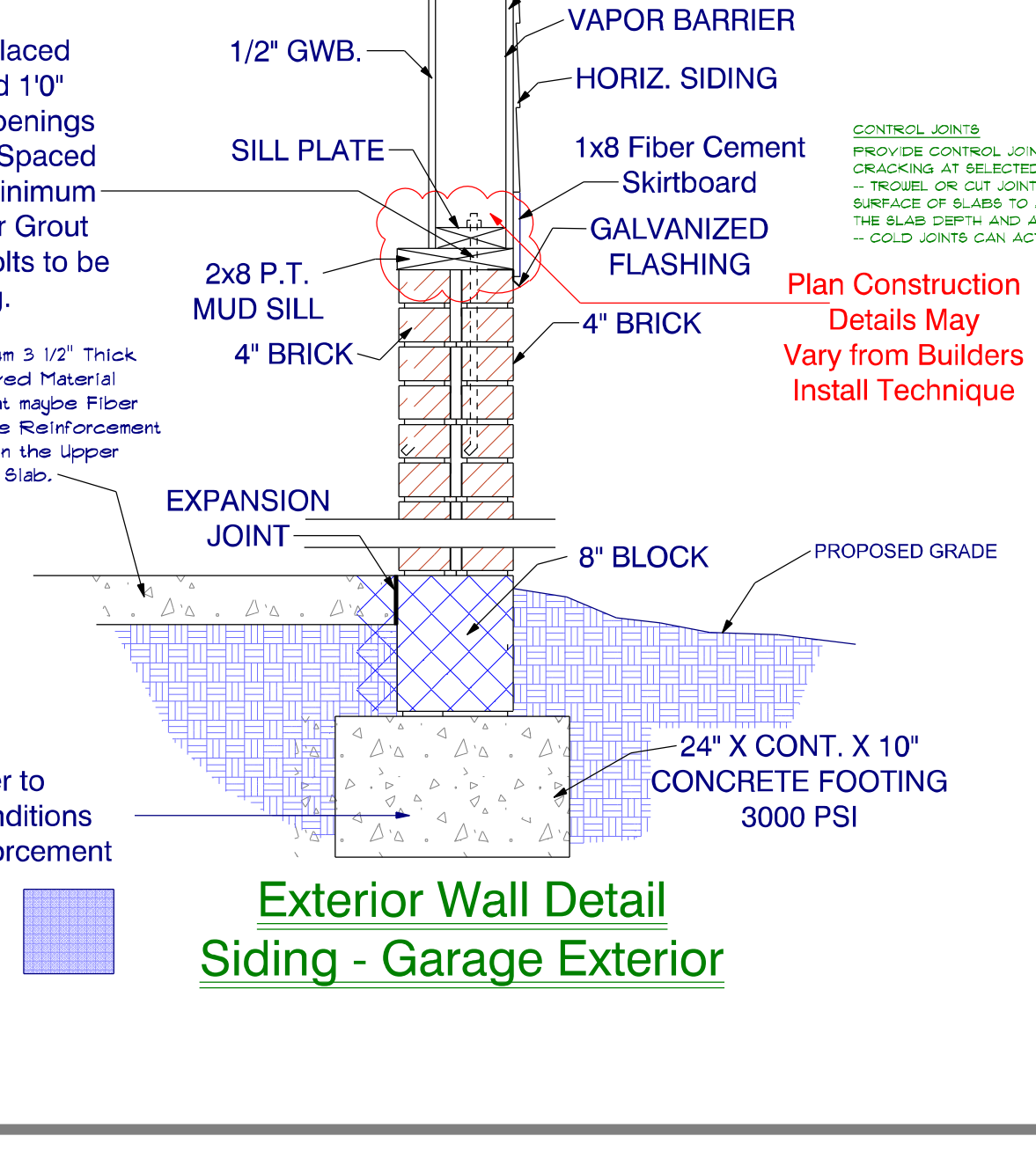
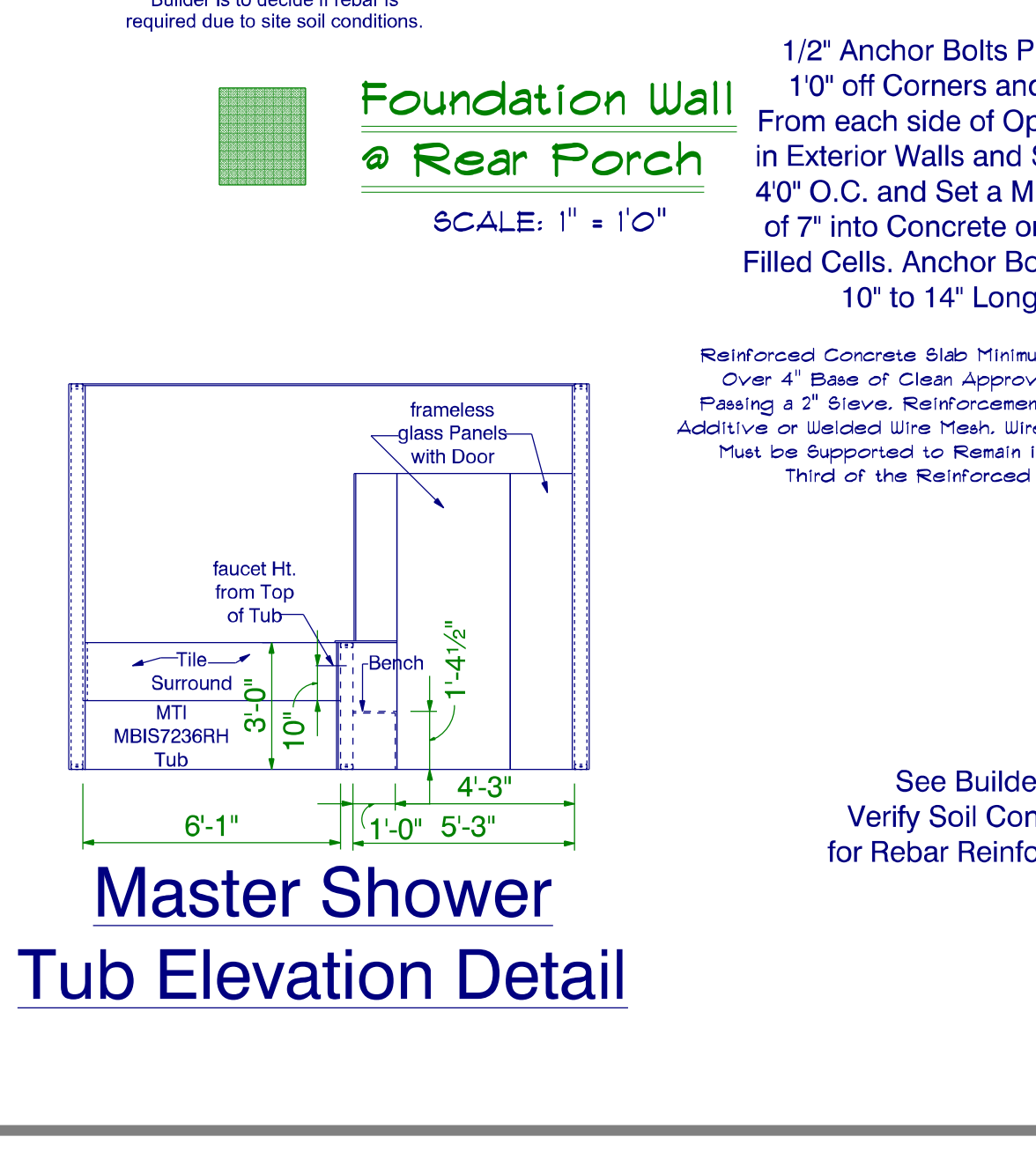
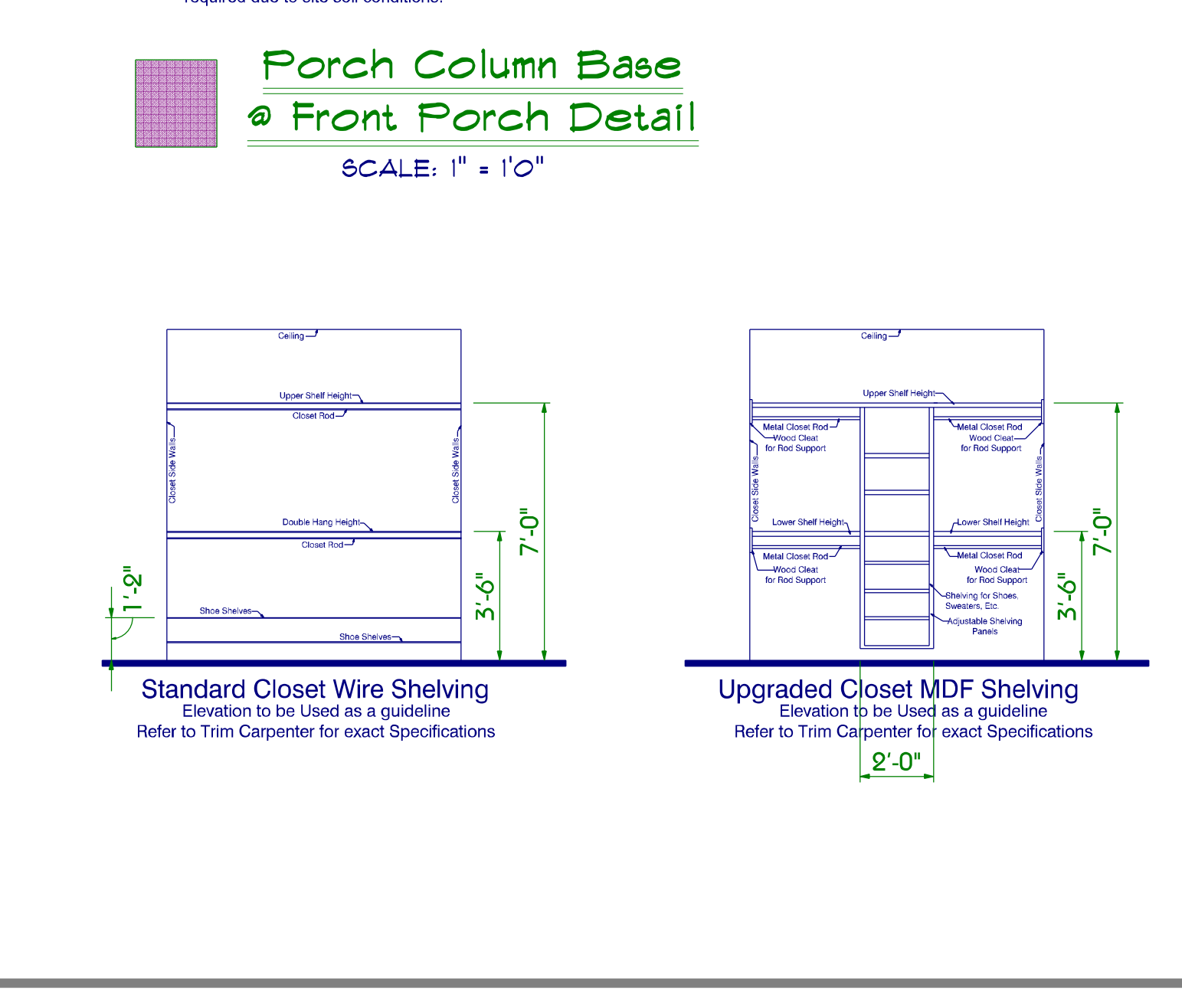

Standard Closet Wire Shelving  
Elevation to be Used as a guideline Refer to Trim Carpenter for exact Specifications

Upgraded Closet MDF Shelving  
Elevation to be Used as a guideline Refer to Trim Carpenter for exact Specifications

Master Shower Tub Elevation Detail

faucet Ht. from Top of Tub

3'-0"

1'-4 1/2"

4'-3"

1'-0"

5'-3"

6'-1"

2'-0"

frameless glass Panels with Door

MBIS7236RH Tub

2'-0"

See Builder to Verify Soil Conditions for Rebar Reinforcement

SCALE: 1" = 10"

Like Us on Facebook  
www.facebook.com/southeasterngc

Subscribe to us on YouTube  
www.youtube.com/southeasterngc

Follow Us on Pinterest  
www.pinterest.com/seginc/

Website:  
www.southeasterngc.com

Location:  
3059 N. Main Street  
Hope Mills NC  
28348 Suite 16  
Office Phone:  
1 910 824 7505