

4-Bedroom Septic Plan
 Lot #40 - Duncan's Crossing
 Harnett County
 Smith Douglas Homes

*House footprint to be field staked by surveyor and system verified prior to any construction

**Septic area must not be altered by

***No cuts of 2' or greater within

**** Recommend protective barrier around septic field during construction.

40

41,381 SF
 (0.95 AC)

*If plumbing is not sufficient a pump tank will be required to septic field.

System: Gravity to D-Box
 Lines: Lines 1-5 (350')
 0.4 LTAR
 24" Max Trench Bottom
 Accepted Status System
 Repair: Gravity to D-Box
 Lines: Lines 6-9 (300')
 0.4 LTAR
 18" Trench Bottom
 Accepted Status System

GRAPHIC SCALE
 1" = 50'

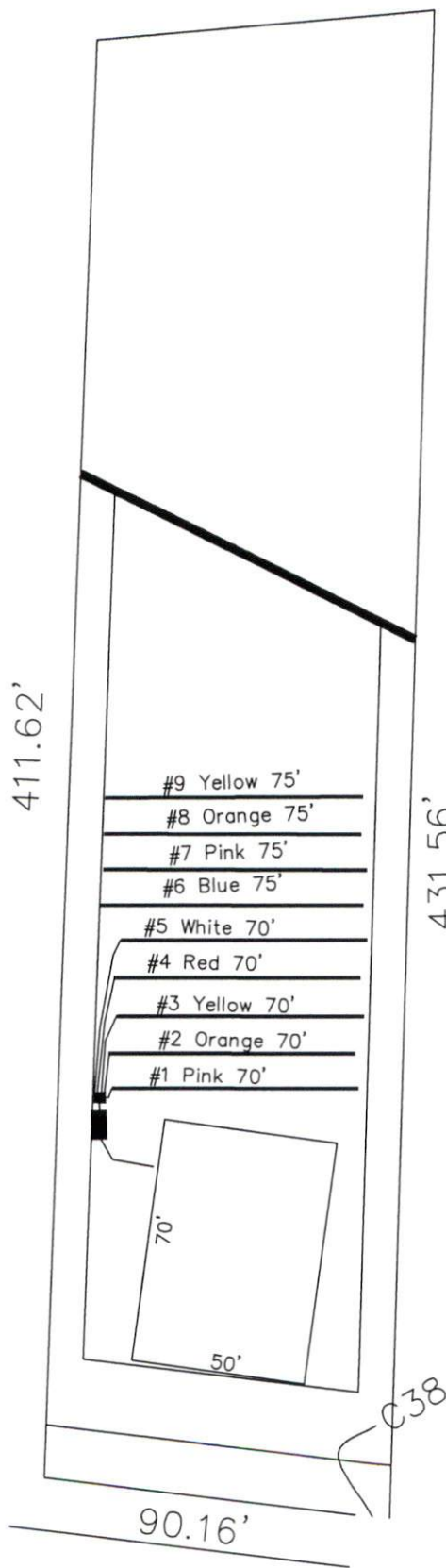

DECOY SPREAD
 50' R/W (PUBLIC
 & UTILITY ACCESS)

Adams
 Soil Consulting
 919-414-6761
 Job #1146