

4-Bedroom Septic Plan  
Lot #48 - Duncan's Crossing  
Harnett County  
Smith Douglas Homes

48

87,349 SF  
(2.01 AC)

\*House footprint to be field staked by surveyor and system verified prior to any construction

\*\*Septic area must not be altered by construction activities.

\*\*\*No cuts of 2' or greater within 15' of septic area

\*\*\*\* Recommend protective barrier around septic field during construction.

\*If plumbing is not sufficient a pump tank will be required to septic field.

System: Gravity to D-Box.  
Lines: Lines 4-6 (360')  
0.4 LTAR  
24" Max Trench Bottom  
Accepted Status System  
Repair: Gravity to serial dist.  
Lines: Lines 1-3 (350')  
0.4 LTAR  
24" Trench Bottom  
Accepted Status System

GRAPHIC SCALE  
1" = 50'

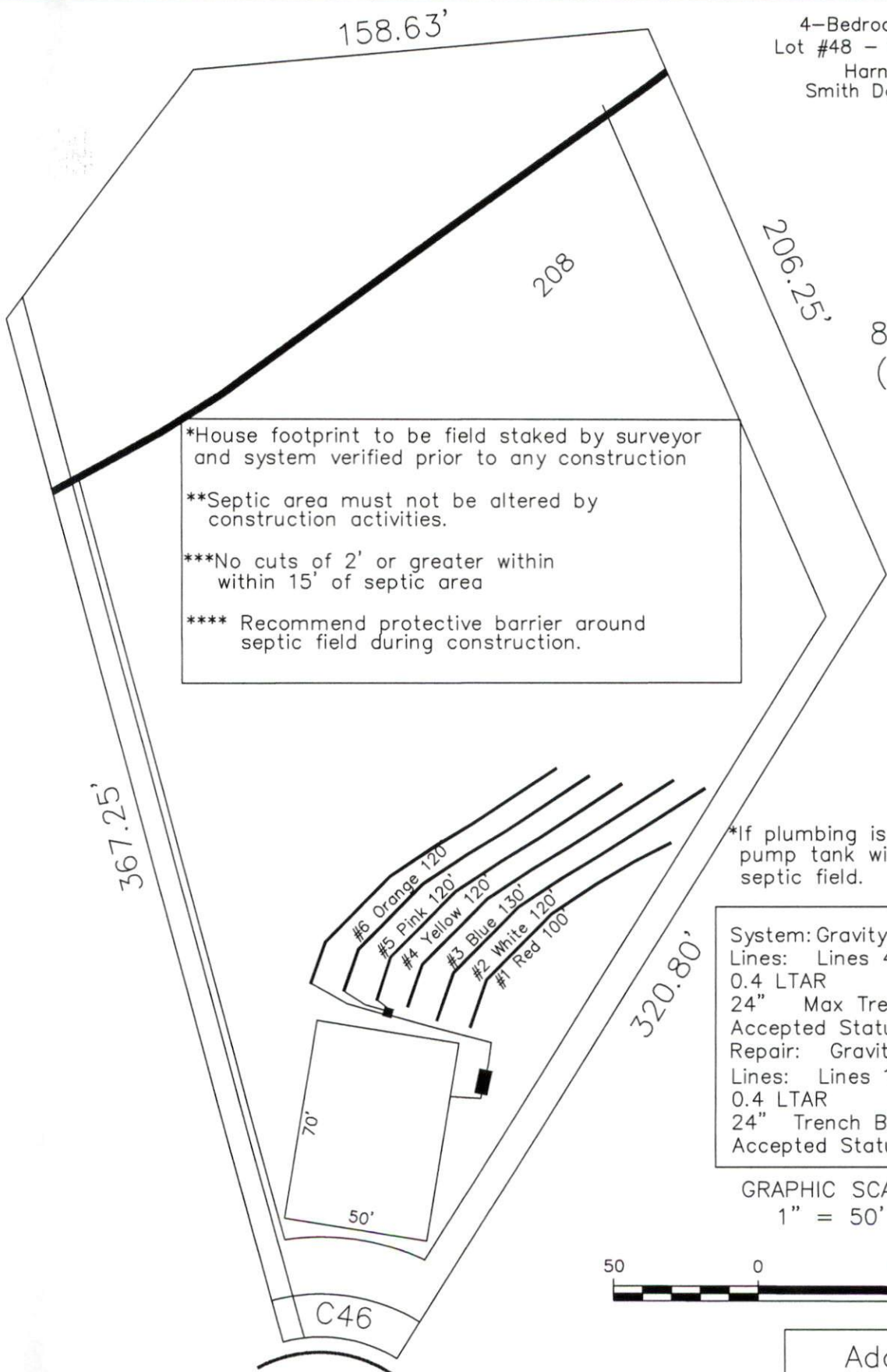

**DECOY SPREAD**  
50' R/W (PUBLIC  
& UTILITY ACCESS)

Adams  
Soil Consulting  
919-414-6761  
Job #1146