

4-Bedroom Septic Plan
Lot #38 - Duncan's Crossing
Harnett County
Smith Douglas Homes

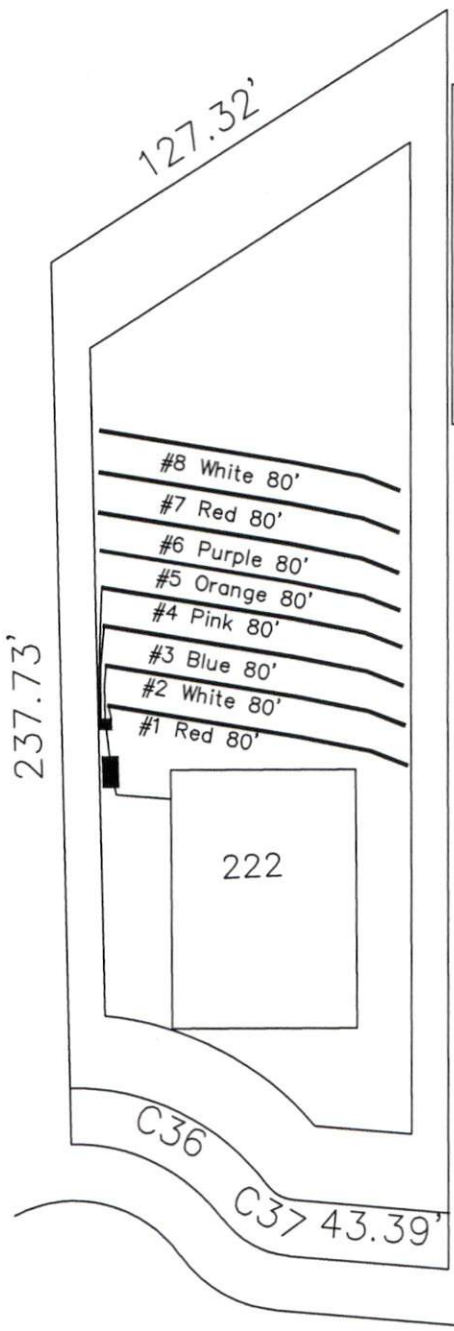

*House footprint to be field staked by surveyor and system verified prior to any construction

**Septic area must not be altered by

***No cuts of 2' or greater within

**** Recommend protective barrier around septic field during construction.

38

30,618 SF
(0.70 AC)

*If plumbing is not sufficient a pump tank will be required to septic field.

System: Gravity to D-Box
Lines: Lines 1-4 (320')
0.4 LTAR
24" Max Trench Bottom
Accepted Status System
Repair: Gravity to D-Box
Lines: Lines 5-8 (320')
0.4 LTAR
18" Trench Bottom
Accepted Status System

DECOY SPREAD
50' R/W (PUBLIC
& UTILITY ACCESS)

GRAPHIC SCALE
1" = 50'



Adams
Soil Consulting
919-414-6761
Job #1146