

3-Bedroom Septic Plan  
 Lot #36 - Duncan's Crossing  
 Harnett County  
 Smith Douglas Homes

\*House footprint to be field staked by surveyor and system verified prior to any construction  
 \*\*Septic area must not be altered by  
 \*\*\*No cuts of 2' or greater within  
 \*\*\*\* Recommend protective barrier around septic field during construction.

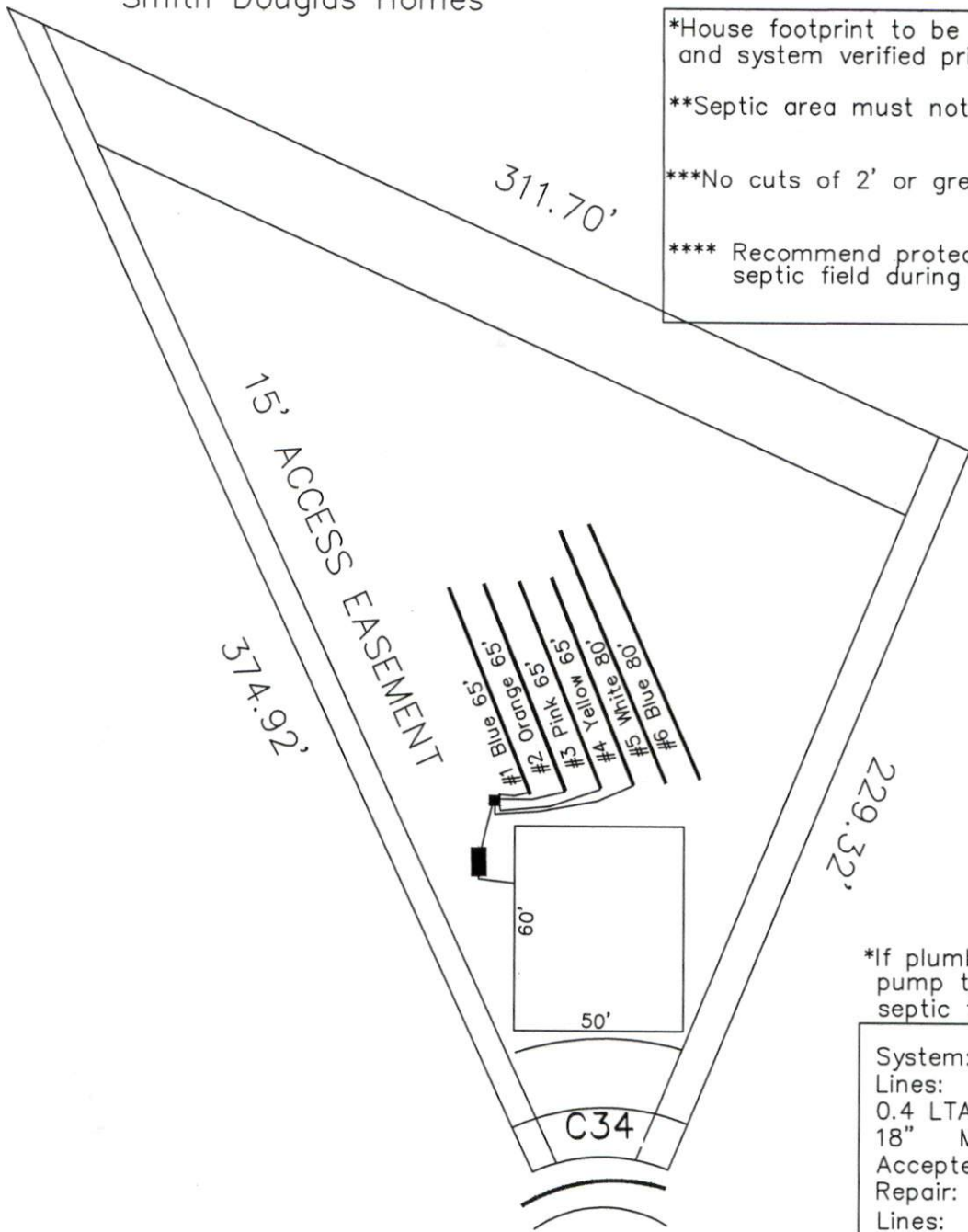

36  
 42,483 SF  
 (0.98 AC)

\*If plumbing is not sufficient a pump tank will be required to septic field.

System: Gravity to D-Box  
 Lines: Lines 1-4 (260')  
 0.4 LTAR  
 18" Max Trench Bottom  
 Accepted Status System  
 Repair: Pressure Manifold  
 Lines: Lines 5-6 (160')  
 0.4 LTAR  
 18" Trench Bottom  
 T&J Panel 50% reduction

**DECOY SPREAD**  
 50' R/W (PUBLIC  
 & UTILITY ACCESS)

GRAPHIC SCALE  
 1" = 50'



Adams  
 Soil Consulting  
 919-414-6761  
 Job #1146