

# Preliminary Soils Evaluation

## 14 Lots - HWY 55 and Bennett Road Coats, NC

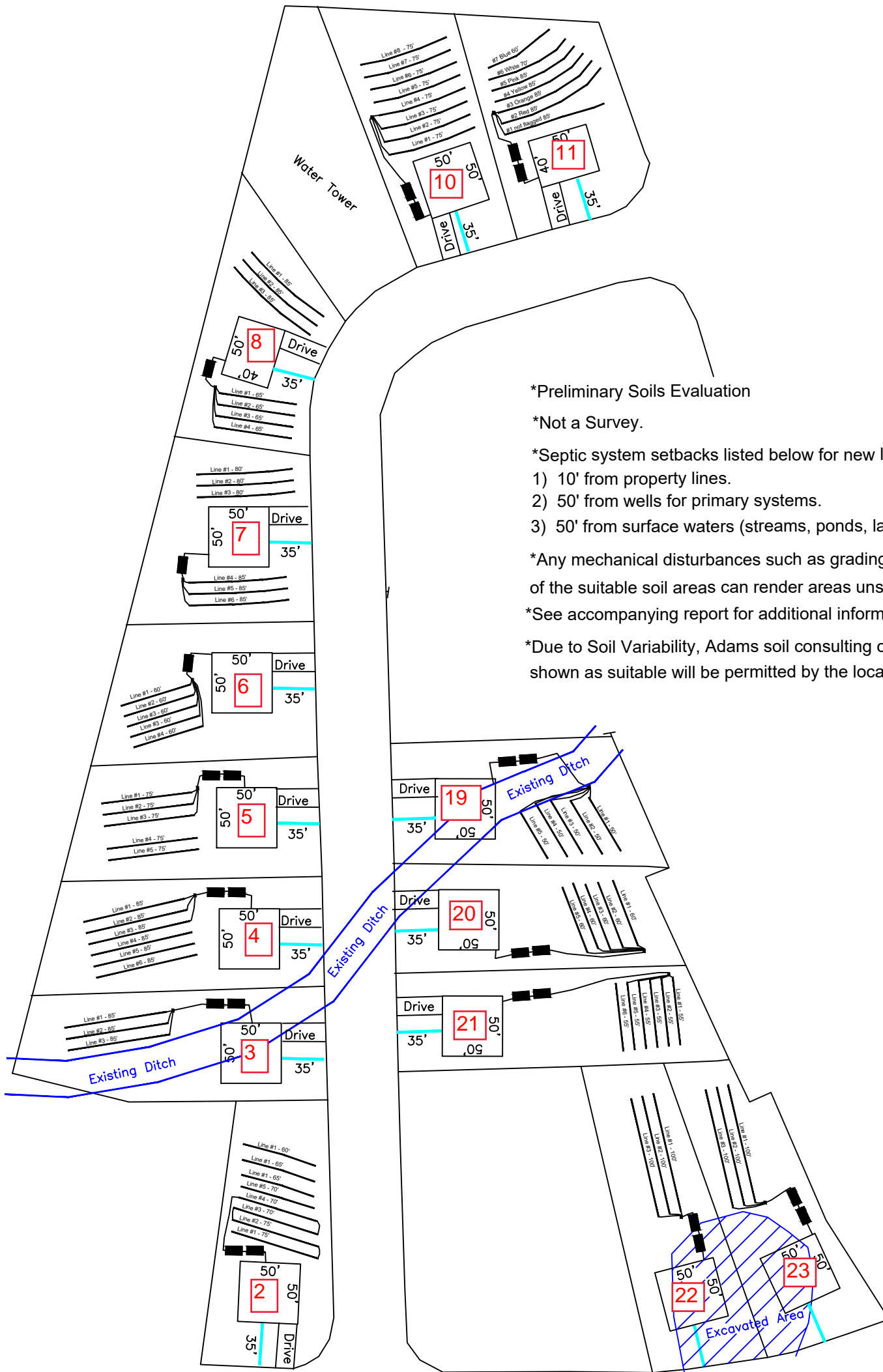

\*Preliminary Soils Evaluation

\*Not a Survey.

\*Septic system setbacks listed below for new lots.

- 1) 10' from property lines.
- 2) 50' from wells for primary systems.
- 3) 50' from surface waters (streams, ponds, lakes).

\*Any mechanical disturbances such as grading, cutting and filling of the suitable soil areas can render areas unsuitable for future septic systems.

\*See accompanying report for additional information.

\*Due to Soil Variability, Adams soil consulting cannot guarantee that the areas shown as suitable will be permitted by the local Health Department.

GRAPHIC SCALE  
1" = 100'

