

Connector Summary			
Flange	Product	Manuf	Qty
None	HHUS410	Simpson	1
None	HUC3514		3
None	IUS2.37/14	Simpson	13
None	MIT3514-2	Simpson	3

Products					
Net Qty	Plies	Product	Length	PlotID	
3	1	14" BCI® 6000s-1.8	27-0-0	J2-1	
4	2	14" BCI® 6000s-1.8	27-0-0	J2-2	
7	1	14" BCI® 6000s-1.8	21-0-0	J2-3	
2	2	14" BCI® 6000s-1.8	21-0-0	J2-4	
31	1	14" BCI® 6000s-1.8	18-0-0	J2-5	
4	1	14" BCI® 6000s-1.8	13-0-0	J2-6	
2	1	14" BCI® 6000s-1.8	9-0-0	J2-7	
7	1	14" BCI® 6000s-1.8	6-0-0	J2-8	
2	2	14" BCI® 6000s-1.8	6-0-0	J2-9	
2	2	1-3/4" x 9-1/2" VERSA-LAM® 2.0 3100 SP	10-0-0	BM2-1	
2	2	1-3/4" x 14" VERSA-LAM® 2.0 3100 SP	22-0-0	BM2-2	
2	2	1-3/4" x 14" VERSA-LAM® 2.0 3100 SP	10-0-0	BM2-3	
2	2	1-3/4" x 14" VERSA-LAM® 2.0 3100 SP	8-0-0	BM2-4	
17	1	1-1/8" x 14" BC RIM BOARD OSB	12-0-0	Rim1	
37	1	14" BLOCKING	2-0-0	Blk1	

Connect all 2-ply joists in the field per detail F58.

F58

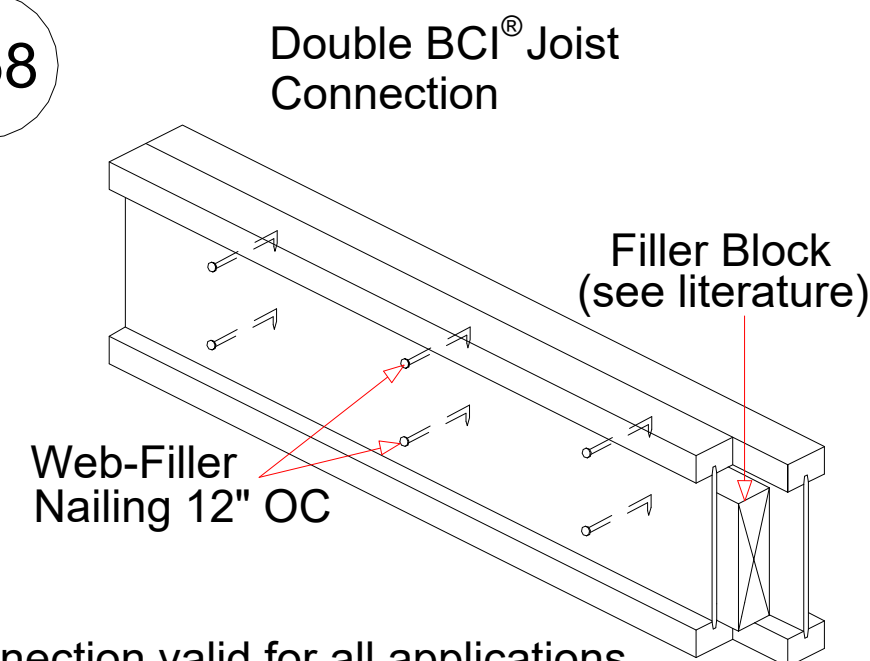

Connection valid for all applications. Contact Boise EWP Engineering for specific conditions.



▲ = LEFT END OF TRUSS

REVISIONS:

NOT FOR CONSTRUCTION



Moncks Corner/Easley, SC (800) 475-3999
Sparta, NC (336) 372-2226

Client: **MATTAMY HOMES-RALEIGH**
 Job: **LOT 14 PROVIDENCE CREEK**
 Plan Information:
SHENANDOAH-CR
 OPTIONS
 NOT TO SCALE
 Date: DATE
 Job #: Sales Rep: KYLE GIBSON
 Drawn By: MBB Phone: 23-5847-J02

LEVEL