

**SOIL/SITE EVALUATION
 for ON-SITE WASTEWATER SYSTEM**

Owner: Applicant: Paramount Homes Inc
 Address: 262 Hook Dr Date Evaluated: 9-8-23
 Proposed Facility: SFD 68'x44.9' Design Flow (.1949): 480
 Location of Site: Property Recorded:
 Water Supply: Public Individual Well Spring Other
 Evaluation Method: Auger Boring Pit Cut
 Type of Wastewater: Sewage Industrial Process Mixed

P R O F I L E #	.1940 Landscape Position/ Slope %	Horizon Depth (In.)	SOIL MORPHOLOGY .1941		OTHER PROFILE FACTORS				Profile Class & LTAR
			.1941 Structure/ Texture	.1941 Consistence Mineralogy	.1942 Soil Wetness/ Color	.1943 Soil Depth (IN.)	.1956 Sapro Class	.1944 Restr Horiz	
1	2-4%	0-14	SL	VF, gc, NS, NP					
		14-26	SCL	FI, SBK, S, P	26" ROCKS	26"		Rocky	.3
2	2-4%	0-14	SL	VF, gc, NS, NP					
		14-33	SCL	FI, SBK, S, P	34"	35"			.3
3	3-4%	0-20	SL	VF, gc, NS, NP					
		20-42	SCL	FI, SBK, S, P	38"	42"			.3
4	3-4%	0-10	SL	VF, gc, NS, NP					
		10-20	SCL	FI, SBK, S, P	27"	27"			.3

Description	Initial System	Repair System	Other Factors (.1946):
Available Space (.1945)	✓	✓	Site Classification (.1948): PS
System Type(s)	SOPD	SOPD	Evaluated By: JMW/RL
Site LTAR	.3	.3	Others Present:

COMMENTS: _____

LANDSCAPE POSITIONS	GROUP	TEXTURES	.1955 LTAR	CONSISTENCE MOIST	WET
R-RIDGE	I	S-SAND	1.2 - 0.8	VFR-VERY FRIABLE FR-FRIABLE	NS-NON-STICKY SS-SLIGHTLY STICKY
S-SHOULDER SLOPE L-LINEAR SLOPE		LS-LOAMY SAND			
FS-FOOT SLOPE	II	SL-SANDY LOAM	0.8 - 0.6	FI-FIRM VFI-VERY FIRM	S-STICKY VS-VERY STICKY
N-NOSE SLOPE H-HEAD SLOPE		L-LOAM			
CC-CONCLAVE SLOPE	III	SI-SILT	0.6 - 0.3	EFI-EXTREMELY FIRM	NP-NON-PLASTIC SP-SLIGHTLY STICKY P-PLASTIC VP-VERY PLASTIC
CV-CONVEX SLOPE		SIL-SILT LOAM			
T-TERRACE		CL-CLAY LOAM			
FP-FLOOD PLAN		SCL-SANDY CLAY LOAM			
	IV	SIC-SILTY CLAY C-CLAY SC-SANDY CLAY	0.4 - 0.1		

STRUCTURE

- SG-SINGLE GRAIN
- M- MASSIVE
- CR-CRUMB
- GR-GRANULAR
- SBK-SUBANGULAR BLOCKY
- ABK-ANGULAR BLOCKY
- PL-PLATY
- PR-PRISMATIC

MINERALOGY

- SLIGHTLY EXPANSIVE
- EXPANSIVE

Show profile locations and other site features (dimensions, references or benchmark, and North)

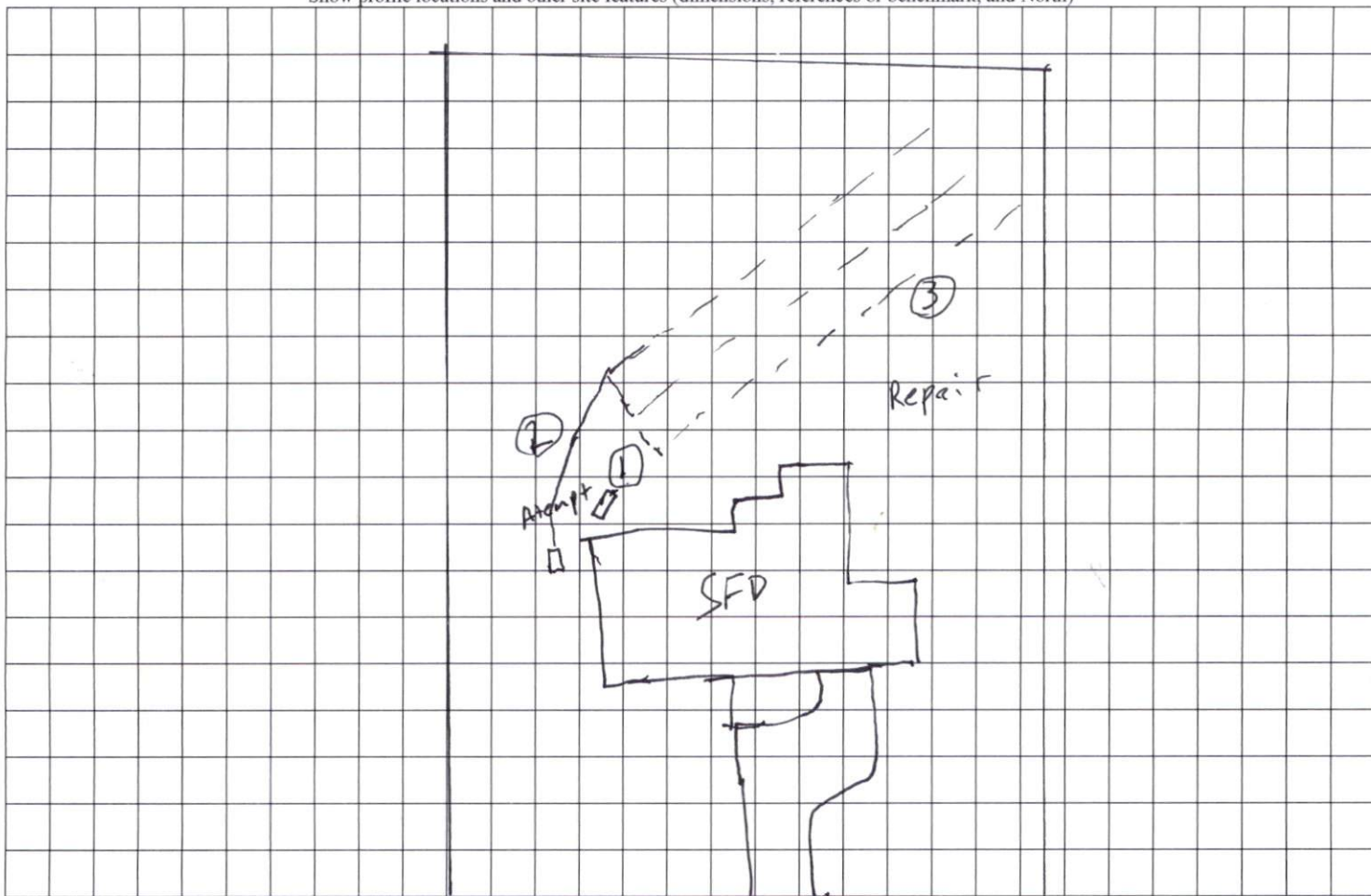

17/2023 Contours Added
 9-2023 Moved Hse 3' Back

Site Plan

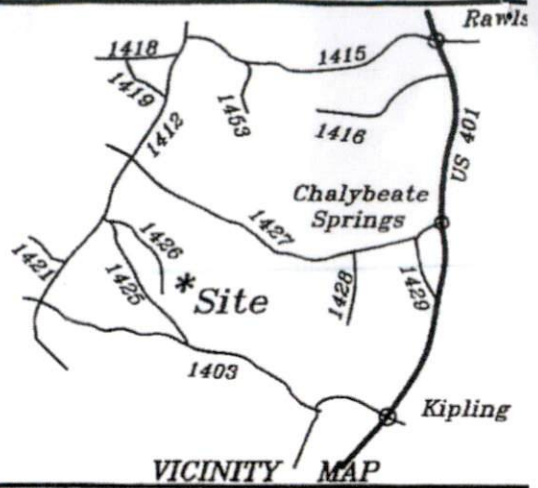

VICINITY MAP
 262 Hook Dr. Fuquay Varina, N
 Cotton Farms, Lot 12
 Deed Book 2023, Page 200-207
 PIN: 0643-35-6775

Mapped for:
Wade Macht
Paramount Home

Hector's Creek Twp. | Harnett Cour
 Scale: 1" = 40' | Date: 6/28/2023

Surveyed & Mapped By
STANCIL & ASSOCIATE
 Professional Land Surveyor, P.A. C-0
 P.O. Box 730, Angier, N.C. 27501
 919-639-2133 919-639-2602 (FA
 stancilsurvey@gmail.com

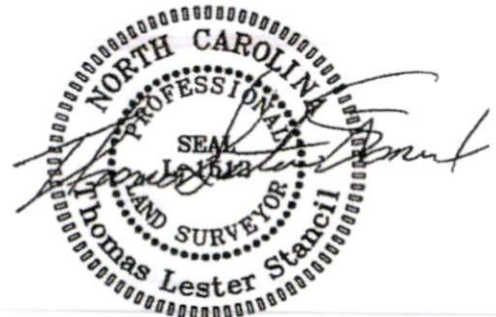

NOT FOR RECORDATION

11
 Havey Homes LLC
 d Book 4197, Page 1318
 Number 2023-200

N 42°20'45"E 215.69'
 5' Utility and Drainage
 Easement per Covenants

12
 0.58 Ac.
 Maximum Allowable
 Impervious Surface
 7000 sq. ft.
 Latitude: 35.4969
 Longitude: -78.8533

13
 Reese Construction LLC
 Deed Book 3912, Page 977
 Map Number 2023-200

Proposed Impervious Surfaces
 3238 sq. ft. Dwelling (includes Porches)
 1211 sq. ft. Driveway
 105 sq. ft. Sidewalk
 20 sq. ft. Misc (NE Air Handler)
 4574 sq. ft. Total Proposed Impervious



Family
 Page 340
 3332.0
 18.42
 22-52
 25-11
 25-11

4/8" = 50/50
 3/8" = 25/50
 3/16" = 20/50
 1/8" = 10/50
 1/16" = 5/50

