

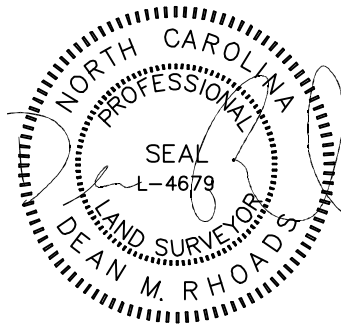

**VICINITY MAP**  
Not To Scale



IMPERVIOUS SURFACE AREA	
DESCRIPTION	AREA
HOUSE w/ PORCH	1,352 S.F.
SC PORCH/HVAC	109 S.F.
DRIVEWAY & WALKS	415 S.F.
TOTAL (PROPOSED)=	1,876 S.F.
*TOTAL (ALLOWED)=	2,530 S.F.

\*PB 2023 PG 356

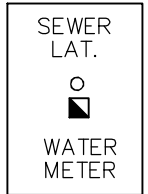

**SETBACKS: (PB 2023 PG 350)**

FRONT - 20'  
REAR - 20'  
SIDE - 4' & 4' OR 0' & 8'  
CORNER YARD - 12'

N/F  
GREENFIELD SERENITY INVESTCO LLC  
DB 3952 PG 793

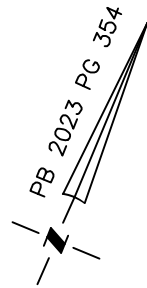
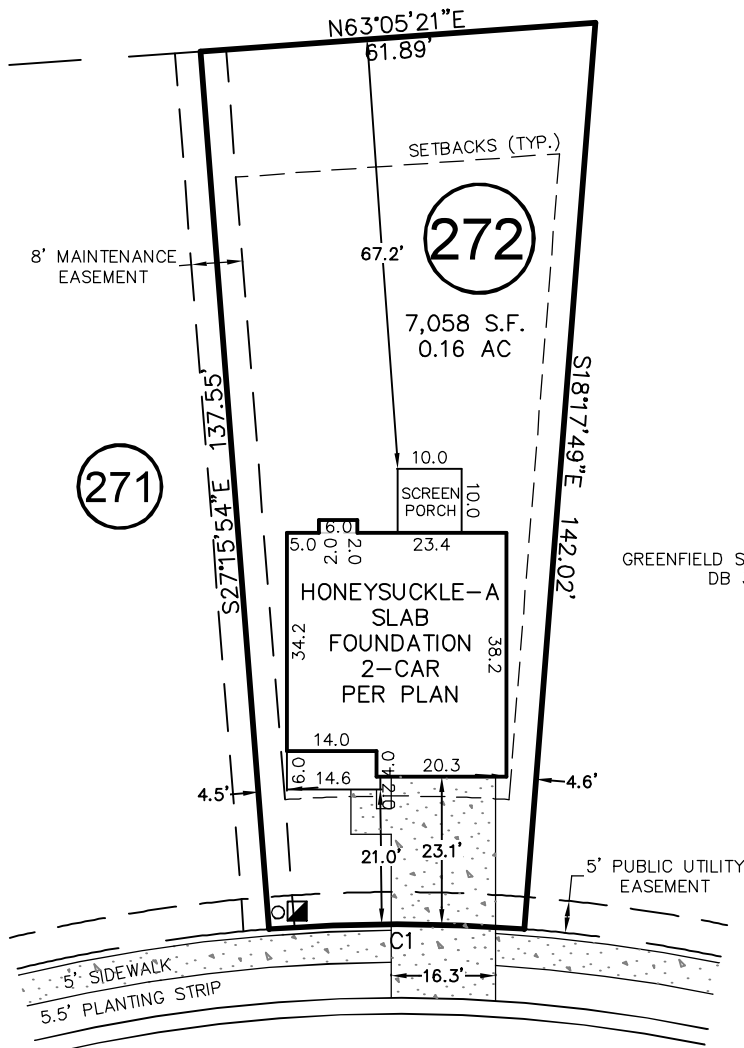

N/F  
GREENFIELD SERENITY INVESTCO LLC  
DB 3952 PG 793

# SNEED LANE

50' PUBLIC R/W  
& UTILITY

CURVE	RADIUS	ARC LENGTH	CH LENGTH	CH BEARING
C1	255.00'	39.91'	39.87'	S67°13'09"W

THIS PROPERTY MAY BE SUBJECT TO ANY AND ALL APPLICABLE DEED RESTRICTIONS, EASEMENTS, RIGHT-OF-WAY, UTILITIES AND RESTRICTIVE COVENANTS WHICH MAY BE OF RECORD OR IMPLIED

THIS DRAWING DOES NOT REFLECT AS-BUILT INFORMATION

**PRELIMINARY PLAT**  
NOT FOR RECORDATION, CONVEYANCES, OR SALES.

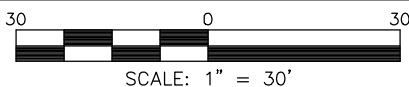

## RESIDENTIAL LAND SERVICES, PLLC.

1917 Evans Road  
Cary, North Carolina 27513  
Phone (919) 378-9316  
Firm License # P-0873

### HOUSE LOCATION PLOT PLAN

FOR  
#378 SNEED LANE  
LOT 272, SERENITY SUBDIVISION, PHASE 1D, 1F & 2G  
(LOTS LESS THAN 9,000 SF) LOTS 144-167, & 248-272  
Hector's Creek Township, Harnett County, North Carolina

PROPERTY OF: GARMAN HOMES  
MAP BOOK 2023 PAGE 350-356 DEED REFERENCE \_\_\_\_\_

DRAWN: JLA | SURVEYED: N/A | CHECKED: DMR | DATE: JUNE 5, 2023