

Harnett County Department of Public Health

Improvement Permit

A building permit cannot be issued with only an Improvement Permit

PROPERTY LOCATION: 430 Saint Clair

SUBDIVISION Birchwood Grove

LOT # 178

ISSUED TO: KB Home

NEW REPAIR EXPANSION

Site Improvements required prior to Construction Authorization Issuance:

Type of Structure: SFD (56'x43')

Proposed Wastewater System Type: Pump to 25% Red Svs

Projected Daily Flow: 600 GPD

Number of bedrooms: 5 Number of Occupants: 10 max

Basement Yes No

Pump Required: Yes No May be required based on final location and elevations of facilities

Type of Water Supply: Community Public Well Distance from well _____ feet

Permit valid for:

Five years

No expiration

Permit conditions:

Authorized State Agent: _____

RCAS

Date: 9/22/23

SEE ATTACHED SITE SKETCH

The issuance of this permit by the Health Department in no way guarantees the issuance of other permits. The permit holder is responsible for checking with appropriate governing bodies in meeting their requirements. This site is subject to revocation if the site plan, plat, or the intended use changes. The Improvement Permit shall not be affected by a change in ownership of the site. This permit is subject to compliance with the provisions of the Laws and Rules for Sewage Treatment and Disposal and to conditions of this permit.

Construction Authorization

(Required for Building Permit)

The construction and installation requirements of Rules .1950, .1952, .1954, .1955, .1956, .1957, .1958, and .1959 are incorporated by references into this permit and shall be met. Systems shall be installed in accordance with the attached system layout.

ISSUED TO: KB Home

PROPERTY LOCATION: 430 Saint Clair

SUBDIVISION Birchwood Grove

LOT # 178

Facility Type: SFD (56'x43') New Expansion Repair

Basement? Yes No Basement Fixtures? Yes No

Type of Wastewater System** Pump to 25% Reduction System (Initial) Wastewater Flow: 600 GPD

(See note below, if applicable)

Pump to Panel Block (Repair)

Installation Requirements/Conditions

Septic Tank Size 1250 gallons

Pump Tank Size 1250 gallons

Number of trenches 1

Exact length of each trench 520 feet

Trenches shall be installed on contour at a

Maximum Trench Depth of: 18 inches

(Trench bottoms shall be level to $\pm 1/4"$

in all directions)

Trench Spacing: 9 Feet on Center

Soil Cover: 6 inches

(Maximum soil cover shall not exceed

36" above the trench bottom)

Pump Requirements: _____ ft. TDH vs. _____ GPM

_____ inches below pipe

Aggregate Depth: _____ inches above pipe

_____ inches total

WATER LINES (INCLUDING IRRIGATION) MUST BE 10FT. FROM ANY PART OF SEPTIC SYSTEM OR REPAIR AREA.

NO UTILITIES ALLOWED IN INITIAL OR REPAIR DRAIN FIELD AREA.

***If applicable: I understand the system type specified is different from the type specified on the application. I accept the specifications of this permit.*

Owner/Legal Representative Signature: _____

Date: _____

This Construction Authorization is subject to revocation if the site plan, plat, or the intended use changes. The Construction Authorization shall not be transferred when there is a change in ownership of the site. This

Construction Authorization is subject to compliance with the provisions of the Laws and Rules for Sewage Treatment and Disposal and to the conditions of this permit.

SEE ATTACHED SITE SKETCH

Authorized State Agent: _____

RCAS

Date: 9/22/23

Construction Authorization Expiration Date: 9/22/28

Application # SFD2306-0081

Harnett County Department of Public Health Site Sketch

Property Location: 430 Saint Clair

Issued To: KB Home Subdivision Birchwood Grove Lot # 178

Authorized State Agent: ~~REMS (OLIVER TOLKSDORF)~~ Date: 9/22/23

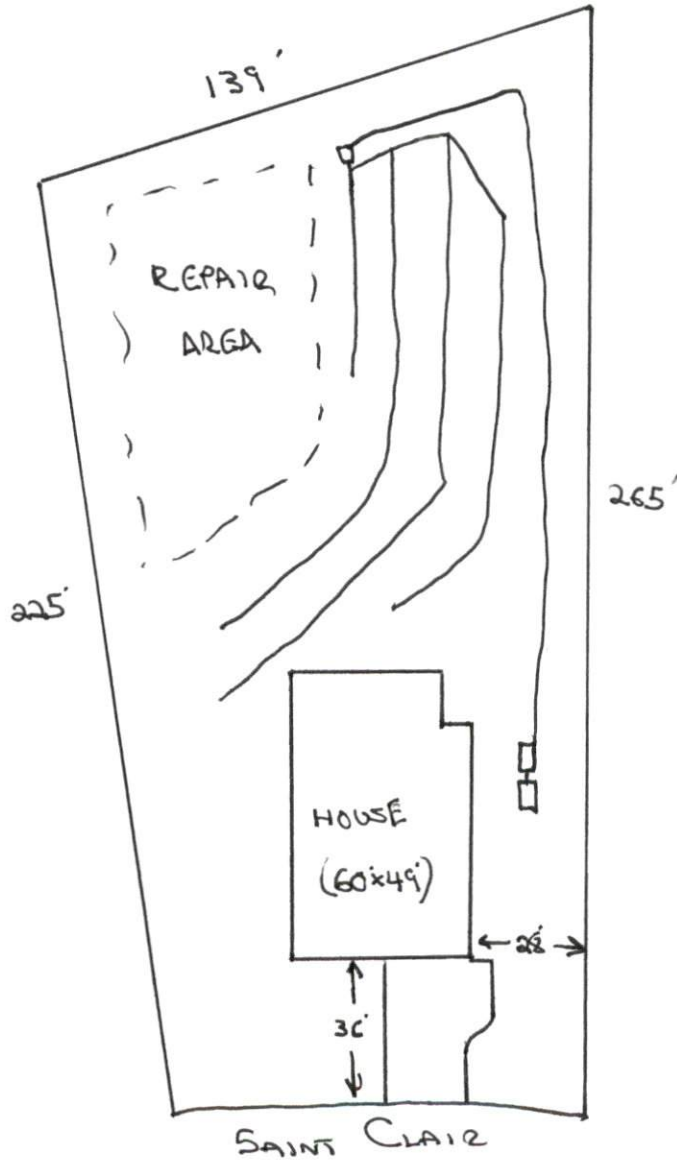

This drawing is for illustrative purposes only. System installation must meet all pertinent laws, rules, and regulations.