

WARNING! Long span trusses, 60' or greater in length, require extreme care and experience for proper and safe handling and installation. For general handling and installation guidance, see the "Guide to Good Practice for Handling, Installing, Restraining & Bracing of Metal Plate Connected Wood Trusses" ("BCSI"), JOINTLY PRODUCED BY SBCA and TPI. For project specific guidance, consult with a registered design professional. ATLANTIC assumes no responsibility for the handling, installation or bracing of trusses.

TRUSS TO TRUSS CONNECTIONS
ARE 3-10d TOE-NAILS U.N.O.

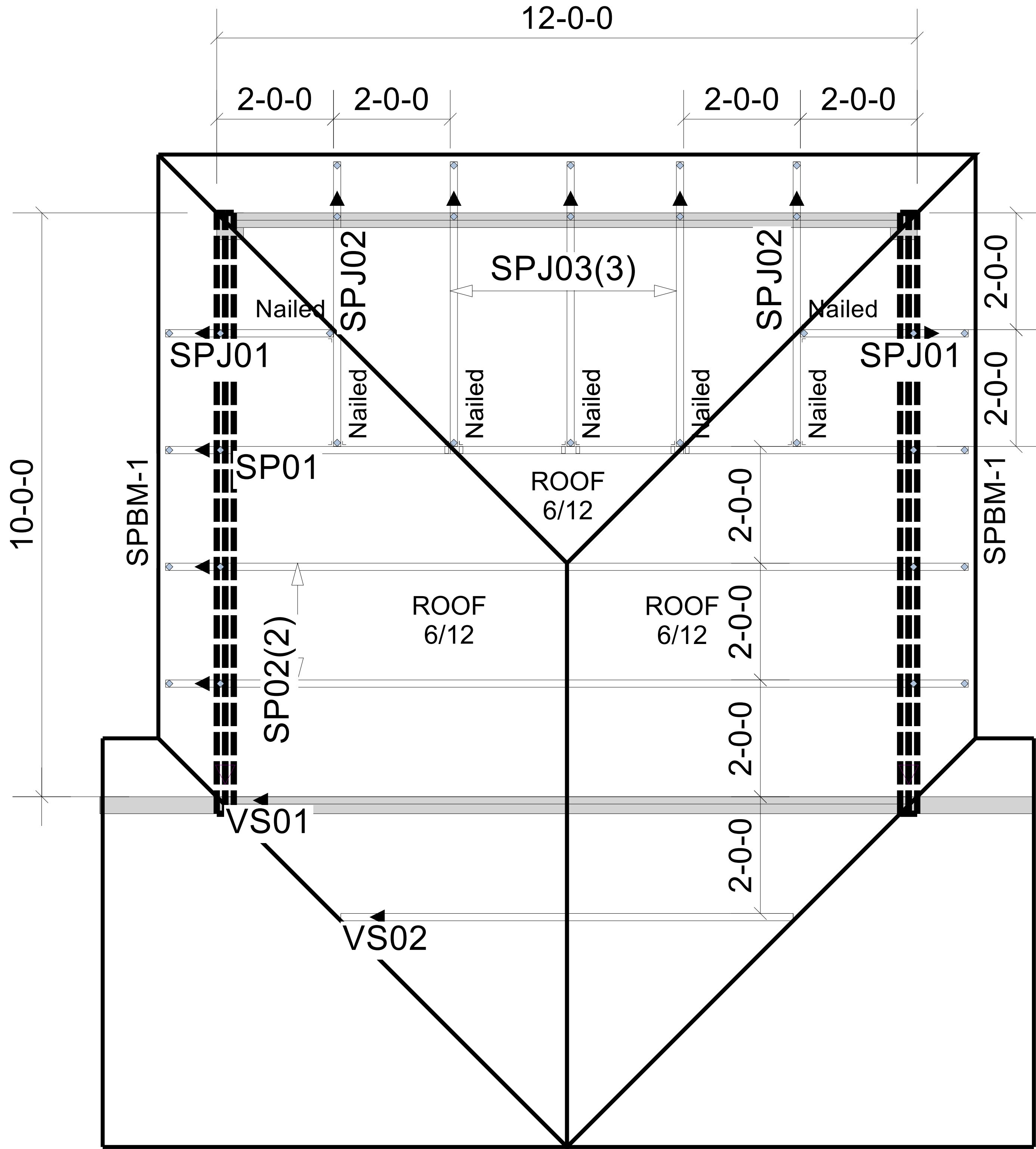

Products

PlotID	Length	Product	Plies	Net Qty
SPBM-1	12-00-00	1-3/4" x 9-1/2" VERSA-LAM® 2.0 3100 SP	2	4

▲ = LEFT END OF TRUSS

NOT FOR CONSTRUCTION



Moncks Corner/Easley, SC (800) 475-3999
Sparta, NC (336) 372-2226

REVISIONS:

Client: MATTAMY HOMES-RALEIGH

Job: LOT 39 PROVIDENCE CREEK

Plan Information:
CLEARWATER-CR

NOT TO SCALE

Date: 08/02/23

Drawn By:
AMH

Job #: Sales Rep: KYLE GIBSON
23-5652-R01 Phone:

ROOF