

PLOT PLAN FOR  
**NEW HOME, INC., LLC**  
 156 DUNCAN CREEK ROAD  
 LOT 169, DUNCAN'S CREEK PHASE 1  
 UPPER LITTLE CREEK TOWNSHIP, HARNETT COUNTY, NORTH CAROLINA

OPEN SPACE

S 78°33'20" W 102.90'

(169)  
 29,261 S.F.  
 0.672 AC

SETBACK LINES



**LEGEND**

- ▲ AIR CONDITIONER
- BC BACK OF CURB
- BFP BACK FLOW PREVENTER
- CLEANOUT
- CURB INLET
- DHS DRILL HOLE SET
- ECM EXISTING CONCRETE MONUMENT
- EDH EXISTING DRILL HOLE
- EIS EXISTING IRON STAKE
- EIP EXISTING IRON PIPE
- EM ELECTRIC METER
- EPK EXISTING PK NAIL
- ES ELECTRIC STUB
- ↖ FLARED END SECTION
- ⊕ FIRE HYDRANT
- ⊕ FIBER OPTIC PEDESTAL
- ⊕ GAS METER
- GUY
- INVERT
- IPS IRON PIPE SET
- IRS IRON ROD SET
- LIGHT POLE
- MNS MAGNETIC NAIL SET
- ⊕ MANHOLE SANITARY SEWER
- ⊕ MANHOLE STORM SEWER
- OHV OVERHEAD WIRES
- PKS PK NAIL SET
- PNS POINT NOT SET
- RRS RAIL ROAD SPIKE
- ⊕ TELEPHONE PEDESTAL
- ⊕ TRANSFORMER
- ⊕ CABLE TV PEDESTAL
- ⊕ UTILITY POLE
- ⊕ WATER METER
- ⊕ WATER VALVE
- ⊕ YARD INLET
- ( ) FIELD MEASUREMENT

(168)

S 02°11'27" W 280.74'

S 02°11'27" W 302.84'

(172)

(171)

(170)

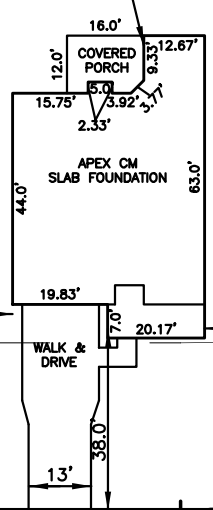

**SETBACK INFO**

FRONT:	35'
REAR:	25'
SIDES:	10'
CORNER SIDE:	20'

N 87°48'33" W 65.00' C1  
**DUNCAN CREEK ROAD**  
 50' PUBLIC R/W

NUM	RADIUS	ARC	DELTA	CHORD BRG	CHORD
C1	285.00'	35.09'	7°03'15"	N 88°39'50" E	35.07'

**REFERENCES:**  
 P.B. 2022, PGS 594-596

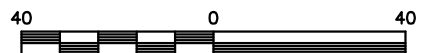

SCALE: 1" = 40'

IMPERVIOUS SURFACES	
HOUSE	1,990 S.F.
WALK & DRIVE	640 S.F.
PORCH	180 S.F.
TOTAL	2,810 S.F.

**NOTES**

1. THIS SURVEY SUBJECT TO ANY FACTS THAT MAY BE DISCLOSED BY A FULL AND ACCURATE TITLE SEARCH.
2. THIS MAP MAY NOT BE A CERTIFIED SURVEY AND HAS NOT BEEN REVIEWED BY A LOCAL GOVERNMENT AGENCY FOR COMPLIANCE WITH ANY APPLICABLE LAND DEVELOPMENT REGULATIONS AND HAS NOT BEEN REVIEWED FOR COMPLIANCE WITH RECORDING REQUIREMENTS FOR PLATS.

PLOT PLAN  
 PRELIMINARY PLAT- NOT FOR RECORDATION,  
 CONVEYANCE OR SALES

REV CODE: 1.FLIP, 2.PLAN, 3.ROTATE, 4.MOVE, 5.SS  
 6.SEVERAL OF ABOVE, 7.LAND FEATURE, 8. OTHER

DATE: AUG. 2, 2023

F.B. \_\_\_\_\_

**RWK, PA**  
**ENGINEERING ~ SURVEYING**  
 CORPORATE LICENSE: C-1771  
 101 W. MAIN ST., SUITE 202  
 GARNER, NC 27529  
 PHONE (919) 779-4854  
 FAX (919) 779-4056