

Central Carolina Soil Consulting, PLLC

1900 South Main Street, Suite 110
Wake Forest, NC 27587
919-569-6704

Acknowledgment of Subsurface wastewater evaluation and septic design by Central Carolina Soil Consulting, PLLC. for Honeycutt Hills S/D, Lot 45, for issuance of an IP and CA.

For Improvement Permit (IP) issuance:

“The LSS/LG evaluation(s) attached to this application is to be used to issue an Improvement Permit in accordance with G.S. 130A-335(a2) and (a3).”

For Construction Authorization (CA) issuance:

“The plans or evaluations attached to this application are to be used to issue a Construction Authorization in accordance with G.S. 130A-335(a2), (a5) and (a6).”

The LSS evaluation attached to this application was used to produce and design a subsurface wastewater septic system for permitting to obtain an IP and CA in accordance G.S. 130A-335(a2), (a3), (a5) and (a6).

Owner: DRB Homes

Owner's representative: KJB

Date: 6.2.23

CONSTRUCTION AUTHORIZATION FOR G.S. 130A-335(a2)/SL2022-11

PIN/Lot Identifier: N/A

Issued To: DRB Homes

Property Location: Honeycutt Hills Subdivision, Lot 45

AOWE/PE Plans/Evaluations Provided: Yes No If yes, name and license number of AOWE/PE: Jason Hall, AOWE #10004E

Facility Type: 4-Bedroom, Single Family

New Expansion Repair System Relocation

Basement? Yes No Basement Fixtures? Yes No

Type of Wastewater System** Gravity to D-Box, IIIG (Initial) Gravity to D-Box, IIIG (Repair)

Design Daily Flow: 480 GPD Wastewater Strength: domestic high strength industrial process

Session Law 2014-120 Section 53, Engineering Design Utilizing Low-flow Fixtures and Low-flow Technologies? Yes No

Installation Requirements/Conditions

Septic Tank Size: 1000 gallons Total Trench/Bed Length: 320 feet Trench/Bed Spacing: 9 feet on center

Drainfield square footage: 960 Trench/Bed Width: 36 inches LTAR 0.4 gpd/ft²

Soil Cover: 0 inches of additional cover Slope Adjusted Maximum Trench/Bed Depth: 26 inches

Aggregate Depth: _____ inches above pipe _____ inches below pipe _____ inches total

Pump Tank Size (if applicable): _____ gallons Requires more than 1 pump? Yes No

Pump Requirements: _____ ft. TDH vs. _____ GPM Grease Trap Size (if applicable): _____ gallons

Distribution Method: Serial D-Box or Parallel Pressure Manifold(s) LPP Other: _____

Artificial Drainage Required: Yes No If yes, please specify details: _____

Legal Agreements (If the answer is "Yes" to any type of legal agreements, please attach a copy of the agreement.)

Multi-party Agreement Required [.1937(h)]: Yes No

Easement, Right-of-Way, or Encroachment Agreement Required [.1938(j)]: Yes No

Declaration of Restrictive Covenants: Yes No

****if applicable:**
I understand the system type specified is different from the type specified on the application. I accept the specifications of this permit.

Owner/Legal Representative Print Name: Kerry Buckner

Owner/Legal Representative Signature: KJB Date: 6.2.23

Pre-Construction Conference Required: Yes No

Conditions: _____

The construction and installation requirements of Rules .1950, .1952, .1954, .1955, .1956, .1957, .1958, and .1959 are incorporated by reference into this permit and shall be met. Systems shall be installed in accordance with the attached system layout.

AOWE/PE Print Name: Jason Hall

AOWE/PE Signature: J Hall

Date: 05/30/2023

This AOWE/PE submittal is pursuant to and meets the requirements of G.S. 130A-335(a2) and (a5).

See attached site sketch



This Section for Local Health Department Use Only

Initial submittal received: _____ by _____
Date Initials

Permit Number: _____

G.S. 130A-335(a6) states the following: *'If a local health department fails to act on an application for a construction authorization submitted pursuant to subsection (a5) of the section within 10 business days of receipt of a complete application, the local health department shall issue the construction authorization.'*

In accordance with G.S. 130A-335(a5) the construction authorization application is:

Incomplete (If box is checked, information in this section is required.)

The following items are missing: _____

Copies of this were sent to the AOWE/PE and the Owner on _____
Date

State Authorized Agent: _____ Date: _____

Denied (See attached report.)

Copies of this were sent to the AOWE/PE and the Owner on _____
Date

State Authorized Agent: _____ Date: _____

Complete

State Authorized Agent: _____ Date of Issuance: _____

This Construction Authorization is issued pursuant to G.S. 130A-335(a2), (a5), and (a6) using the signed and sealed plans or evaluations attached here. This Construction Authorization is subject to revocation if the site plan, plat, or the intended use changes, or if information submitted in the application was falsified, inaccurate or misleading. The Construction Authorization shall not be affected by a change in ownership of the site. This Construction Authorization is subject to compliance with the provisions of the Laws and Rules for Sewage Treatment and Disposal and to the conditions of this permit. The location and identification of all property lines, easements, water lines, and other appropriate utilities shall be the responsibility of the owner. Final landscaping shall be constructed to divert water and establish vegetative cover.

The Department, the Department's authorized agents, and the local health departments shall be discharged and released from any liabilities, duties, and responsibilities imposed by statute or in common law from any claim arising out of or attributed to plans, evaluations, preconstruction conference findings, submittals, or actions from a person licensed pursuant to Chapter 89C of the General Statutes as a licensed engineer or a person certified pursuant to Article 5 of Chapter 90A of the General Statutes as an Authorized On-Site Wastewater Evaluator in GS 130A-335(a2), (a5), and (a7). The Department, the Department's authorized agents, and the local health departments shall be responsible and bear liability for their actions and evaluations and other obligations under State law or rule, including the issuance of the operations permit pursuant to GS 130A-337.

Construction Authorization Expiration Date: _____

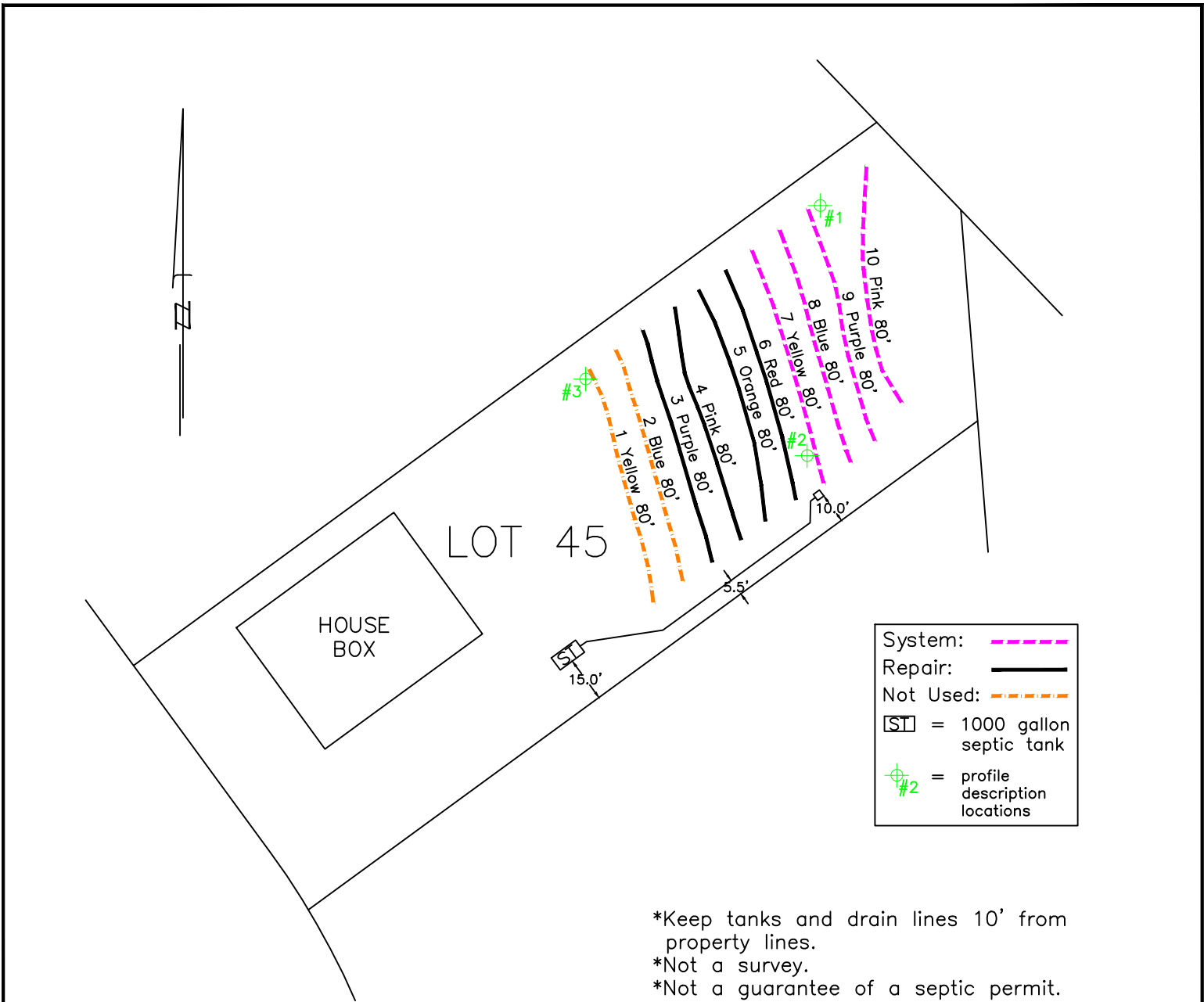

System: Repair: Not Used:

= 1000 gallon septic tank

= profile description locations

- *Keep tanks and drain lines 10' from property lines.
- *Not a survey.
- *Not a guarantee of a septic permit.
- *Keep supply lines >5' from property lines.
- *Some lines are flagged longer in the field than lengths indicate.
- *No grading septic area.
- *No adding soil within septic area
- *No rutting-up septic area
- *No cuts of >2' within 15' of septic areas

<p>System: Gravity to D-Box Lines: 7-10, (320') Accepted Status System 0.4 Soil LTAR 26" Trench Bottom</p>
<p>Repair: Gravity to D-Box Lines: 3-6, (320') Accepted Status System 0.4 Soil LTAR 26" Trench Bottom</p>

GRAPHIC SCALE
 1" = 50'



Central Carolina Soil Consulting, PLLC
 1900 South Main Street, Suite 110
 Wake Forest, North Carolina 27587
 Phone (919)569-6704 Fax (919)569-6703

4-Bedroom Septic Layout
 Lot 45, Honeycutt Hills Subdivision
 Harnett County, North Carolina

Job#: 3806
Drawn By: JR
Date: 05/30/2023
Revision:

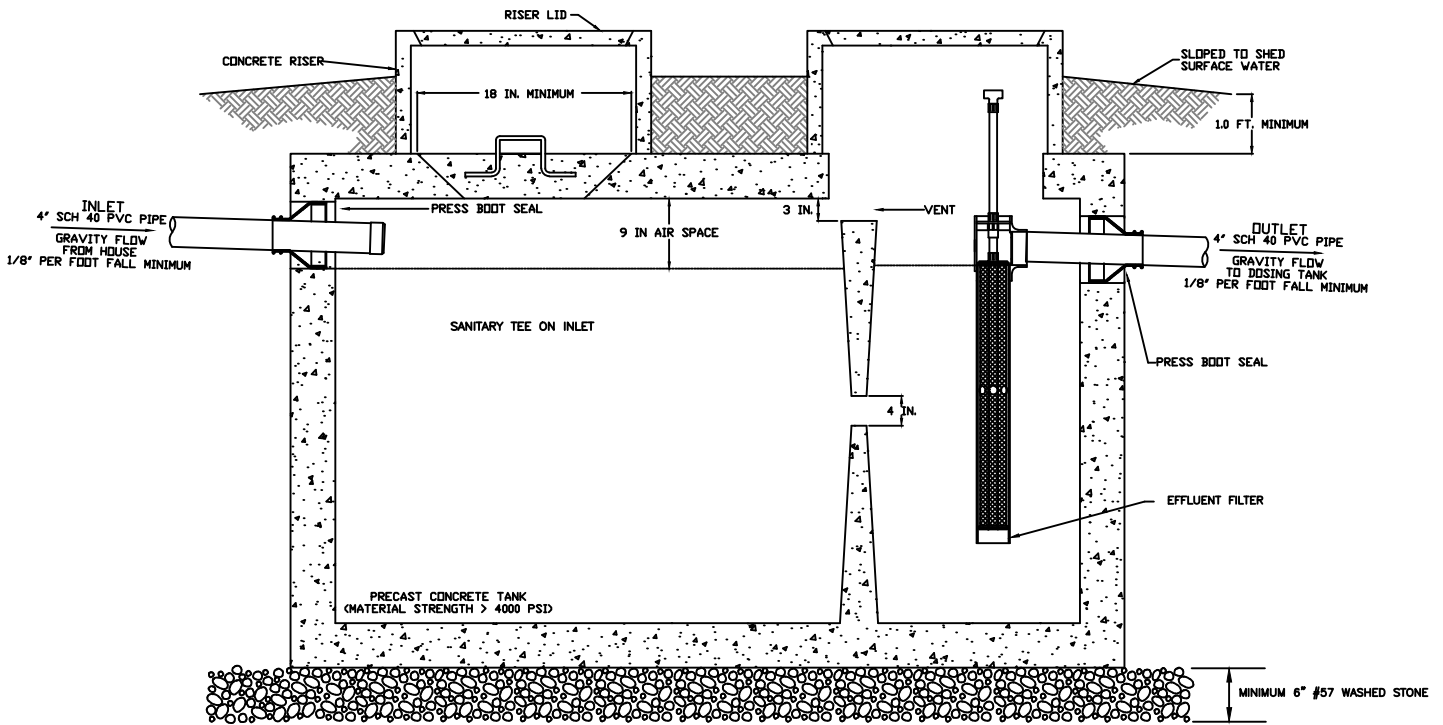

1000 GAL SEPTIC TANK SCHEMATIC
NOT TO SCALE

NOTES

1. ALL TANKS SHALL BE LEAK TESTED SUCH THAT EXFILTRATION OCCURS AT A RATE WHICH DOES NOT EXCEED TEN GALLONS PER TWENTY-FOUR HOURS PER 1,000 GALLONS OF TANK CAPACITY
2. ALL TANKS SHALL REST ON A BED OF #57 WASHED GRAVEL. THE MINIMUM THICKNESS OF THE GRAVEL BED IS 6 INCHES.
3. ALL TANKS MUST BE APPROVED FOR USE BY THE NORTH CAROLINA DEPARTMENT OF ENVIRONMENTAL HEALTH (DEH).
4. INVERTS SHOWN ARE APPROXIMATE. THE INSTALLER SHALL FIELD CONFIRM PRIOR TO CONSTRUCTION.
5. ALL HARDWARE INSTALLED INSIDE OF TANKS SHALL BE OF STAINLESS STEEL.
6. TANK DIMENSIONS VARY BY MANUFACTURER.
7. DRAWDOWN WILL VARY WITH TANK DIMENSIONS.
8. NO ELECTRICAL SPLICES SHALL BE MADE INSIDE THE PUMP TANK.



Central Carolina Soil Consulting, PLLC
1900 South Main Street, Suite 110
Wake Forest, North Carolina 27587
Phone (919)569-6704 Fax (919)569-6703

Septic Tank Details
Honeycutt Hills S/D, Lot 45
Harnett County, North Carolina

Job#: 3806
Drawn By: JR
Date: 05/30/2023

PL-68 Filter and Tee

PL-68 is much more than just an effluent filter. The housing can also be used as an inlet baffle (tee) or an outlet baffle. The housing is designed to accept Polylok's snap in gas deflector to deflect gas bubbles away from the tee and to keep the solids in the tank.

Features:

- Offers 68 linear feet of 1/16" filter slots, which significantly extends time between cleaning.
- Accepts 3/4" PVC handle.
- Locks in any 360° position when used with PL-68 Tee.
- PL-68 Housing can be used as an inlet or outlet tee.
- Gasket prevents bypass.

PL-68 Installation:

Ideal for residential waste flows up to 800 gallons per day (GPD). Easily installs in any new or existing 4" outlet tee.

1. Locate the outlet of the septic tank.
2. Remove the tank cover and pump tank if necessary.
3. Glue the filter housing to the outlet pipe, or use a Polylok Extend & Lok if not enough pipe exists.
4. Insert the PL-68 filter into tee.
5. Replace and secure the septic tank cover.

PL-68 Maintenance:

The PL-68 Effluent Filter will operate efficiently for several years under normal conditions before requiring cleaning. It is recommended that the filter be cleaned every time the tank is pumped, or at least every three years.

1. Do not use plumbing when filter is removed.
2. Pull PL-68 out of the tee.
3. Hose off filter over the septic tank. Make sure all solids fall back into septic tank.
4. Insert filter back into tee/housing.

Related Products:

PL-68 Filter Concrete Baffle
 Extend & Lok™

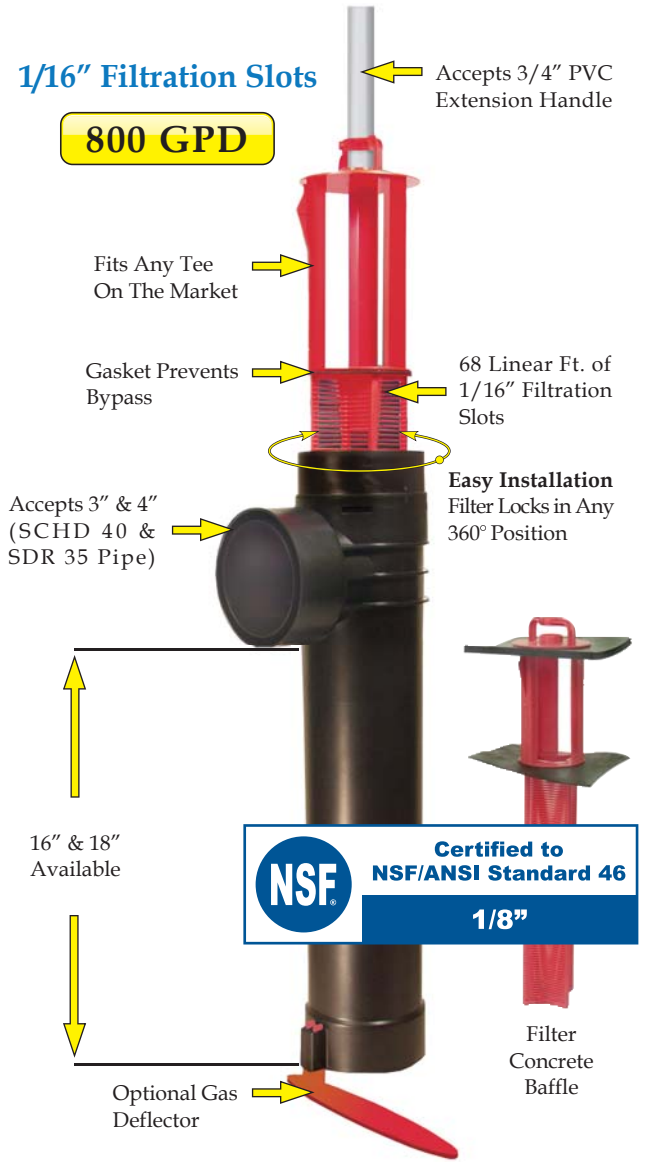

Extend & Lok™
 Easily installs into existing tanks.



Spacer Bushing
 4" SCHD 40 to SDR 35



Spacer Bushing
 4" SCHD 40 to 110mm Pipe



2" Extender