

# Harnett County Department of Public Health

PERMIT # SPD 2307-0627

## Operation Permit

New Installation  Septic Tank  Nitrification Line  Repair  Expansion

PROPERTY LOCATION: 501417 Bakedown Rd

Name: (owner) NEW HOME INC SUBDIVISION Woodbridge South LOT # 6

System Installer: Deveres Medtew

Basement with plumbing:  Garage  Number of Bedrooms 4

Type of Water Supply:  Community  Public  Well Distance from well \_\_\_\_\_ feet

System Type: 25% REDUCED SYSTEM Type A/B Types V and VI Systems expire in 5 years.

(In accordance with Table V a) EZFLOW Owner must contact Health Department 6 months prior to expiration for permit renewal.

This system has been installed in compliance with applicable North Carolina General Statutes, Rules for Sewage Treatment and Disposal, and all conditions of the Improvement Permit and Construction Authorization.

*\* NBBS Pump Alarm for Final*

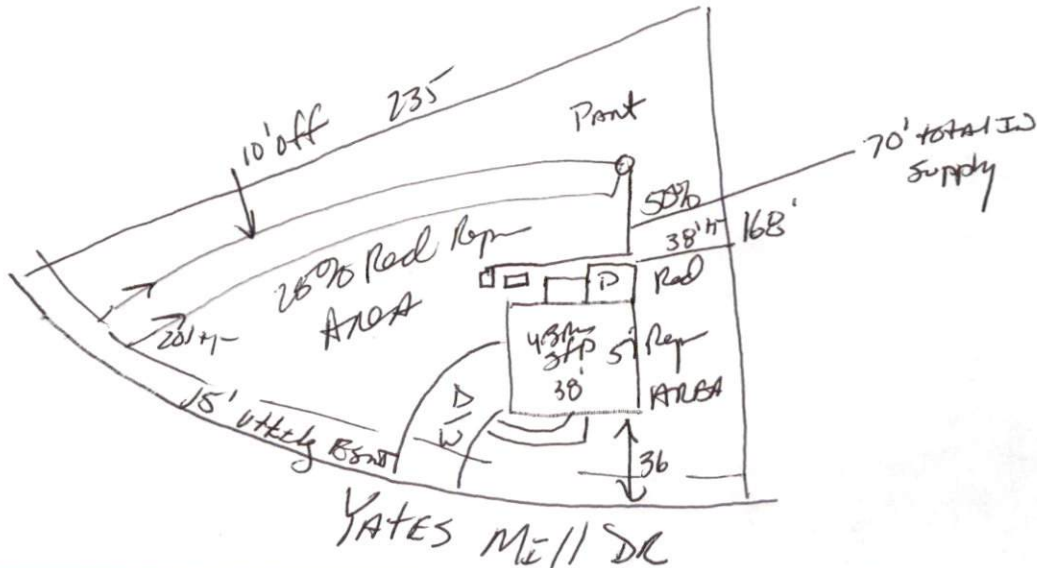

### PERMIT CONDITIONS:

- I. Performance: System shall perform in accordance with Rule .1961.
- II. Monitoring: As required by Rule .1961.
- III. Maintenance: As required by Rule .1961. Other: \_\_\_\_\_  
Subsurface system operator required? Yes  No   
If yes, see attached sheet for additional operation conditions, maintenance and reporting.
- IV. Operation: \_\_\_\_\_
- V. Other: \_\_\_\_\_

D-Box  Pump  Alarm  H2O Line  PWR Line

Following are the specifications for the sewage disposal system on the above captioned property.

Type of system:  Conventional  Other 25% RED Septic Tank: 1000 gallons Pump Tank: 1000 gallons

Subsurface Drainage Field: No. of ditches 2 exact length of each ditch 150 feet width of ditches 3 feet depth of ditches 22 inches

French Drain Required: \_\_\_\_\_ Linear feet

Authorized State Agent [Signature] Date 12/20/23