

NC GRID NORTH  
 NAD 83(2018)  
 Map #2023-266 & 267

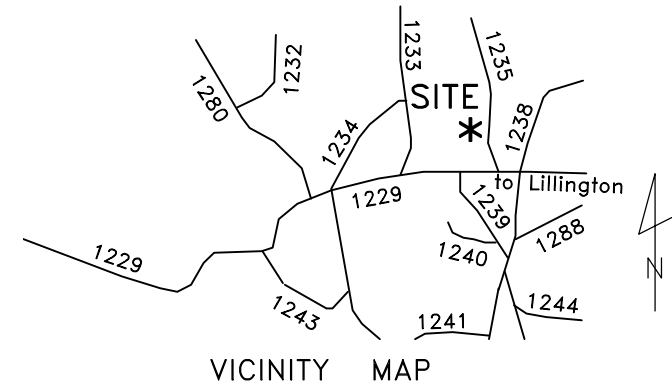

~ 15 Jones Creek Ln., Lillington ~  
 Lot 1, Jones Creek Meadows  
 Map #2023-266 & 267

Plot Plan For:  
**Signature Home Builders Inc.**

Upper Little River Twsp. - Harnett County  
 Scale: 1" = 50' | Date: July 4, 2023

Surveyed & Mapped By  
**STREAMLINE LAND SURVEYING, Inc.**  
 NC FIRM C-1898  
 870 NC 55 W, Coats, N.C. 27521  
 Phone: 910-897-7715

~PRELIMINARY PLOT PLAN~  
 - Not an actual survey-

This plan represents proposed improvements to a lot of record. This plan is subject to review and approval by County Planning and Inspections Departments.  
 REVISED: 7/20/23: Change House Plan

Impervious Surface Limit:  
 9,501 SF per lot  
 Proposed Impervious Surface:  
 House: 2,127 SF  
 + Drive: 1,005 SF  
 TOTAL: 3,132 SF

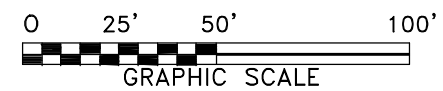

**LEGEND:**

	Subject Lot Boundary Line
	Adjoining Boundary Line
	R/W Right-of-Way Line
	C/L Centerline
	Easement Line
	MBS...Minimum Building Setback
	CP Calculated Point

NOT FOR RECORDATION

DATA\0519\230629SI.dwg (L1-PlotPlan)