

SOIL/SITE EVALUATION
for ON-SITE WASTEWATER SYSTEM

Owner: Charles Deziel
 Applicant: Charles Deziel
 Address: 1283 Moore's Chapel
 Proposed Facility: SFD
 Location of Site:

Date Evaluated: 9-1-23
 Design Flow (.1949): 360 GPD
 Property Size:
 Property Recorded:

Water Supply: Public Individual Well Spring Other
 Evaluation Method: Auger Boring Pit Cut
 Type of Wastewater: Sewage Industrial Process Mixed

P R O F I L E #	.1940 Landscape Position/ Slope %	Horizon Depth (In.)	SOIL MORPHOLOGY .1941		OTHER PROFILE FACTORS				Profile Class & LTAR
			.1941 Structure/ Texture	.1941 Consistence Mineralogy	.1942 Soil Wetness/ Color	.1943 Soil Depth (IN.)	.1956 Sapro Class	.1944 Restr Horiz	
Pit 1	L	0-12	LS	Fr/nspl/xdp	10YR 8/1	>48"	—	—	PS-4
	2-5%	12-48	sc1	Fi/sspl/xdp	≥ 30"				
Pit 2	L	0-14	LS	Fr/nspl/xdp	10YR 8/1	>48"	—	—	PS-4
	2-5%	14-48	sc1	Fi/sspl/xdp	≥ 30"				
Pit 3	L	0-16	LS	Fr/nspl/xdp	10YR 8/1	>48"	—	—	PS-4
	2-5%	16-48	sc1	Fi/sspl/xdp	≥ 31"				

Description	Initial System	Repair System	Other Factors (.1946): Site Classification (.1948): PS Evaluated By: M. Deziel Others Present: A.T.
Available Space (.1945)	✓	✓	
System Type(s)	✓	✓	
Site LTAR	.4	.4	

COMMENTS: _____

LANDSCAPE POSITIONS	GROUP	TEXTURES	.1955 LTAR	CONSISTENCE MOIST	WET
R-RIDGE	I	S-SAND	1.2 - 0.8	VFR-VERY FRIABLE FR-FRIABLE	NS-NON-STICKY SS-SLIGHTLY STICKY
S-SHOULDER SLOPE		LS-LOAMY SAND			
L-LINEAR SLOPE	II	SL-SANDY LOAM	0.8 - 0.6	FI-FIRM VFI-VERY FIRM EFI-EXTREMELY FIRM	S-STICKY VS-VERY STICKY
FS-FOOT SLOPE		L-LOAM			
N-NOSE SLOPE	III	SI-SILT	0.6 - 0.3		NP-NON-PLASTIC SP-SLIGHTLY STICKY P-PLASTIC VP-VERY PLASTIC
H-HEAD SLOPE		SIL-SILT LOAM			
CC-CONCLAVE SLOPE		CL-CLAY LOAM			
CV-CONVEX SLOPE		SCL-SANDY CLAY LOAM			
T-TERRACE	IV	SIC-SILTY CLAY	0.4 - 0.1		
FP-FLOOD PLAN		C-CLAY SC-SANDY CLAY			

STRUCTURE
 SG-SINGLE GRAIN
 M- MASSIVE
 CR-CRUMB
 GR-GRANULAR
 SBK-SUBANGULAR BLOCKY
 ABK-ANGULAR BLOCKY
 PL-PLATY
 PR-PRISMATIC

MINERALOGY
 SLIGHTLY EXPANSIVE
 EXPANSIVE

Show profile locations and other site features (dimensions, references or benchmark, and North)

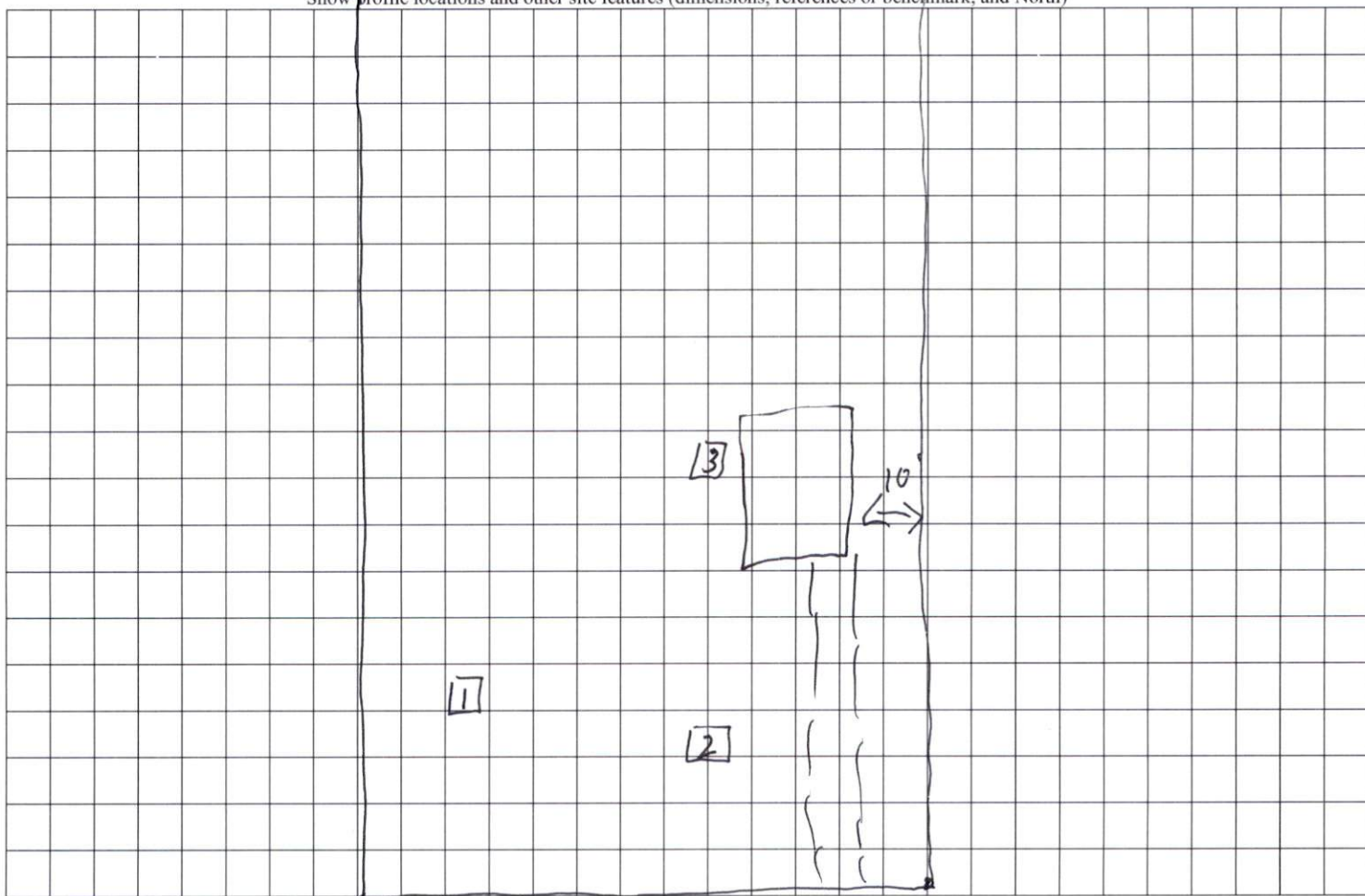

Mooras Chapel