

Harnett County Department of Public Health

PERMIT # SFD 2306-0064

Operation Permit

New Installation Septic Tank Nitrification Line Repair Expansion

PROPERTY LOCATION: 2815 Lemuel Black (SR 1125)

Name: (owner) Onsite Homes SUBDIVISION _____ LOT # _____

System Installer: Yellow Dog

Basement with plumbing: Garage Number of Bedrooms 4 (8 people)

Type of Water Supply: Community Public Well Distance from well _____ feet

System Type: Type III B Types V and VI Systems expire in 5 years.

(In accordance with Table V a)

Owner must contact Health Department 6 months prior to expiration for permit renewal.

This system has been installed in compliance with applicable North Carolina General Statutes, Rules for Sewage Treatment and Disposal, and all conditions of the Improvement Permit and Construction Authorization.

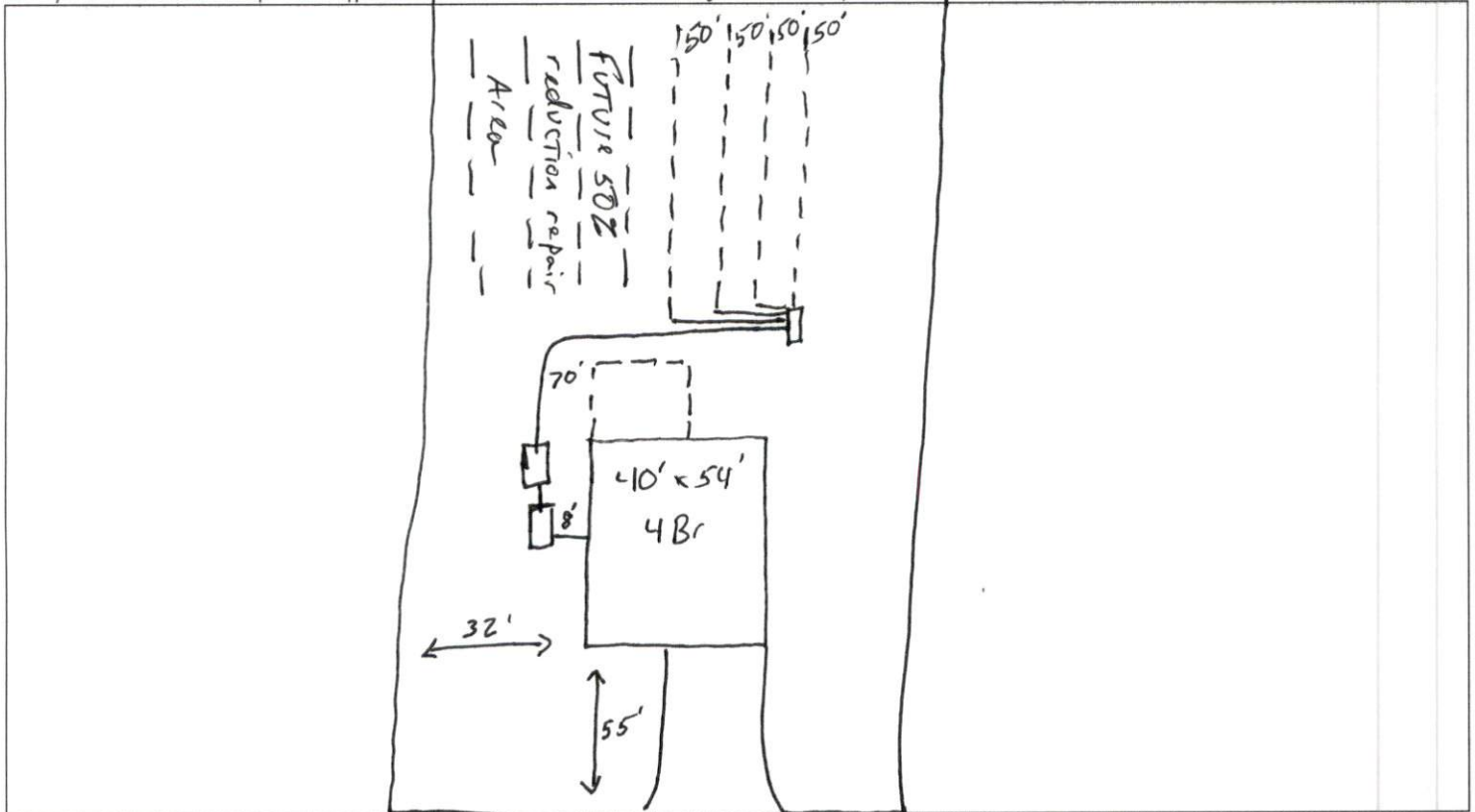

PERMIT CONDITIONS:

- I. Performance: System shall perform in accordance with Rule .1961.
- II. Monitoring: As required by Rule .1961.
- III. Maintenance: As required by Rule .1961. Other: _____
 Subsurface system operator required? Yes No
 If yes, see attached sheet for additional operation conditions, maintenance and reporting.
- IV. Operation: _____
- V. Other: _____

Lemuel Black

D-Box Pump Alarm H2O Line PWR Line

Following are the specifications for the sewage disposal system on the above captioned property.

Type of system: Conventional Other 50% reduction PPBPS Septic Tank: 1000 gallons Pump Tank: 1000 gallons
 Subsurface Drainage Field No. of ditches 4 exact length of each ditch 50 feet width of ditches 3 feet depth of ditches 16 inches
 French Drain Required: _____ Linear feet

Authorized State Agent [Signature] Date 6-12-24