

JFA 2306-0033

**SOIL/SITE EVALUATION
 for ON-SITE WASTEWATER SYSTEM**

Owner: Applicant: NEW HOME INC
 Address: Date Evaluated:
 Proposed Facility: SP Design Flow (.1949): Property Size:
 Location of Site: Property Recorded:
 Water Supply: Public Individual Well Spring Other
 Evaluation Method: Auger Boring Pit Cut
 Type of Wastewater: Sewage Industrial Process Mixed

P R O F I L E #	.1940 Landscape Position/ Slope %	Horizon Depth (In.)	SOIL MORPHOLOGY .1941		OTHER PROFILE FACTORS				Profile Class & LTAR
			.1941 Structure/ Texture	.1941 Consistence Mineralogy	.1942 Soil Wetness/ Color	.1943 Soil Depth (IN.)	.1956 Sapro Class	.1944 Restr Horiz	
1.3	35% L	0-20 0-27	SL SL	FL GUN S.P					PS
		30-39 27-39	SCL SCL	FL SBN S.P	32" ^{1.5} 21 35" 21	39" 1/4			35
3	35% L	0-20 20-30	SL SCLgy	FL GUN S.P FL SBN S.P	26-29 ^{1.5} 21	30" 1/4			3

Description	Initial System	Repair System	Other Factors (.1946):
Available Space (.1945)	<input checked="" type="checkbox"/>	<input checked="" type="checkbox"/>	Site Classification (.1948): PS
System Type(s)	25720	25750%	Evaluated By: (JZ)
Site LTAR	3	3	Others Present:

COMMENTS: _____

LANDSCAPE POSITIONS	GROUP	TEXTURES	.1955 LTAR	CONSISTENCE MOIST	WET
R-RIDGE	I	S-SAND	1.2 - 0.8	VFR-VERY FRIABLE FR-FRIABLE	NS-NON-STICKY SS-SLIGHTLY STICKY
S-SHOULDER SLOPE		LS-LOAMY SAND			
L-LINEAR SLOPE	II	SL-SANDY LOAM	0.8 - 0.6	FI-FIRM VFI-VERY FIRM EFI-EXTREMELY FIRM	S-STICKY VS-VERY STICKY NP-NON-PLASTIC SP-SLIGHTLY STICKY
FS-FOOT SLOPE		L-LOAM			
N-NOSE SLOPE	III	SI-SILT	0.6 - 0.3		P-PLASTIC VP-VERY PLASTIC
H-HEAD SLOPE		SIL-SILT LOAM			
CC-CONCLAVE SLOPE		CL-CLAY LOAM			
CV-CONVEX SLOPE		SCL-SANDY CLAY LOAM			
T-TERRACE	IV	SIC-SILTY CLAY	0.4 - 0.1		
FP-FLOOD PLAN		C-CLAY SC-SANDY CLAY			

STRUCTURE

- SG-SINGLE GRAIN
- M- MASSIVE
- CR-CRUMB
- GR-GRANULAR
- SBK-SUBANGULAR BLOCKY
- ABK-ANGULAR BLOCKY
- PL-PLATY
- PR-PRISMATIC

MINERALOGY

- SLIGHTLY EXPANSIVE
- EXPANSIVE

Show profile locations and other site features (dimensions, references or benchmark, and North)

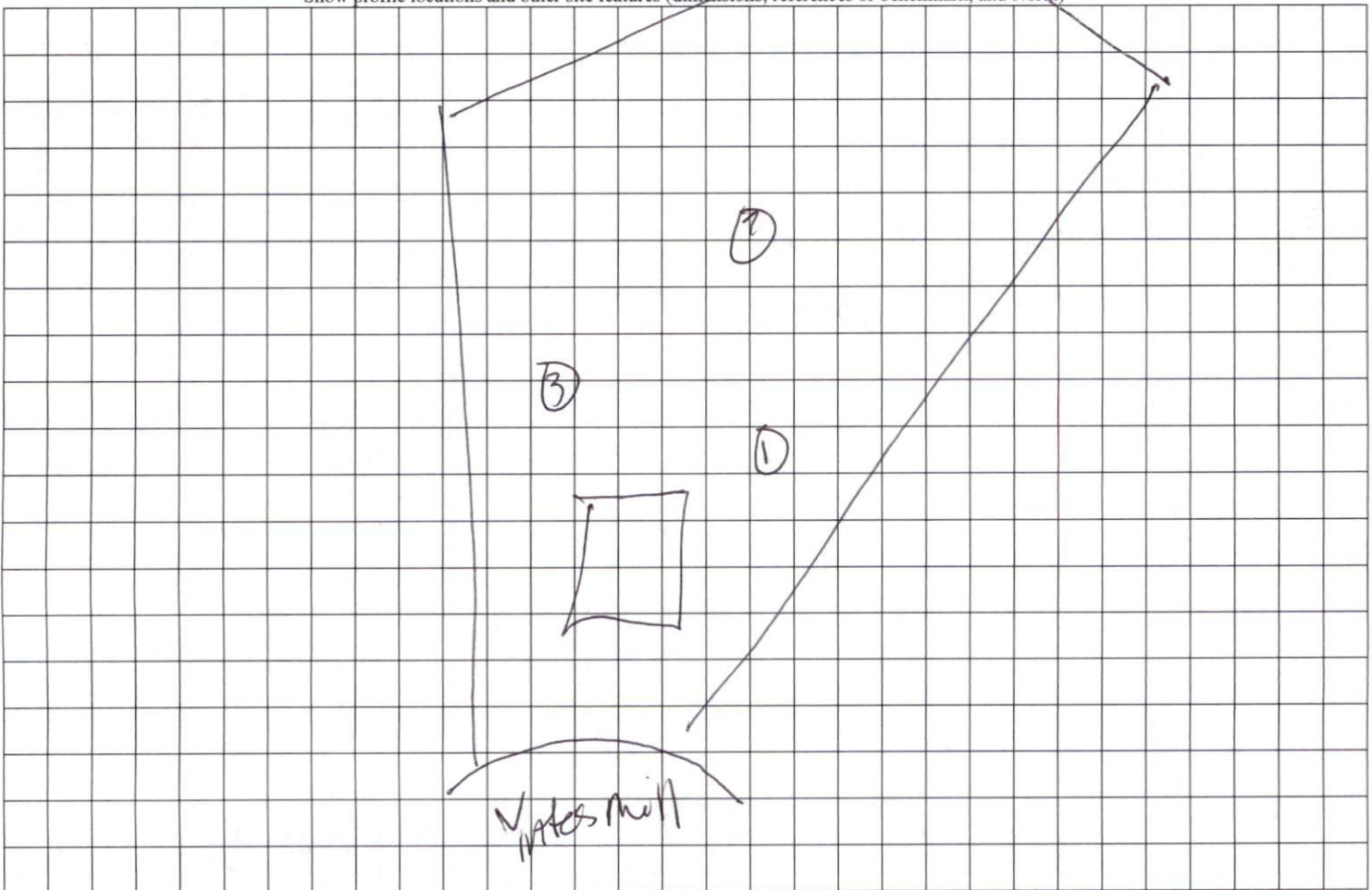

PLOT PLAN FOR
NEW HOME INC., LLC
 370 YATES MILL DRIVE
 LOT 10, WOODBRIDGE SOUTH
 BUCKHORN TOWNSHIP, HARNETT COUNTY, NORTH CAROLINA

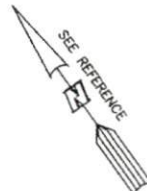

OPEN SPACE

S75°33'24"E 184.31'
 S38°59'21"E 107.73'

SETBACK LINES

10
 49,652 S.F.
 1.140 AC

LEGEND

- ⊠ AIR CONDITIONER
- ⊡ BACK OF CURB
- ⊢ BACK FLOW PREVENTER
- ⊣ CLEANOUT
- ⊤ CURB INLET
- ⊥ DRILL HOLE SET
- ⊦ EXISTING CONCRETE MONUMENT
- ⊧ EXISTING DRILL HOLE
- ⊨ EXISTING IRON STAKE
- ⊩ EXISTING IRON PIPE
- ⊪ ELECTRIC METER
- ⊫ EXISTING PK NAIL
- ⊬ ELECTRIC STUB
- ⊭ FLARED END SECTION
- ⊮ FIRE HYDRANT
- ⊯ FIBER OPTIC PEDESTAL
- ⊰ GAS METER
- ⊱ GUY
- ⊲ INVERT
- ⊳ IRON PIPE SET
- ⊴ IRON ROD SET
- ⊵ LIGHT POLE
- ⊶ MAGNETIC NAIL SET
- ⊷ MANHOLE SANITARY SEWER
- ⊸ MANHOLE STORM SEWER
- ⊹ OVERHEAD WIRES
- ⊺ PK NAIL SET
- ⊻ POINT NOT SET
- ⊼ RAIL ROAD SPIKE
- ⊽ TELEPHONE PEDESTAL
- ⊾ TRANSFORMER
- ⊿ CABLE TV PEDESTAL
- ⊠ UTILITY POLE
- ⊡ WATER METER
- ⊢ WATER VALVE
- ⊣ YARD INLET
- ⊤ FIELD MEASUREMENT

1 0-30 52
 30-30 survey
 52' GDA

2 L-0-20 20
 20-30 30 SURV
 20-20
 20-20

3- (3-5) 0-27 SL
 21-35 SL 11A
 35' 11"

20' PRIVATE DRAINAGE EASEMENT
 N24°28'41"E 272.45'

15' UTILITY EASEMENT

SEE INSET

YATES MILL DRIVE
 50' PUBLIC R/W & UTILITY EASEMENT

CURVE	RADIUS	ARC LENGTH	CHORD LENGTH	CHORD BEARING	DELTA ANGLE
C1	50.00	40.84	39.71	S55°15'21" E	46°47'39"

IMPERVIOUS SURFACES	
HOUSE	1,700 S.F.
WALK & DRIVE	750 S.F.
PORCH	150 S.F.
TOTAL	2,600 S.F.
MAX. IMPERVIOUS	4,000 S.F.

SETBACK INFO

FRONT: 35'
 REAR: 25'
 SIDES: 10'
 CORNER SIDE: 20'

REFERENCES:

P.B. 2023, PGS 92-94

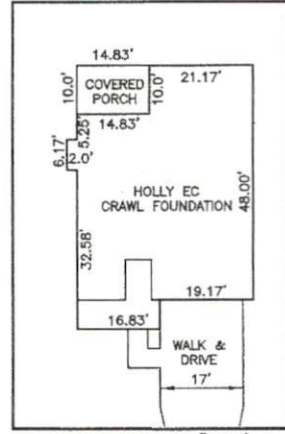

INSET: SCALE: 1" = 30'



SCALE: 1" = 50'

NOTES

- THIS SURVEY SUBJECT TO ANY FACTS THAT MAY BE DISCLOSED BY A FULL AND ACCURATE TITLE SEARCH.
- THIS MAP MAY NOT BE A CERTIFIED SURVEY AND HAS NOT BEEN REVIEWED BY A LOCAL GOVERNMENT AGENCY FOR COMPLIANCE WITH ANY APPLICABLE LAND DEVELOPMENT REGULATIONS AND HAS NOT BEEN REVIEWED FOR COMPLIANCE WITH RECORDING REQUIREMENTS FOR PLATS.

PLOT PLAN
 PRELIMINARY PLAT- NOT FOR RECORDATION,
 CONVEYANCE OR SALES

REV CODE: 1.FJP, 2.PLAN, 3.ROTATE, 4.MOVE, 5.SS
 6.SEVERAL OF ABOVE, 7.LAND FEATURE, 8. OTHER

REV2: JUNE 2, 2023(8)
 REV1: MAY 31, 2023(6)
 DATE: MAY 25, 2023

F.B. _____

RWK, PA
 ENGINEERING - SURVEYING
 CORPORATE LICENSE: C-1771
 101 W. MAIN ST., SUITE 202
 GARNER, NC 27529
 PHONE (919) 779-4854
 FAX (919) 779-4056