

Harnett County Department of Public Health

PERMIT # SPD 2306-0022

Operation Permit

New Installation Septic Tank Nitrification Line Repair Expansion

PROPERTY LOCATION: SR 1707 Newkirk RD

Name: (owner) Joshua + Chelsea Lee SUBDIVISION _____ LOT # _____

System Installer: Genes Backhoe

Basement with plumbing: Garage Number of Bedrooms 4

Type of Water Supply: Community Public Well Distance from well _____ feet

System Type: 25% REDUCTION System Type VI G Types V and VI Systems expire in 5 years.

(In accordance with Table V a)

Owner must contact Health Department 6 months prior to expiration for permit renewal.
EZ Flow

This system has been installed in compliance with applicable North Carolina General Statutes, Rules for Sewage Treatment and Disposal, and all conditions of the Improvement Permit and Construction Authorization.

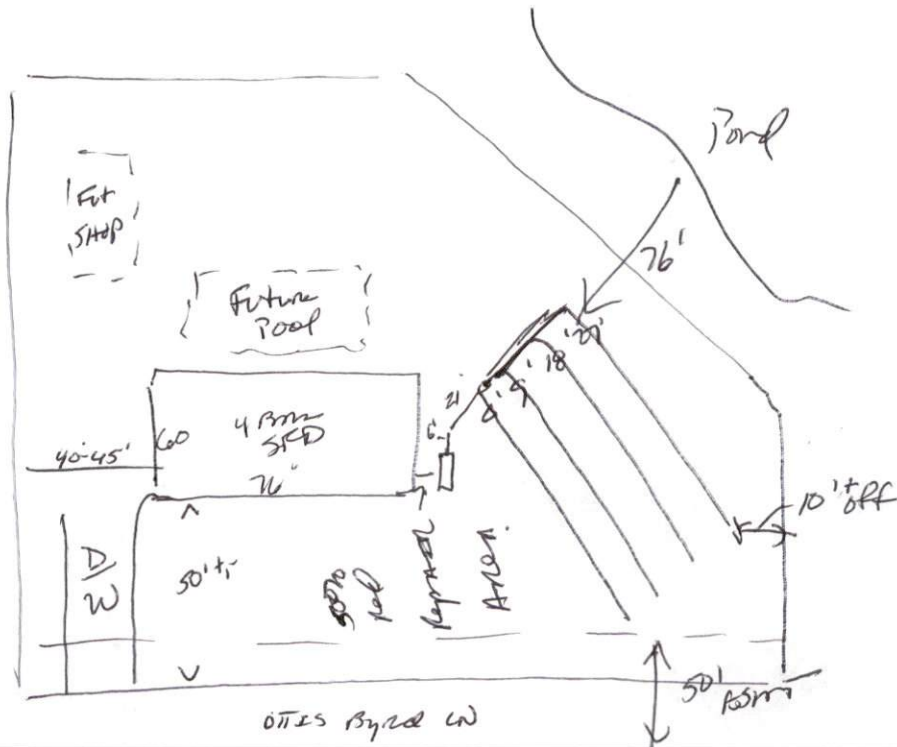

PERMIT CONDITIONS:

I. Performance: System shall perform in accordance with Rule .1961.

II. Monitoring: As required by Rule .1961.

III. Maintenance: As required by Rule .1961. Other: _____

Subsurface system operator required? Yes No

If yes, see attached sheet for additional operation conditions, maintenance and reporting.

IV. Operation: _____

V. Other: _____

D-Box Pump Alarm H2O Line PWR Line

Following are the specifications for the sewage disposal system on the above captioned property.

Type of system: Conventional Other 25% REDUCTION Septic Tank: 1000 gallons Pump Tank: _____ gallons

Subsurface Drainage Field No. of ditches 4 exact length of each ditch 100 feet width of ditches 3 feet depth of ditches 18 inches

French Drain Required: _____ Linear feet

Authorized State Agent James E. Manhart Date 12-19-23