

**SOIL/SITE EVALUATION  
 for ON-SITE WASTEWATER SYSTEM**

Owner: New Home Applicant:

Address:  
 Proposed Facility:  
 Location of Site:

Date Evaluated: 6-23-23/8-3-23  
 Design Flow (.1949):  
 Property Recorded:

Property Size:  
 Public  Individual  Well  Spring  Other

Water Supply:  
 Evaluation Method:  Auger Boring  Pit  Cut  
 Type of Wastewater:  Sewage  Industrial Process  Mixed

Lot 120

P R O F I L E #	.1940 Landscape Position/ Slope %	Horizon Depth (In.)	SOIL MORPHOLOGY		OTHER PROFILE FACTORS				Profile Class & LTAR
			.1941		.1942 Soil Wetness/ Color	.1943 Soil Depth (IN.)	.1956 Sapro Class	.1944 Restr Horiz	
			.1941 Structure/ Texture	.1941 Consistence Mineralogy					
1	<del>L</del> L	0-34	LS Gr	Fr/MS/MP/MP	> 54"	> 54"	-	-	PS-6
	5-7%	34-54	SC1 SBK	Fi/Ss/Sp/Sp					
2	L	0-32	LS Gr	Fr/MS/MP/MP					
	5-7%	32-48	SC1 SBK	Fi/Ss/Sp/Sp	> 48"				PS-6
<u>8-3-23</u> 3	L	0-18	LS Gr	Fr/MS/MP	> 48"	> 48"	-	-	PS-5
	5-7%	18-48	SC1 SBK	Fi/Ss/Sp/Sp					

Description	Initial System	Repair System	Other Factors (.1946):
Available Space (.1945)	✓	✓	Site Classification (.1948): PS
System Type(s)	✓	✓	Evaluated By: <u>M. Schmitt-Rett</u>
Site LTAR	.5	.5	Others Present: A-T

COMMENTS: \_\_\_\_\_

LANDSCAPE POSITIONS	GROUP	TEXTURES	.1955 LTAR	CONSISTENCE MOIST	WET
R-RIDGE	I	S-SAND	1.2 - 0.8	VFR-VERY FRIABLE	NS-NON-STICKY
S-SHOULDER SLOPE		LS-LOAMY SAND		FR-FRIABLE	SS-SLIGHTLY STICKY
L-LINEAR SLOPE	II	SL-SANDY LOAM	0.8 - 0.6	FI-FIRM	S-STICKY
FS-FOOT SLOPE		L-LOAM		VFI-VERY FIRM	VS-VERY STICKY
N-NOSE SLOPE				EFI-EXTREMELY FIRM	NP-NON-PLASTIC
H-HEAD SLOPE	III	SI-SILT	0.6 - 0.3		SP-SLIGHTLY STICKY
CC-CONCLAVE SLOPE		SIL-SILT LOAM			P-PLASTIC
CV-CONVEX SLOPE		CL-CLAY LOAM			VP-VERY PLASTIC
T-TERRACE		SCL-SANDY CLAY LOAM			
FP-FLOOD PLAN	IV	SIC-SILTY CLAY	0.4 - 0.1		
		C-CLAY			
		SC-SANDY CLAY			

STRUCTURE

- SG-SINGLE GRAIN
- M-MASSIVE
- CR-CRUMB
- GR-GRANULAR
- SBK-SUBANGULAR BLOCKY
- ABK-ANGULAR BLOCKY
- PL-PLATY
- PR-PRISMATIC

MINERALOGY

- SLIGHTLY EXPANSIVE
- EXPANSIVE

Show profile locations and other site features (dimensions, references or benchmark, and North)

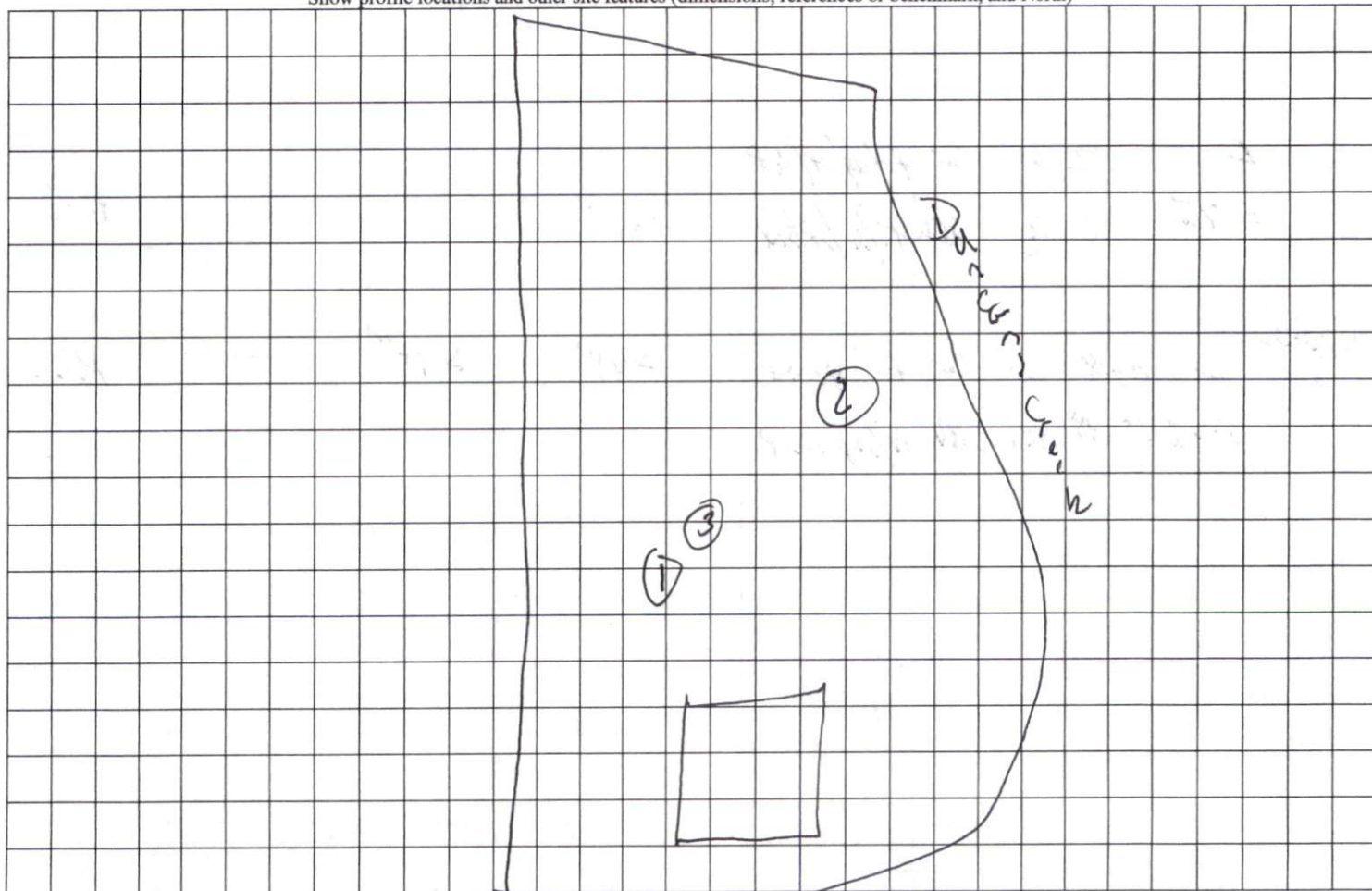

Beacon Hill