



ECS Southeast, LLP

6151 Raeford Road, Suite A
Fayetteville, NC 28304
9104013288
9103230539

LETTER OF TRANSMITTAL

August 1, 2023
Precision Custom Homes

Raeford, NC 28376
ATTN: Shaun Gardner

RE: **Liberty Meadows Lot 26**
ECS Job # **33:6442-G**

Permits:
Location: **141 Sears Dr**
Cameron, NC 28326

	<input checked="" type="checkbox"/>	Field Reports	<input checked="" type="checkbox"/>	For your use	<input checked="" type="checkbox"/>	As requested
CC:		Precision Custom Homes - Allen Peterson		Precision Custom Homes - Lauren Ceruti		
ENCL:		Field Report # 1		7/31/2023		

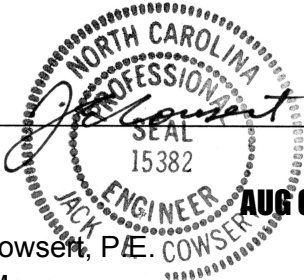

Jack Cowser, P.E.
Office Manager

Aaron Kyle Adair
Team Leader

Disclaimer

1. This report (and any attachments) shall not be reproduced except in full without prior written approval of ECS.
2. The information in this report relates only to the activities performed on the report date.
3. Where appropriate, this report includes statements as to compliance with applicable project drawings, and specifications for the activities, performed on this report date.
4. Incomplete or non-conforming work will be reported for future resolution.
5. The results of samples and/or specimens obtained or prepared for subsequent laboratory testing will be presented in separate reports/documents.



ECS Southeast, LLP
6151 Raeford Road, Suite A
Fayetteville, NC 28304
(910) 401-3288 [Phone]
(910) 323-0539 [Fax]

FIELD REPORT

Project **Liberty Meadows Lot 26**
Location **Cameron, NC**
Client **Precision Custom Homes**
Contractor **Precision Custom Homes**

Project No. **33:6442-G**
Report No. **1**
Day & Date **Monday 7/31/2023**
Weather **80 °/ Sunny**
On-Site Time **1.00**
Lab Time **0.00**
Travel Time* **0.00**
Total **1.00**
Re Obs Time **0.00**

Remarks

Trip Charges*	Tolls/Parking*	Mileage*	Time of Arrival	Departure
Chargeable Items			12:15P	1:15P

* Travel time and mileage will be billed in accordance with the contract.

Summary of Services Performed (field test data, locations, elevations & depths are estimates) & Individuals Contacted.

ECS arrived on site, as requested, to check the bearing capacity of soils via hand auger/DCP method (ASTM STP-399) for a monolithic slab foundation. Footings have not been excavated. Please see the attached sketch and data sheet for details.

A total of 3 hand auger/DCP evaluations were performed to a depth of approximately 3 feet below the current footing sub grade elevation. Test results indicated that the materials in place (at the locations and elevations tested) did appear to be suitable to support the design bearing capacity 2,000 psf.

ECS will return upon request, to provide additional services.

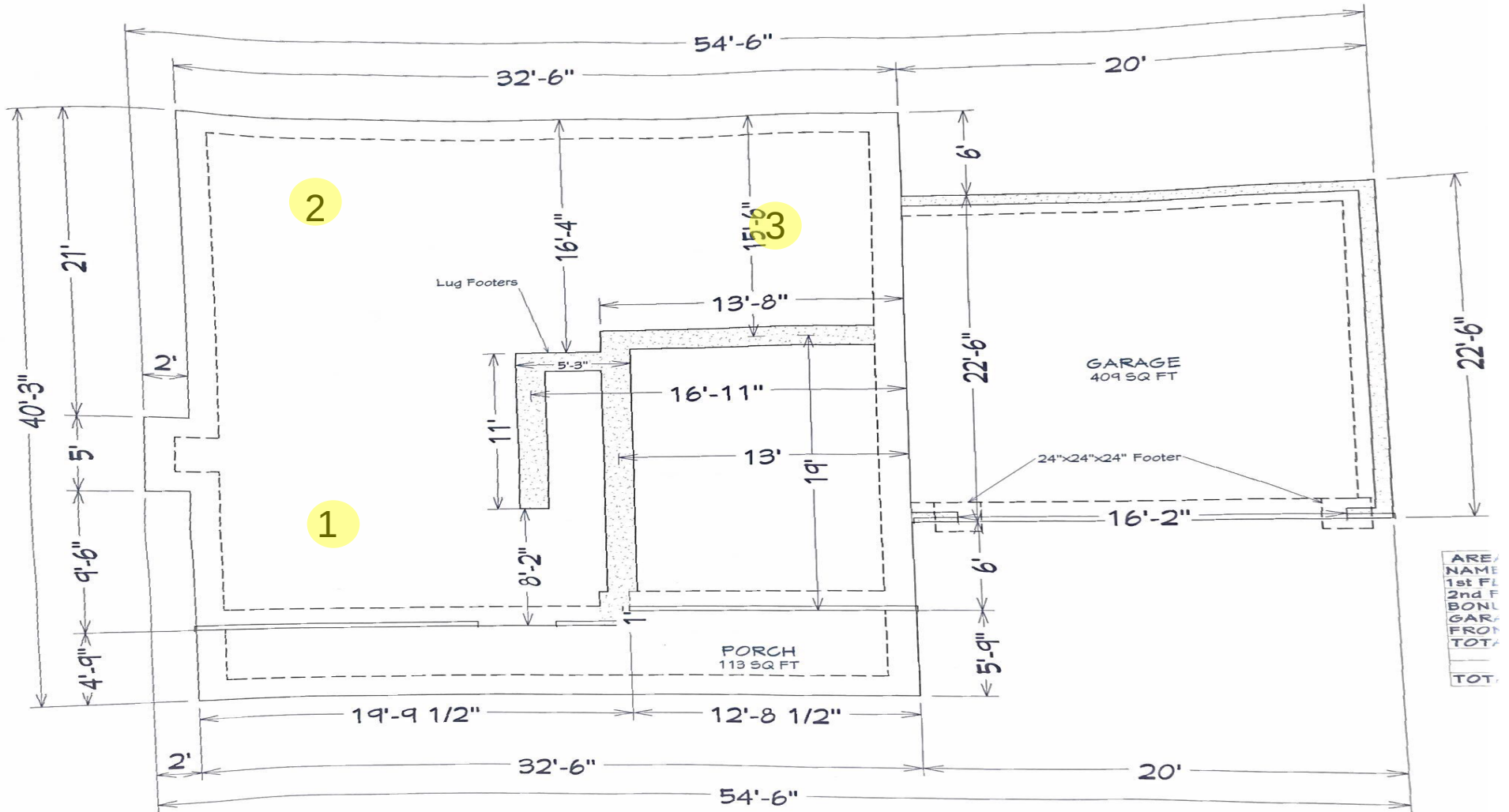

AREA
NAME
1st FL
2nd FL
BONL
GAR
FRON
TOT
TOT

SI Created with ScanWritr. To remove this watermark please use the upgrade options.

Sulaiman Sharieff
 7/31/2023
 Liberty meadows lot 26
 Proj #:6442-G
 W/O # 73393

Key (NTS)
 DCP Location

#



NORTH



Attachments



liberty 26

Figure 1



Report of Spread Footing - Foundation Observations

Project: Liberty Meadows Lot 26
 Location: 141 Sears Dr
Cameron - Moore - NC - 28326
 Contractor: Precision Custom Homes

Project No.: 33:6442-G
 Day/Date: 7/31/2023

Footing Number	Location	Size (W x H x L)		Footing Bottom Elevation		Description of Steel Placed	Description of Subgrade Material	Required Blow Counts	Design Bearing Pressure
		Design	Actual	Design **	Depth of Undercut (in)			# of Blows / Increment	
1	South West	x x	x x	N/A	0,-1,-2,-3		(0,-1) orange clayey sand (-2) brown sand (-3) brown clay	6 (0) 25+ (-1)17-21-22 (-2)22-23-25(-3) 25+	2000
2	North West	x x	x x	N/A	0,-1,-2,-3		(0,-1) orange clayey sand (-2) brown sand (-3) brown clay	6 (0) 25+ (-1)19-23-22 (-2)25+ (-3) 25+	2000
3	North East	x x	x x	N/A	0,-1,-2,-3		(0,-1) orange clayey sand (-2) brown sand (-3) brown clay	6 (0)25+ (-1)17-19-19(-2) 25+ (-3) 23-22-25	2000

** SGE: Subgrade Elevation to be determined by surveyor.

By: Sulaiman Sharieff

ECS Southeast, LLP

WO: 73393