



**ECS Southeast, LLP**

6151 Raeford Road, Suite A  
Fayetteville, NC 28304  
9104013288  
9103230539

**LETTER OF TRANSMITTAL**

August 1, 2023  
Precision Custom Homes

Raeford, NC 28376  
ATTN: Shaun Gardner

RE: **Liberty Meadows Lot 23**  
ECS Job # **33:6442-F**

Permits:  
Location: **100 Sears Dr**  
**Cameron, NC 28326**

Field Reports       For your use       As requested

CC: Precision Custom Homes - Allen Peterson      Precision Custom Homes - Lauren Ceruti

ENCL: Field Report # 1      7/31/2023



**AUG 01 2023**

Jack Cowsert, P.E.  
Office Manager

Aaron Kyle Adair  
Team Leader

*Disclaimer*

1. This report (and any attachments) shall not be reproduced except in full without prior written approval of ECS.
2. The information in this report relates only to the activities performed on the report date.
3. Where appropriate, this report includes statements as to compliance with applicable project drawings, and specifications for the activities, performed on this report date.
4. Incomplete or non-conforming work will be reported for future resolution.
5. The results of samples and/or specimens obtained or prepared for subsequent laboratory testing will be presented in separate reports/documents.



ECS Southeast, LLP  
6151 Raeford Road, Suite A  
Fayetteville, NC 28304  
(910) 401-3288 [Phone]  
(910) 323-0539 [Fax]

## FIELD REPORT

Project **Liberty Meadows Lot 23**  
Location **Cameron, NC**  
Client **Precision Custom Homes**  
Contractor **Precision Custom Homes**

Project No. **33:6442-F**  
Report No. **1**  
Day & Date **Monday 7/31/2023**  
Weather **80 °/ Sunny**  
On-Site Time **1.25**  
Lab Time **0.00**  
Travel Time\* **0.00**  
Total **1.25**  
Re Obs Time **0.00**

Remarks

Trip Charges*	Tolls/Parking*	Mileage*	Time of Arrival	Departure
Chargeable Items			<b>11:00A</b>	<b>12:15P</b>

\* Travel time and mileage will be billed in accordance with the contract.

**Summary of Services Performed (field test data, locations, elevations & depths are estimates) & Individuals Contacted.**

ECS arrived on site, as requested, to check the bearing capacity of soils via hand auger/DCP method (ASTM STP-399) for a monolithic slab foundation. Footings have not been excavated. Please see the attached sketch and data sheet for details.

A total of 3 hand auger/DCP evaluations were performed to a depth of approximately 3 feet below the current footing sub grade elevation. Test results indicated that the materials in place (at the locations and elevations tested) did appear to be suitable to support the design bearing capacity 2,000 psf.

ECS will return upon request, to provide additional services.

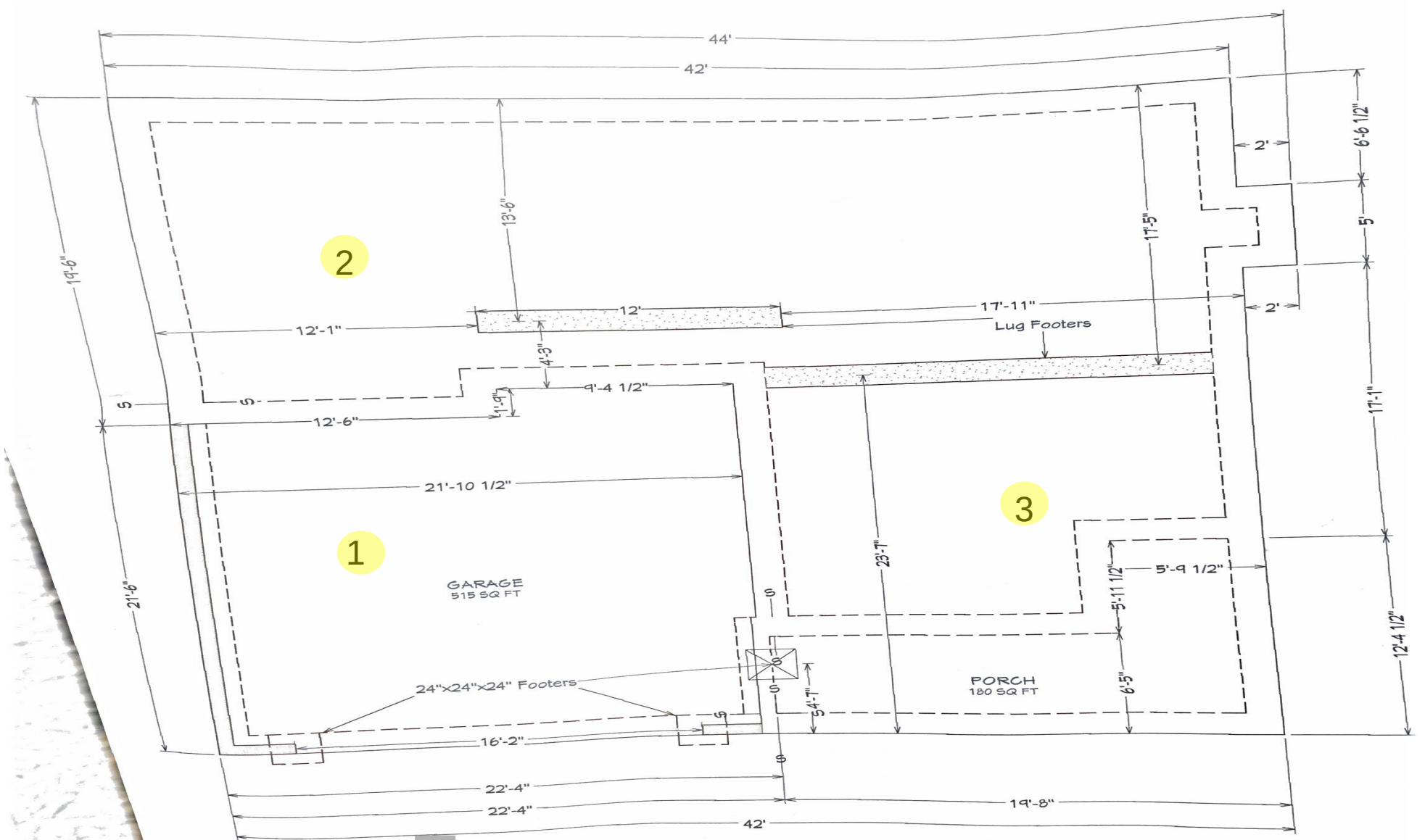

SI Created with ScanWritr. To remove this watermark please use the upgrade options.

Sulaiman Sharieff  
 7/31/2023  
 Liberty meadows lot 23  
 Proj #:6442-F  
 W/O # 73392

**Key (NTS)**  
 DCP Location

#

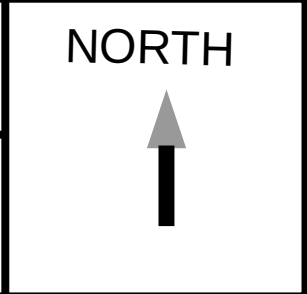

# Attachments



23

Figure 1



## Report of Spread Footing - Foundation Observations

Project: Liberty Meadows Lot 23  
 Location: 100 Sears Dr  
Cameron - Moore - NC - 28326  
 Contractor: Precision Custom Homes

Project No.: 33:6442-F  
 Day/Date: 7/31/2023

Footing Number	Location	Size (W x H x L)		Footing Bottom Elevation		Description of Steel Placed	Description of Subgrade Material	Required Blow Counts	Design Bearing Pressure
		Design	Actual	Design **	Depth of Undercut (in)			# of Blows / Increment	
1	South West	x x	x x	N/A	0,-1,-2,-3		(0)orange sand (-1)tan clay sand (-2,-3) tan sand	6 (0)12-12-15 (-1)15-16-16 (-2)13-12-16 (-3)25+	2000
2	North West	x x	x x	N/A	0,-1,-2,-3		(0)orange sand (-1) tan sand (-2,-3) brown sandy clay	6 (0)9-12-13 (-1)12-12-12 (-2) 25+ (-3)17-15-16	2000
3	South East	x x	x x	N/A	0,-1,-2,-3		(0)orange sand (-1) tan sand (-2,-3) brown sandy clay	6 (0)16-14-14 (-1)25+ (-2) 17-19-19 (-3)25+	2000

\*\* SGE: Subgrade Elevation to be determined by surveyor.

By: Sulaiman Sharieff

ECS Southeast, LLP

WO: 73392