

Harnett County Department of Public Health

Improvement Permit

A building permit cannot be issued with only an Improvement Permit

ISSUED TO: DREAM Finders Homes LLC PROPERTY LOCATION: Hwy 82 LOT # 27
 SUBDIVISION: SCHAABELT CROSSING
 NEW REPAIR EXPANSION
 Type of Structure: 3FD Site Improvements required prior to Construction Authorization Issuance:
 Proposed Wastewater System Type: 25% REDUCTION
 Projected Daily Flow: 480 GPD
 Number of bedrooms: 4 Number of Occupants: 8 max
 Basement Yes No
 Pump Required: Yes No May be required based on final location and elevations of facilities
 Type of Water Supply: Community Public Well Distance from well _____ feet
 Permit valid for: Five years
 No expiration
 Permit conditions: _____

Authorized State Agent: James E. Manhart Date: 6-9-23 SEE ATTACHED SITE SKETCH
 The issuance of this permit by the Health Department in no way guarantees the issuance of other permits. The permit holder is responsible for checking with appropriate governing bodies in meeting their requirements. This site is subject to revocation if the site plan, plat, or the intended use changes. The Improvement Permit shall not be affected by a change in ownership of the site. This permit is subject to compliance with the provisions of the Laws and Rules for Sewage Treatment and Disposal and to conditions of this permit.

Construction Authorization

(Required for Building Permit)

The construction and installation requirements of Rules .1950, .1952, .1954, .1955, .1956, .1957, .1958, and .1959 are incorporated by references into this permit and shall be met. Systems shall be installed in accordance with the attached system layout.

ISSUED TO: DREAM Finders Homes LLC PROPERTY LOCATION: Hwy 82 LOT # 27
 SUBDIVISION: SCHAABELT CROSSING
 Facility Type: 3FD New Expansion Repair
 Basement? Yes No Basement Fixtures? Yes No
 Type of Wastewater System** 25% REDUCTION (Initial) Wastewater Flow: 480 GPD
 (See note below, if applicable) 50% REDUCTION (Repair)

Installation Requirements/Conditions

Septic Tank Size 1000 gallons
Pump Tank Size 1000 gallons

Number of trenches 4
Exact length of each trench 100 feet
Trenches shall be installed on contour at a
Maximum Trench Depth of: 22-28 inches
(Trench bottoms shall be level to $\pm 1/4"$
in all directions)

Trench Spacing: 9 Feet on Center
Soil Cover: 6 inches
(Maximum soil cover shall not exceed
36" above the trench bottom)

Pump Requirements: _____ ft. TDH vs. _____ GPM

Aggregate Depth: _____ inches below pipe
_____ inches above pipe
_____ inches total

Conditions: _____

**WATER LINES (INCLUDING IRRIGATION) MUST BE 10FT. FROM ANY PART OF SEPTIC SYSTEM OR REPAIR AREA.
NO UTILITIES ALLOWED IN INITIAL OR REPAIR DRAIN FIELD AREA.**

**If applicable: I understand the system type specified is different from the type specified on the application. I accept the specifications of this permit.

Owner/Legal Representative Signature: _____ Date: _____

This Construction Authorization is subject to revocation if the site plan, plat, or the intended use changes. The Construction Authorization shall not be transferred when there is a change in ownership of the site. This Construction Authorization is subject to compliance with the provisions of the Laws and Rules for Sewage Treatment and Disposal and to the conditions of this permit. SEE ATTACHED SITE SKETCH

Authorized State Agent: James E. Manhart Date: 6-9-23
Construction Authorization Expiration Date: 6-9-28

Application # SFD 2305-0088

Harnett County Department of Public Health Site Sketch

Property Location: Hwy 82

Issued To: DREAM Finders Homes LLC Subdivision SCHABERT CROSSING Lot # 27

Authorized State Agent: James E. Manhart ID 12315 Date: 6-9-23

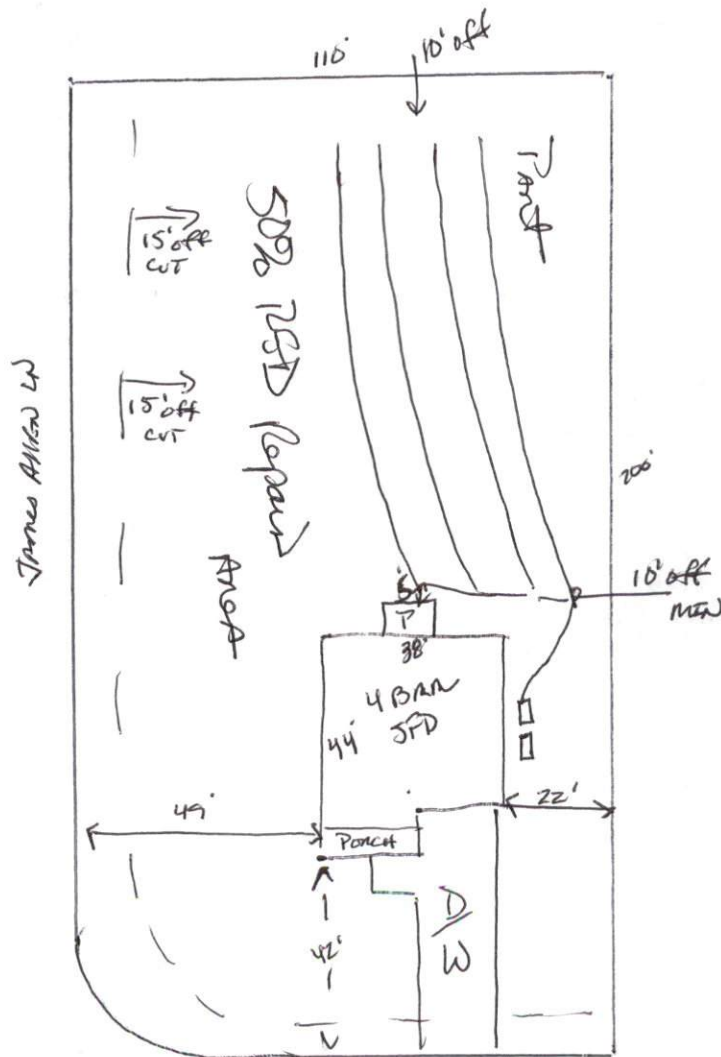

MARY Raymond W

This drawing is for illustrative purposes only. System installation must meet all pertinent laws, rules, and regulations.