

4-Bedroom Septic Plan  
 Lot #15 – Duncan's Crossing  
 Harnett County  
 Smith Douglas Homes

\*House footprint to be field staked by surveyor and system verified prior to any construction

\*\*Septic area must not be altered by construction activities.

\*\*\*No cuts of 2' or greater within 15' of septic area

\*\*\*\* Recommend protective barrier around septic field during construction.

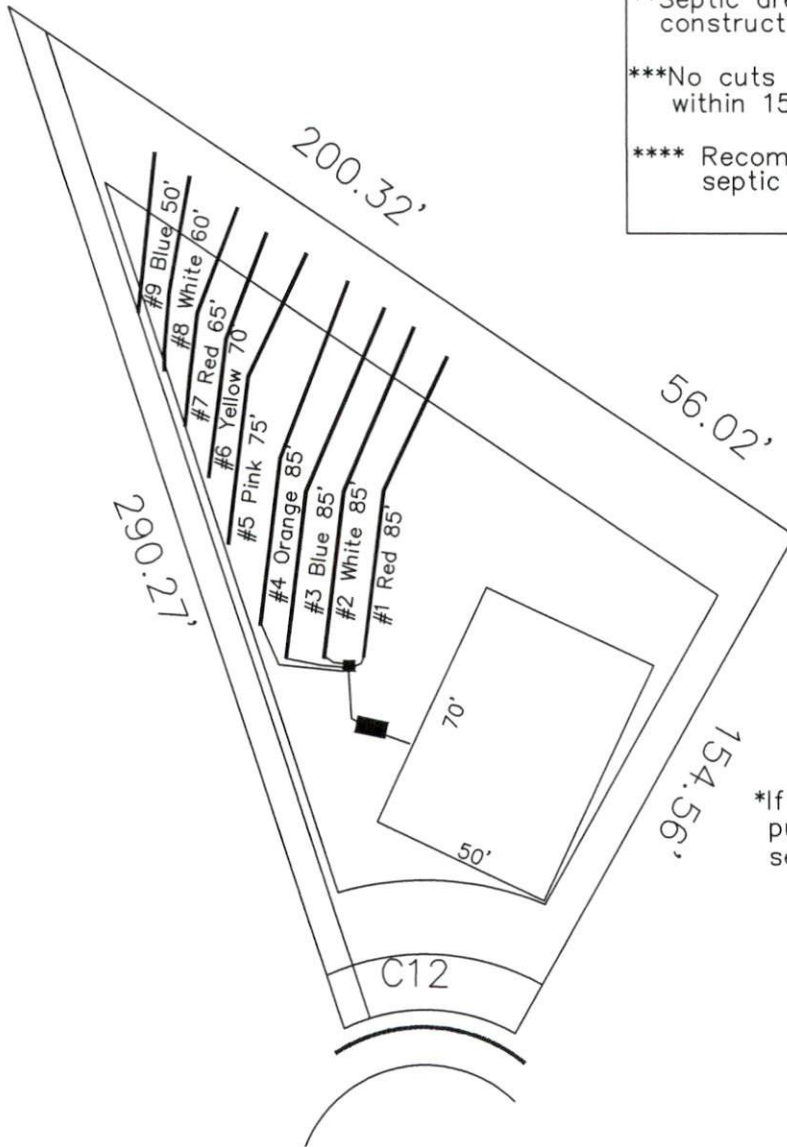

15

25,910 SF  
 (0.59 AC)

\*If plumbing is not sufficient a pump tank will be required to septic field.

System: Gravity to D-Box  
 Lines: Lines 1-4 (340')  
 0.4 LTAR  
 24" Max Trench Bottom  
 Accepted Status System  
 Repair: Pressure Manifold  
 Lines: Lines 5-9 (300')  
 0.35 LTAR  
 24" Trench Bottom  
 Accepted Status System

CLYDE DOG COURT  
 50' R/W (PUBLIC & UTILITY ACCESS)

GRAPHIC SCALE  
 1" = 50'



Adams  
 Soil Consulting  
 919-414-6761  
 Job #1146