

SOIL/SITE EVALUATION
for ON-SITE WASTEWATER SYSTEM

Owner: *New Home*
 Applicant:
 Address: *89 Duncan Creek*
 Proposed Facility: *SFD*
 Location of Site:

Date Evaluated: *5-26-23*
 Design Flow (.1949): *480*
 Property Recorded:

Property Size:

Water Supply: Public Individual Well Spring Other
 Evaluation Method: Auger Boring Pit Cut
 Type of Wastewater: Sewage Industrial Process Mixed

P R O F I L E #	.1940 Landscape Position/ Slope %	Horizon Depth (In.)	SOIL MORPHOLOGY .1941		OTHER PROFILE FACTORS				Profile Class & LTAR	
			.1941 Structure/ Texture	.1941 Consistence Mineralogy	.1942 Soil Wetness/ Color	.1943 Soil Depth (IN.)	.1956 Sapro Class	.1944 Restr Horiz		
1	L	0-22	LS	Gr	<i>Ff/w/s/np/ncp</i>	<i>> 48"</i>	<i>> 48"</i>	-	-	<i>PS.6</i>
	<i>2-5%</i>	22-48	SL	SBK	<i>Ff/s/np/ncp</i>					<i>Group III</i>
2	L	0-24	LS	Gr	<i>Ff/w/s/np/ncp</i>	<i>> 48"</i>	<i>> 48"</i>	-	-	<i>PS.6</i>
	<i>2-5%</i>	24-48	SL	Gr	<i>Ff/s/np/ncp</i>					<i>Group II</i>

Description	Initial System	Repair System	Other Factors (.1946): Site Classification (.1948): <i>PS</i> Evaluated By: Others Present: <i>M. D. REHS</i>
Available Space (.1945)	<i>✓</i>	<i>✓</i>	
System Type(s)	<i>✓</i>	<i>✓</i>	
Site LTAR	<i>.6</i>	<i>.6</i>	

COMMENTS: _____

LANDSCAPE POSITIONS	GROUP	TEXTURES	.1955 LTAR	CONSISTENCE MOIST	WET
R-RIDGE	I	S-SAND	1.2 - 0.8	VFR-VERY FRIABLE FR-FRIABLE	NS-NON-STICKY SS-SLIGHTLY STICKY
S-SHOULDER SLOPE		LS-LOAMY SAND			
L-LINEAR SLOPE	II	SL-SANDY LOAM	0.8 - 0.6	FI-FIRM VFI-VERY FIRM EFI-EXTREMELY FIRM	S-STICKY VS-VERY STICKY
FS-FOOT SLOPE		L-LOAM			
N-NOSE SLOPE	III	SI-SILT	0.6 - 0.3		NP-NON-PLASTIC SP-SLIGHTLY STICKY
H-HEAD SLOPE		SIL-SILT LOAM			
CC-CONCLAVE SLOPE		CL-CLAY LOAM			
CV-CONVEX SLOPE		SCL-SANDY CLAY LOAM			
T-TERRACE	IV	SIC-SILTY CLAY	0.4 - 0.1		P-PLASTIC VP-VERY PLASTIC
FP-FLOOD PLAN		C-CLAY SC-SANDY CLAY			

STRUCTURE
 SG-SINGLE GRAIN
 M-MASSIVE
 CR-CRUMB
 GR-GRANULAR
 SBK-SUBANGULAR BLOCKY
 ABK-ANGULAR BLOCKY
 PL-PLATY
 PR-PRISMATIC

MINERALOGY
 SLIGHTLY EXPANSIVE
 EXPANSIVE

Show profile locations and other site features (dimensions, references or benchmark, and North)

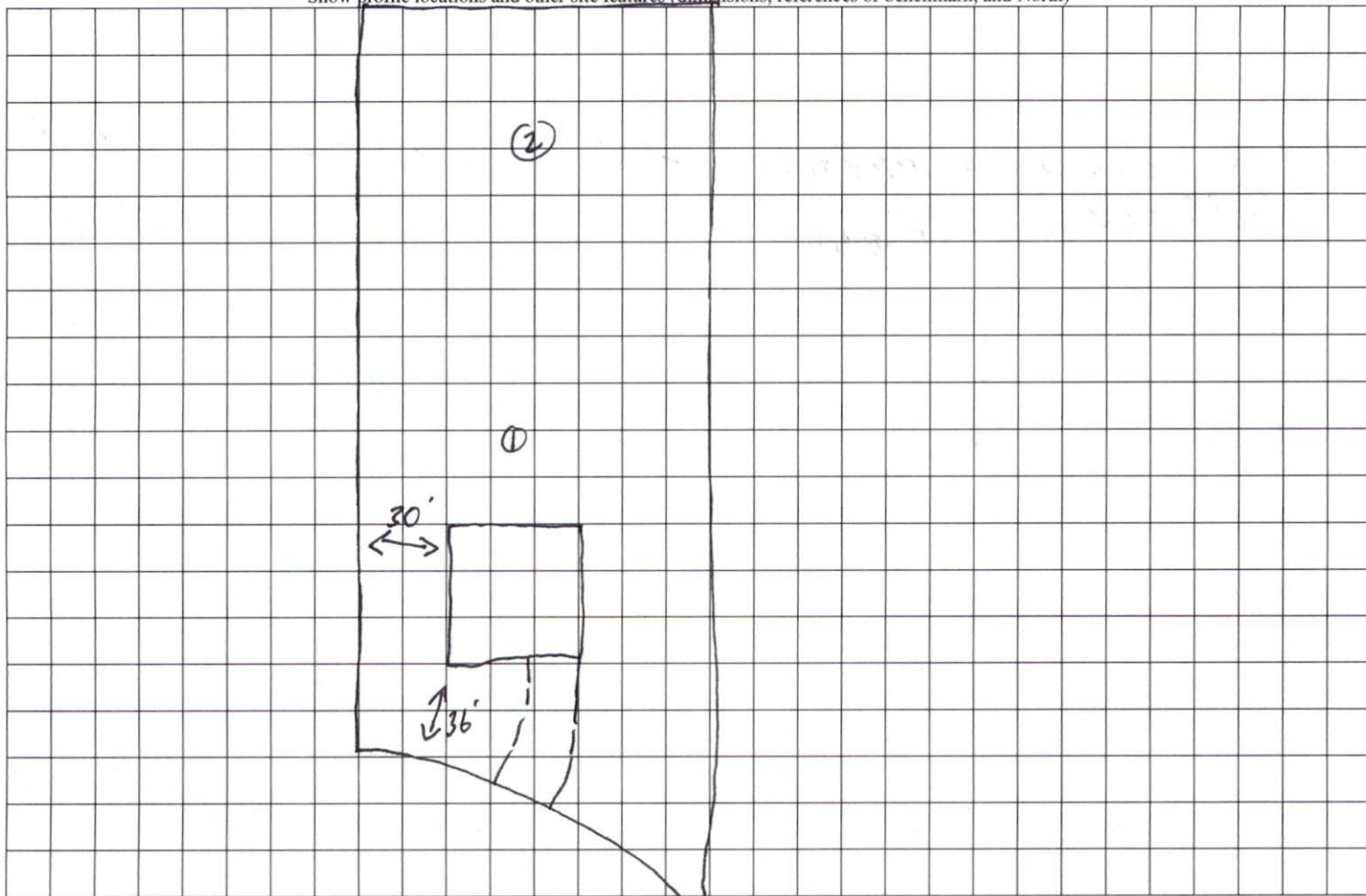

Duncans Rd
creek