

3-Bedroom Septic Plan
 Lot #69 - Duncan's Crossing
 Harnett County
 Smith Douglas Homes

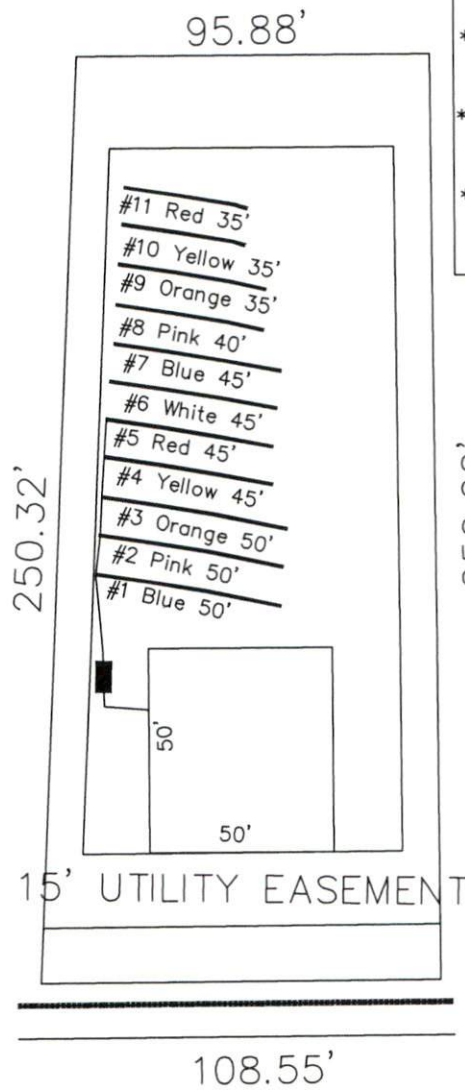

*House footprint to be field staked by surveyor and system verified prior to any construction

**Septic area must not be altered by construction activities.

***No cuts of 2' or greater within within 15' of septic area

**** Recommend protective barrier around septic field during construction.

25,553 SF
 (0.59 AC)

*If plumbing is not sufficient a pump tank will be required to septic field.

System: Gravity to D-Box
 Lines: Lines 1-5 (285')
 0.35 LTAR
 18" Max Trench Bottom
 Accepted Status System
 Repair: Pressure Manifold
 Lines: Lines 6-11 (235')
 0.4 LTAR
 12" Trench Bottom
 Accepted Status System

DOUBLE BARRELL STREET
 50' R/W (PUBLIC & UTILITY ACCESS)

GRAPHIC SCALE
 1" = 50'



Adams
 Soil Consulting
 919-414-6761
 Job #1146