

SOIL/SITE EVALUATION
for ON-SITE WASTEWATER SYSTEM

Owner: *L. Fuentes* Applicant:
 Address: *169 Love Grove Ch* Date Evaluated: *5-8-23*
 Proposed Facility: *SFD* Design Flow (.1949): *360 GPD* Property Size:
 Location of Site: Property Recorded:
 Water Supply: Public Individual Well Spring Other
 Evaluation Method: Auger Boring Pit Cut
 Type of Wastewater: Sewage Industrial Process Mixed

P R O F I L E #	.1940 Landscape Position/ Slope %	Horizon Depth (In.)	SOIL MORPHOLOGY		OTHER PROFILE FACTORS				Profile Class & LTAR	
			.1941		.1942 Soil Wetness/ Color	.1943 Soil Depth (IN.)	.1956 Sapro Class	.1944 Restr Horiz		
			.1941 Structure/ Texture	.1941 Consistence Mineralogy						
1	L	0-2	LS	Gr	Fr/usp/uxp	10YR 8/1				U
	2-5% 2-5%	2-36	SC	ABk	fr/usp/uxp	< 8"				
2	L									
	5-7%	0-13	LS	Gr	Fr/usp/uxp	10YR 8/1				U
		13-40	SC	ABk	fr/usp/uxp	< 12"				
	8-25-23									
3	L	0-10	LS			10YR 6/2				PS. 4
	2-5%	10-48	SC			≥ 34"				
4	L	0-10	LS			10YR 6/2				PS. 4
	2-5%	10-48	SC			≥ 30"				

Description	Initial System	Repair System	Other Factors (.1946): Site Classification (.1948):
Available Space (.1945)	✓	✓	Evaluated By: <i>M. de REHS</i> Others Present: <i>A.T.</i>
System Type(s)	✓	✓	
Site LTAR	.1	.4	

COMMENTS: _____

LANDSCAPE POSITIONS	GROUP	TEXTURES	.1955 LTAR	CONSISTENCE MOIST	WET
R-RIDGE	I	S-SAND	1.2 - 0.8	VFR-VERY FRIABLE FR-FRIABLE	NS-NON-STICKY SS-SLIGHTLY STICKY
S-SHOULDER SLOPE		LS-LOAMY SAND			
L-LINEAR SLOPE	II	SL-SANDY LOAM	0.8 - 0.6	FI-FIRM VFI-VERY FIRM EFI-EXTREMELY FIRM	S-STICKY VS-VERY STICKY NP-NON-PLASTIC SP-SLIGHTLY STICKY
FS-FOOT SLOPE		L-LOAM			
N-NOSE SLOPE	III	SI-SILT	0.6 - 0.3		P-PLASTIC VP-VERY PLASTIC
H-HEAD SLOPE		SIL-SILT LOAM			
CC-CONCLAVE SLOPE		CL-CLAY LOAM			
CV-CONVEX SLOPE		SCL-SANDY CLAY LOAM			
T-TERRACE	IV	SIC-SILTY CLAY	0.4 - 0.1		
FP-FLOOD PLAN		C-CLAY SC-SANDY CLAY			

STRUCTURE
 SG-SINGLE GRAIN
 M-MASSIVE
 CR-CRUMB
 GR-GRANULAR
 SBK-SUBANGULAR BLOCKY
 ABK-ANGULAR BLOCKY
 PL-PLATY
 PR-PRISMATIC

MINERALOGY
 SLIGHTLY EXPANSIVE
 EXPANSIVE

Show profile locations and other site features (dimensions, references or benchmark, and North)

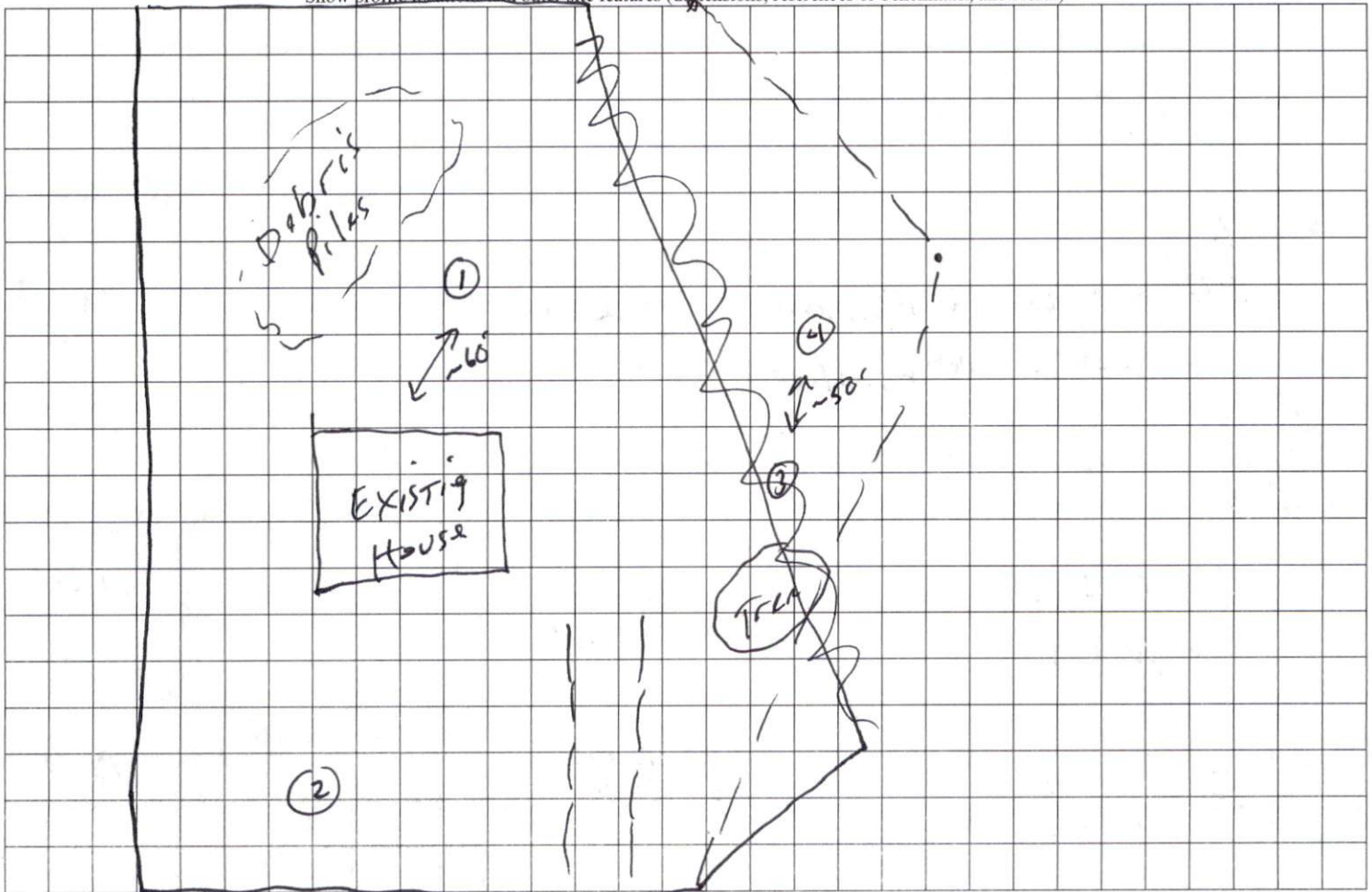

Love Grove ch. Rd