

| Level | | | |
|-------------|---------|--|----------|
| Member Name | Results | Current Solution | Comments |
| BM1-3 | Passed | 3 piece(s) 1 3/4" x 9 1/4" 2.0E Microllam® LVL | |

| ForteWEB Software Operator | Job Notes |
|--|---|
| Steve Farr Carolina Structural Systems (844) 767-1926 sfarr@carolinastructuralsystems.com | 2115423RT1 GARRIS EVANS - DAWSON 6983 US 401 HWY FUQUAY-VARINA, NC 27526 |



10/25/2023 2:39:12 PM UTC

ForteWEB v3.6

File Name: 221543RT1

Level, BM1-3
 3 piece(s) 1 3/4" x 9 1/4" 2.0E Microllam® LVL

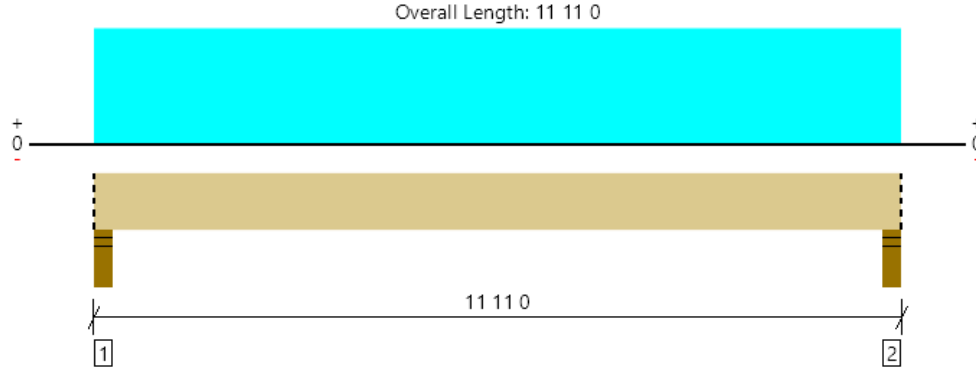

All locations are measured from the outside face of left support (or left cantilever end). All dimensions are horizontal.

| Design Results | Actual @ Location | Allowed | Result | LDF | Load: Combination (Pattern) |
|-----------------------|-------------------|---------------|----------------|------|-----------------------------|
| Member Reaction (lbs) | 4355 @ 0 3 0 | 10041 (4.50") | Passed (43%) | -- | 1.0 D + 1.0 Lr (All Spans) |
| Shear (lbs) | 3517 @ 1 1 12 | 11534 | Passed (30%) | 1.25 | 1.0 D + 1.0 Lr (All Spans) |
| Moment (Ft-lbs) | 11907 @ 5 11 8 | 21007 | Passed (57%) | 1.25 | 1.0 D + 1.0 Lr (All Spans) |
| Live Load Defl. (in) | 0.212 @ 5 11 8 | 0.571 | Passed (L/647) | -- | 1.0 D + 1.0 Lr (All Spans) |
| Total Load Defl. (in) | 0.432 @ 5 11 8 | 0.761 | Passed (L/317) | -- | 1.0 D + 1.0 Lr (All Spans) |

System : Roof
 Member Type : Flush Beam
 Building Use : Residential
 Building Code : IBC 2018
 Design Methodology : ASD
 Member Pitch : 0/12

- Deflection criteria: LL (L/240) and TL (L/180).
- Allowed moment does not reflect the adjustment for the beam stability factor.

| Supports | Bearing Length | | | Loads to Supports (lbs) | | | Accessories |
|---------------------|----------------|-----------|----------|-------------------------|-----------|-------|-------------|
| | Total | Available | Required | Dead | Roof Live | Total | |
| 1 - Stud wall - SPF | 4.50" | 4.50" | 1.95" | 2219 | 2135 | 4354 | Blocking |
| 2 - Stud wall - SPF | 4.50" | 4.50" | 1.95" | 2219 | 2135 | 4354 | Blocking |

- Blocking Panels are assumed to carry no loads applied directly above them and the full load is applied to the member being designed.

| Lateral Bracing | Bracing Intervals | Comments |
|------------------|-------------------|----------|
| Top Edge (Lu) | 11 11 0 o/c | |
| Bottom Edge (Lu) | 11 11 0 o/c | |

- Maximum allowable bracing intervals based on applied load.

| Multiple Member Connections | | | | | | | | |
|-----------------------------|------------------|----------------------------|--|------------|------|------|----------------|---------|
| Type | Location | Fastener | | Placement | Rows | O.C. | # of Fasteners | Details |
| Uniform | 0 0 0 to 11 11 0 | 10d Nail (0.128" x 3") [1] | | Both Faces | 3 | 6" | -- | L17 |

| Vertical Loads | Location (Side) | Tributary Width | Dead (0.90) | Roof Live (non-snow: 1.25) | Comments |
|-----------------------|--------------------------|-----------------|-------------|----------------------------|--------------|
| 0 - Self Weight (PLF) | 0 0 0 to 11 11 0 | N/A | 14.2 | -- | |
| 1 - Uniform (PSF) | 0 0 0 to 11 11 0 (Front) | 17 11 0 | 20.0 | 20.0 | Default Load |

Weyerhaeuser Notes

Weyerhaeuser warrants that the sizing of its products will be in accordance with Weyerhaeuser product design criteria and published design values. Weyerhaeuser expressly disclaims any other warranties related to the software. Use of this software is not intended to circumvent the need for a design professional as determined by the authority having jurisdiction. The designer of record, builder or framer is responsible to assure that this calculation is compatible with the overall project. Accessories (Rim Board, Blocking Panels and Squash Blocks) are not designed by this software. Products manufactured at Weyerhaeuser facilities are third-party certified to sustainable forestry standards. Weyerhaeuser Engineered Lumber Products have been evaluated by ICC-ES under evaluation reports ESR-1153 and ESR-1387 and/or tested in accordance with applicable ASTM standards. For current code evaluation reports, Weyerhaeuser product literature and installation details refer to www.weyerhaeuser.com/woodproducts/document-library.
 The product application, input design loads, dimensions and support information have been provided by ForteWEB Software Operator

| ForteWEB Software Operator | Job Notes |
|--|---|
| Steve Farr Carolina Structural Systems (844) 767-1926 sfarr@carolinastructuralsystems.com | 2115423RT1 GARRIS EVANS - DAWSON 6983 US 401 HWY FUQUAY-VARINA, NC 27526 |

