

Harnett County Department of Public Health

Improvement Permit

A building permit cannot be issued with only an Improvement Permit

ISSUED TO: Watermark Homes INC PROPERTY LOCATION: 31513 Needs Creek RD
 NEW REPAIR EXPANSION SUBDIVISION: South Creek LOT # 100
 Type of Structure: SFD Site Improvements required prior to Construction Authorization Issuance:
 Proposed Wastewater System Type: 25% TSSDU STW
 Projected Daily Flow: 360 GPD
 Number of bedrooms: 3 Number of Occupants: 6 max
 Basement Yes No
 Pump Required: Yes No May be required based on final location and elevations of facilities
 Type of Water Supply: Community Public Well Distance from well _____ feet
 Permit conditions: _____ Permit valid for: Five years No expiration

Authorized State Agent: James E. Manhart JR REHS Date: 5-9-23 SEE ATTACHED SITE SKETCH
 The issuance of this permit by the Health Department in no way guarantees the issuance of other permits. The permit holder is responsible for checking with appropriate governing bodies in meeting their requirements. This site is subject to revocation if the site plan, plat, or the intended use changes. The Improvement Permit shall not be affected by a change in ownership of the site. This permit is subject to compliance with the provisions of the Laws and Rules for Sewage Treatment and Disposal and to conditions of this permit.

Construction Authorization

(Required for Building Permit)

The construction and installation requirements of Rules .1950, .1952, .1954, .1955, .1956, .1957, .1958, and .1959 are incorporated by references into this permit and shall be met. Systems shall be installed in accordance with the attached system layout.

ISSUED TO: Watermark Homes INC PROPERTY LOCATION: 31513 Needs Creek RD
 SUBDIVISION: South Creek LOT # 100
 Facility Type: SFD New Expansion Repair
 Basement? Yes No Basement Fixtures? Yes No
 Type of Wastewater System** 25% TSSDU STW System (Initial) Wastewater Flow: 360 GPD
 (See note below, if applicable
50% TSSDU STW TPBS (Repair)
 Installation Requirements/Conditions
 Septic Tank Size 1000 gallons Number of trenches 3
 Pump Tank Size 1000 gallons Exact length of each trench 120 feet
 Trenches shall be installed on contour at a Trench Spacing: 9 Feet on Center
 Maximum Trench Depth of: 18-20" max inches Soil Cover: 6 inches
 (Trench bottoms shall be level to +/-1/4" (Maximum soil cover shall not exceed 36" above the trench bottom)
 in all directions)
 Pump Requirements: _____ ft. TDH vs. _____ GPM Aggregate Depth: 6 inches below pipe
2 inches above pipe
 Conditions: _____ 12 inches total

**WATER LINES (INCLUDING IRRIGATION) MUST BE 10FT. FROM ANY PART OF SEPTIC SYSTEM OR REPAIR AREA.
 NO UTILITIES ALLOWED IN INITIAL OR REPAIR DRAIN FIELD AREA.**

**If applicable: I understand the system type specified is different from the type specified on the application. I accept the specifications of this permit.
 Owner/Legal Representative Signature: _____ Date: _____

This Construction Authorization is subject to revocation if the site plan, plat, or the intended use changes. The Construction Authorization shall not be transferred when there is a change in ownership of the site. This Construction Authorization is subject to compliance with the provisions of the Laws and Rules for Sewage Treatment and Disposal and to the conditions of this permit. SEE ATTACHED SITE SKETCH

Authorized State Agent: James E. Manhart JR REHS Date: 5-9-23
 Construction Authorization Expiration Date: 5-9-28

Application # SPD 2304-0039

Harnett County Department of Public Health Site Sketch

Property Location: SR 1513 NEELLS CREEK RD
Issued To: Watermark Homes Inc Subdivision South Creek Lot # 100
Authorized State Agent: James E. Manhart SPD 12548 Date: 5-9-23

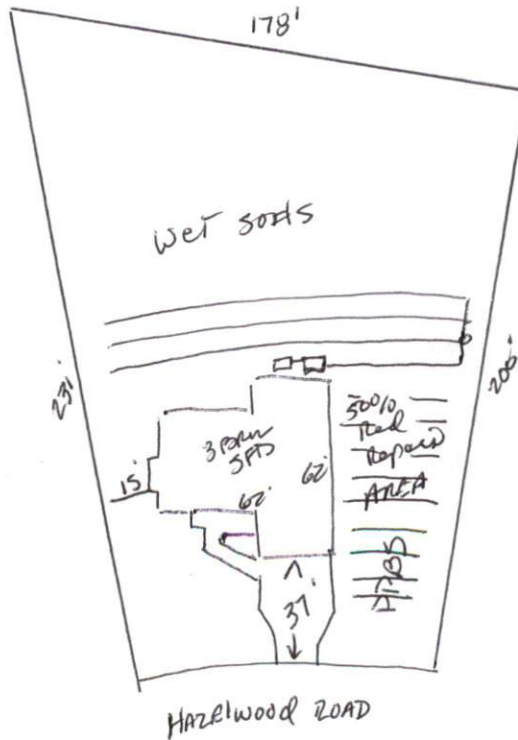

This drawing is for illustrative purposes only. System installation must meet all pertinent laws, rules, and regulations.