

This section for Local Health Department use only.

PART 2: LHD Completeness Review of the Notice of Intent to Construct

"(c) Completeness Review for Notice of Intent to Construct. – The local health department shall determine whether a notice of intent to construct, as required pursuant subsection (b) of this section, is complete within 15 business days after the local health department receives the notice of intent to construct. A determination of completeness means that the notice of intent to construct includes all of the required components. If the local health department determines that the notice of intent to construct is incomplete, the department shall notify the owner or the professional engineer of the components needed to complete the notice. The owner or professional engineer may submit additional information to the department to cure the deficiencies in the notice. The local health department shall make a final determination as to whether the notice of intent to construct is complete within 10 business days after the department receives the additional information from the owner or professional engineer. If the department fails to act within any time period set out in this subsection, the owner or professional engineer may treat the failure to act as a determination of completeness."

The review for completeness of this Notice of Intent was conducted in accordance with G.S. 130A-336.1(c). This NOI is determined to be:

INCOMPLETE (If box is checked, Information in this section is required.)

Based upon review of information submitted in Part 1, the following items are missing: _____

Copies of this form listing missing items were sent to the design PE and the Owner on _____

Date

via _____ with directions to re-submit missing items using Page 5 of this form.

Email, FAX, USPS, hand-delivered

Print Name of Authorized Agent of the LHD

Signature of Authorized Agent of the LHD

Date

COMPLETE (If box is checked, information in this section is required.)

Based upon review of information submitted in Part 1 of this form, this NOI is deemed COMPLETE.

Copies of this signed form were sent to the design PE and the Owner on 4-27-23 via Email

Date

Email, FAX, USPS, hand-delivered

A copy of this NOI and tracking information was sent to the State on 4-27-23 via Email

Date

Email, FAX, USPS, hand-delivered

Martha Osborne REHS

Print Name of Authorized Agent of the LHD

Moh A REHS

Signature of Authorized Agent of the LHD

4-27-23

Date



NC DEPARTMENT OF
**HEALTH AND
HUMAN SERVICES**

ROY COOPER • Governor
KODY H. KINSLEY • Secretary
HELEN WOLSTENHOLME • Interim Deputy Secretary for Health
MARK T. BENTON • Assistant Secretary for Public Health
Division of Public Health

COMMON FORM FOR ENGINEERED OPTION PERMIT
See Instructions for Use in Appendix A

Except for "Date received", this Section to be completed by the Professional Engineer licensed in accordance with G.S. 89C

LHD USE ONLY: Initial submittal of this NOI received: 4-27-23 by MLA
Date Initials

PART 1: Notice of Intent to Construct (NOI) - Please check all that apply

Single System or Multiple Systems

AND

New Expansion Relocation of all or part of the Existing System Relocation of Repair Area

Repair – LHD Permit Number _____ Repair – EOP/LSS COVID 19/AOWE Permit Number _____

1. Facility Owner's name: (Owner, Company Name, Utility, Partnership, Individual, etc.): _____

XCESSIVE RISK DEVELOPMENT

Mailing address: 8754 REED DR STE 14 City: EMERALD ISLE State: NC Zip: 28594

Telephone number: 252-777-0141 E-mail Address: ATHAN.PARKER@AMPDENGINEERING.COM

2. Professional Engineer (PE) name: ATHAN M PARKER, PE License number: 43250

Mailing address: PO BOX 4580 City: EMERALD ISLE State: NC Zip: 28594

Telephone number: 919-795-9594 E-mail Address: ATHAN.PARKER@AMPDENGINEERING.COM

3. Licensed Soil Scientist (LSS) name: HAYWOOD PITTMAN, LSS License number: 1262

Mailing address: 1073-1 GREGORY FORK RD City: RICHLANDS State: NC Zip: 28574

Telephone number: 910-324-2892 E-mail Address: PITTMANSOIL@YAHOO.COM

4. Licensed Geologist (LG) (if applicable) name: _____ License number: _____

Mailing address: _____ City: _____ State: _____ Zip: _____

Telephone number: _____ E-mail Address: _____

5. On-Site Wastewater Contractor name: HAYWOOD PITTMAN, LSS License number: 3825

Mailing address: 1073-1 GREGORY FORK RD City: RICHLANDS State: NC Zip: 28574

Telephone number: 910-324-2892 E-mail Address: PITTMANSOIL@YAHOO.COM

6. Proof of Errors and Omissions or other appropriate liability insurance for the following persons is attached that includes the name of the insurer, name of the insured and the effective dates of coverage:

PE LSS LG On-site Wastewater Contractor

NC DEPARTMENT OF HEALTH AND HUMAN SERVICES • DIVISION OF PUBLIC HEALTH

LOCATION: 5605 Six Forks Road, Raleigh, NC 27609
MAILING ADDRESS: 1642 Mail Service Center, Raleigh, NC 27699-1642
www.ncdhhs.gov • TEL: 919-707-5874 • FAX: 919-845-3972

AN EQUAL OPPORTUNITY / AFFIRMATIVE ACTION EMPLOYER

- 7. Property location (physical address, tax parcel identification number or subdivision lot, block number of the property to be permitted): 153 HARMONY TRL; HAVEN LOT 54
County Name: HARNETT
- 8. Type of facility: Place of residence No. Bedrooms: 3 No. Occupants: 6
 Place of business Basis for flow calculation: _____
 Place of public assembly Basis for flow calculation: _____
- 9. Factors that would affect the wastewater load: NO KNOWN FACTORS TO AFFECT LOADING
- 10. Type and location of proposed wastewater system: 4-38' PANEL BLOCK LINES, TYPE III, 18-22" TB; LOCATED 15' FROM THE EAST PROPERTY BOUNDARY AND 58' FROM THE SOUTH PROPERTY BOUNDARY (LOCATED SOUTH OF PROPOSED HOME)
- 11. Design wastewater flow: 360 gpd (For flow > 3,000 gpd and industrial process, duplicate plans shall be sent to the State.)
Design wastewater strength: domestic high strength industrial process
- 12. A plat as defined in G.S. 130A-334(7a) is attached: Yes No
- 13. Location of proposed or existing wells (drinking water, irrigation, geothermal, groundwater monitoring, sampling, etc.) and any potable and non-potable water conveyance lines is indicated on attached plans and complies with 15A NCAC 18A .1950: Yes No
This is a saprolite system. Yes No
- 14. Evaluation(s) of soil conditions and site features in accordance with G.S. 130A-335(a1) signed and sealed by a LSS is attached: Yes No
- 15. Evaluation of geologic and hydrogeologic conditions signed and sealed by a LG is attached Yes NA
- 16. Proposed landscape, site, drainage, or soil modifications are attached: Yes NA

Attestation by Professional Engineer licensed in North Carolina pursuant to G.S. 89C

I, ATHAN M PARKER, PE hereby attest that the information required to be included with this Notice of Intent to Construct is accurate and complete to the best of my knowledge and that the proposed system shall meet applicable federal, State, and local laws, regulations, rules, and ordinances in accordance with G.S. 130A-336-.1(e)(6).

Signature of Licensed Professional Engineer Date

Digitally signed by ATHAN M. PARKER
DN: cn=ATHAN M. PARKER, PE, c=US, o=AMPD ENGINEERING, PLLC, email=ATHAN.PARKER@AMPDENGINEERING.COM
Date: 2023.04.10 14:04:09 -0400



This section is for Owner use to either designate PE as their legal representative or to self-submit the NOI.

Designation of Registered Professional Engineer as legal representative of Owner for this Notice of Intent:

I, ATHAN M PARKER FOR
XCESSIVE RISK DEVELOPMENT hereby designate ATHAN M PARKER, PE
Print Name of Owner *Print Name of Registered Professional Engineer*

as my legal representative for purposes of this Notice of Intent pursuant to G.S. 130A-336.1.

Signature of Owner  Digitally signed by ATHAN M. PARKER
PE
DN: cn=ATHAN M. PARKER, PE, o=US, ou=AMPD ENGINEERING, PLLC, email=ATHAN.PARKER@AMPEENGINEERING.COM
Date: 2023.04.10 14:05:07 -0400 _____
Date

Owner self-submittal of NOI:

I, _____ hereby submit this NOI prepared by _____
Print Name of Owner *Print Name of Licensed PE*

pursuant to G.S. 130A-336.1.

Signature of Owner _____
Date

NOTES:

LIABILITY: *The Department, the Department's authorized agents, or local health departments shall have no liability for wastewater systems designed, constructed, and installed pursuant to an Engineer Option Permit [G.S. 130A-336.1(f)]*

RIGHT OF ENTRY: *The submittal of this Notice of Intent to Construct grants right of entry to the Local Health Department and the State to the referenced property.*

ISSUANCE OF BUILDING PERMIT: *Once the LHD deems that the Notice of Intent to Construct is complete via signature in the section below, the owner may apply to the local permitting agency for a permit for electrical, plumbing, heating, air conditioning or other construction, location, or relocation activity under any provision of general or special law pursuant to G.S. 130A-338.*

Owner: HAVEN S/D
 Address: LOT 54
 Location: HARMONY TRAIL

PITTMAN SOIL CONSULTING
PO BOX 1387
RICHLANDS, NC 28574
910-330-2784
pittmansoil@yahoo.com

LOT INFORMATION OBTAINED VIA PLAT BY STANCIL AND ASSOCIATES FOR XCESSIVE RISK DEVELOPMENT, DATED APRIL 27, 2019.

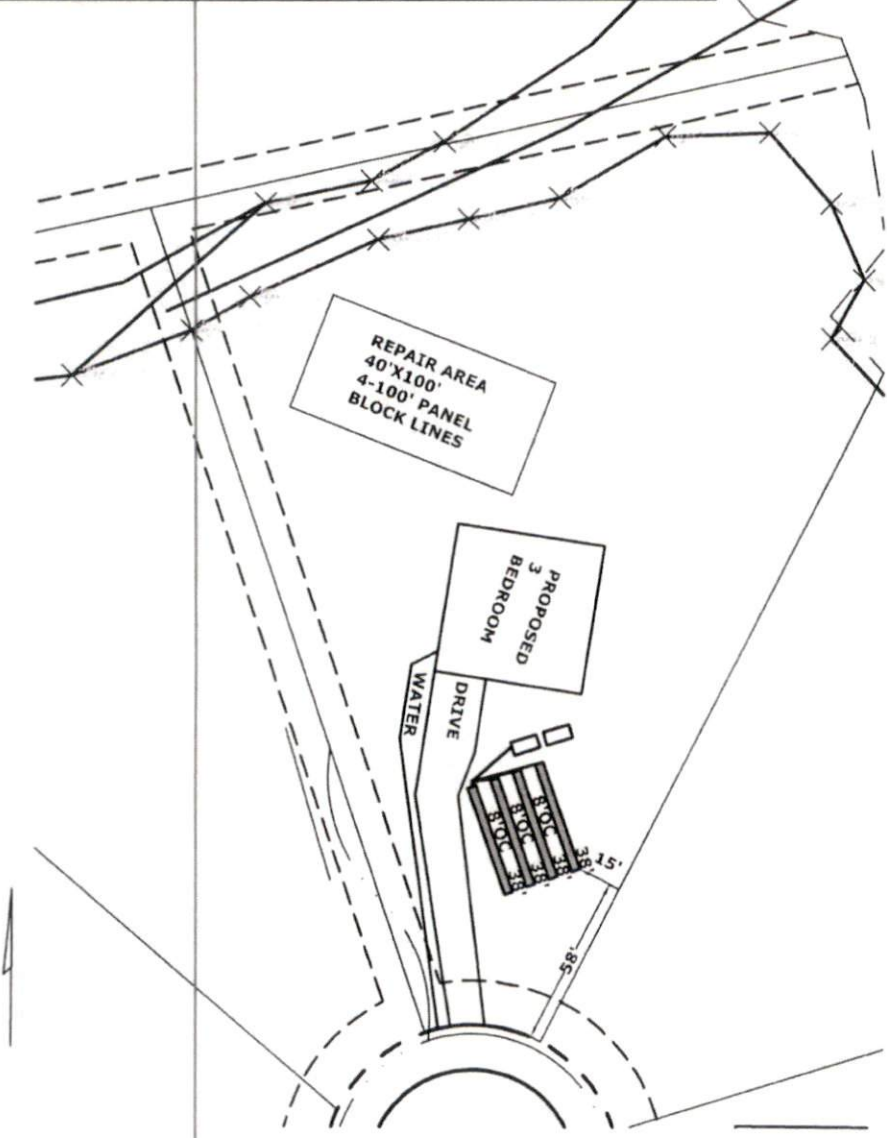

- INITIAL**
- 3 BEDROOM
- LTAR .4
- 4-38' PANEL BLOCK LINES
- 14-22" TB
- >6" SOIL COVER REQUIRED OVER SYSTEM AND 5' BEYOND SYSTEM
- REPAIR AREA**
- 3 BEDROOM
- LTAR .12
- 5-100' PANEL BLOCK LINES
- 14" TB
- >6" SOIL COVER REQUIRED OVER SYSTEM AND 5' BEYOND SYSTEM

SCALE 1"=60'

Pittman Soil Consulting

1003 Gregory Fork Road

Richlands, NC 28574

Phone (910)330-2784

pittmansoil@yahoo.com

MARCH 29, 2023

Ref: HAVEN Lot 54, HARNETT COUNTY

A soil evaluation was conducted on the above referenced tract to determine the sites suitability for septic. The current laws and rules of NC was used as guide for this evaluation.

Hand Auger borings on the site were used to characterize the soil texture, and depth to the soil wetness condition. The attached plot plan shows the location of the septic system in the most ideal location on the site. The soil wetness condition was found to be 26-34" from the surface with a clay loam texture. I have assigned an LTAR of 0.4 gpd/sqft for a 360 gpd 3 bedroom residence. This will require the installation of 4-38' HORZ. PANEL BLOCK lines that shall be installed in accordance with the current rules. The depth to soil wetness of 26-34" would constitute a 14-22" trench bottom. The system will require 6' soil cover that shall extend 5' from the edge of the system. The system will require a 1000 gallon septic tank and a 1000 gallon pump tank.

The repair area will require 5-100' HORZ. PANEL BLOCK lines installed at a depth of 14" from the surface (LTAR 0.12).

After installation the site should be landscaped to shed surface water. Any alterations to the site may impact soil conditions.

If you have any questions please feel free to contact me at 910-330-2784. Thank You.

Sincerely,



R. HAYWOOD PITTMAN II

R. Haywood Pittman II
NC Licensed Soil Scientist