

VICINITY MAP
Not To Scale

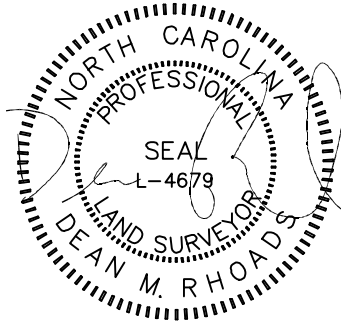

IMPERVIOUS SURFACE AREA	
DESCRIPTION	AREA
HOUSE w/ PORCH	1,168 S.F.
SCR PORCH/HVAC	109 S.F.
DRIVEWAY & WALKS	350 S.F.
TOTAL (PROPOSED)=	1,627 S.F.
*TOTAL (ALLOWED)=	2,300 S.F.

*PB 2022 PG 419

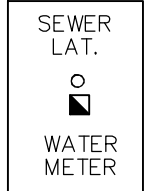

SETBACKS: PB 2022 PG 419

FRONT - 20'
REAR - 20'
SIDE - 4'
CORNER YARD - 12'

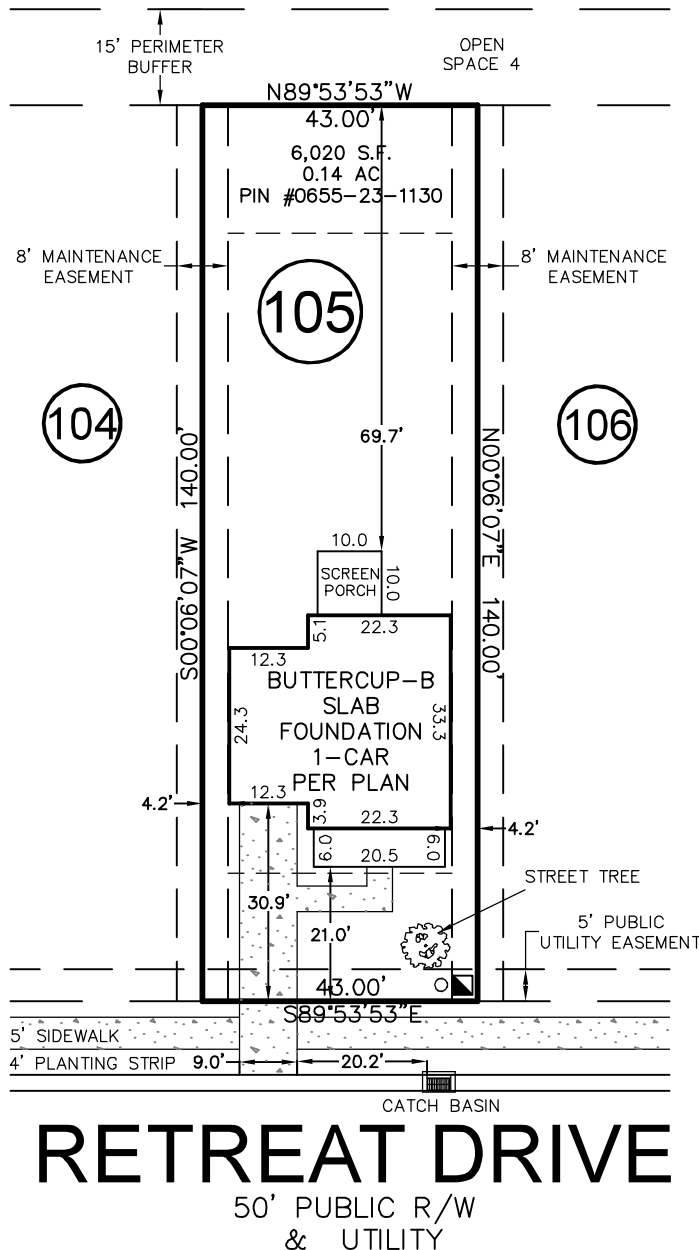
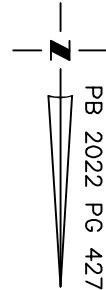

RETREAT DRIVE

50' PUBLIC R/W
& UTILITY

THIS DRAWING DOES NOT REFLECT AS-BUILT INFORMATION

PRELIMINARY PLAT
NOT FOR RECORDATION, CONVEYANCES, OR SALES.

THIS PROPERTY MAY BE SUBJECT TO ANY AND ALL APPLICABLE DEED RESTRICTIONS, EASEMENTS, RIGHT-OF-WAY, UTILITIES AND RESTRICTIVE COVENANTS WHICH MAY BE OF RECORD OR IMPLIED

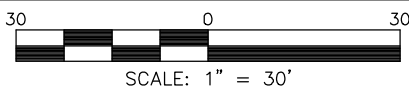

RESIDENTIAL LAND SERVICES, PLLC.

1917 Evans Road
Cary, North Carolina 27513
Phone (919) 378-9316
Firm License # P-0873

HOUSE LOCATION PLOT PLAN

FOR
#134 RETREAT DRIVE
LOT 105, SERENITY SUBDIVISION, PHASE 1 (LOTS LESS THAN 9,000 SF)
Hector's Creek Township, Harnett County, North Carolina

PROPERTY OF: _____ GARMAN HOMES _____
MAP BOOK 2022 PAGE 419-433 DEED REFERENCE _____

DRAWN: JLS SURVEYED: N/A CHECKED: DMR DATE: MARCH 20, 2023