

AUGUST 1, 2016

STANDARD REPAIR DETAIL FOR DRILLING HOLES IN A FLOOR TRUSS

MII-REP14

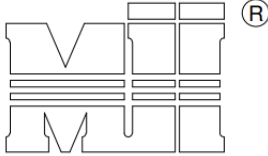

MiTek USA, Inc.



NOTES:

1. THIS REPAIR DETAIL IS TO BE USED ONLY FOR THE APPLICATION SHOWN BELOW. THIS REPAIR DOES NOT THAT THE REMAINING PORTION OF THE TRUSS IS UNDEAMAGED. THE ENTIRE TRUSS SHALL BE INSPECTE THAT NO FURTHER REPAIRS ARE REQUIRED. WHEN THE REQUIRED REPAIRS ARE PROPERLY APPLIED, T WILL BE CAPABLE OF SUPPORTING THE LOADS INDICATED.
2. LUMBER MUST BE DRILLED CLEANLY AND ACCURATELY AND THE REMAINING WOOD MUST BE UNDEAMAGE
3. THIS REPAIR IS TO BE USED FOR SINGLE PLY TRUSSES WITH SINGLE CHORDS WITH 40-10-0-5 LOADING IN 4X_ ORIENTATION ONLY.
5. NO ADDITIONAL UNIFORM OR CONCENTRATED LOADS PERMITTED W/ THIS DETAIL.
6. ALL HOLES MUST BE DRILLED WITHIN $\pm 1/2"$ OF THE CENTERLINE OF THE 2X4 MEMBERS.

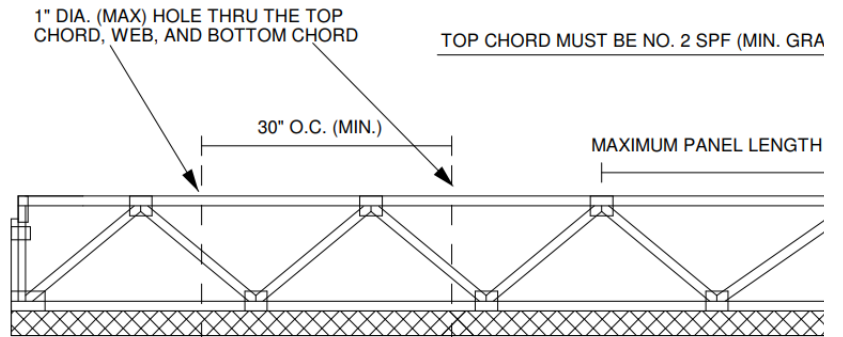
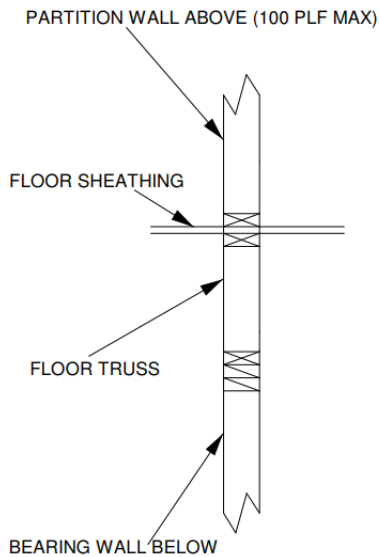

FLOOR TRUSS MUST BE SUPPORTED THROUGH ENTIRE LENGTH BY A CONTINUOUS BEARING WA

REFER TO INDIVIDUAL TRUSS DESIGN FOR PLATE SIZES AND LUMBER GRADES

NO MORE THAN SIX HOLES MAY BE DRILLED IN ONE TRUSS

TRUSS SPACING: 24" O.C. (MAX.)

LOADING

TCLL = 40 PSF
 TCDL = 10 PSF
 BCLL = 0 PSF
 BCDL = 5 PSF