

App# SFD 2303

0083

Harnett County Department of Public Health Improvement Permit

318 Hazelwood

A building permit cannot be issued with only an Improvement Permit

ISSUED TO: Cumberland Homes PROPERTY LOCATION: SR 1513 Neells Creek RD
 NEW REPAIR EXPANSION SUBDIVISION: South Creek LOT # 106
 Type of Structure: SFD Site Improvements required prior to Construction Authorization Issuance:
 Proposed Wastewater System Type: 25% (B) (C) (D) (E) (F) (G) (H) (I) (J) (K) (L) (M) (N) (O) (P) (Q) (R) (S) (T) (U) (V) (W) (X) (Y) (Z)
 Projected Daily Flow: 360 GPD
 Number of bedrooms: 3 Number of Occupants: 6 max
 Basement Yes No
 Pump Required: Yes No May be required based on final location and elevations of facilities
 Type of Water Supply: Community Public Well Distance from well _____ feet Permit valid for: Five years
 Permit conditions: _____ No expiration

Authorized State Agent: James E. Manhart Date: 4-13-23 SEE ATTACHED SITE SKETCH
 The issuance of this permit by the Health Department in no way guarantees the issuance of other permits. The permit holder is responsible for checking with appropriate governing bodies in meeting their requirements. This site is subject to revocation if the site plan, plat, or the intended use changes. The Improvement Permit shall not be affected by a change in ownership of the site. This permit is subject to compliance with the provisions of the Laws and Rules for Sewage Treatment and Disposal and to conditions of this permit.

Construction Authorization (Required for Building Permit)

The construction and installation requirements of Rules .1950, .1952, .1954, .1955, .1956, .1957, .1958, and .1959 are incorporated by references into this permit and shall be met. Systems shall be installed in accordance with the attached system layout.

ISSUED TO: Cumberland Homes Inc PROPERTY LOCATION: SR 1513 Neells Creek RD
 SUBDIVISION: South Creek LOT # 106
 Facility Type: SFD New Expansion Repair
 Basement? Yes No Basement Fixtures? Yes No
 Type of Wastewater System** 25% (B) (C) (D) (E) (F) (G) (H) (I) (J) (K) (L) (M) (N) (O) (P) (Q) (R) (S) (T) (U) (V) (W) (X) (Y) (Z) System (Initial) Wastewater Flow: 360 GPD
 (See note below, if applicable 25%/50% (B) (C) (D) (E) (F) (G) (H) (I) (J) (K) (L) (M) (N) (O) (P) (Q) (R) (S) (T) (U) (V) (W) (X) (Y) (Z) (Repair)
 Installation Requirements/Conditions
 Septic Tank Size 1000 gallons Number of trenches 3
 Pump Tank Size 1000 gallons Exact length of each trench 100 feet
 Trench Spacing: 7 Feet on Center
 Trenches shall be installed on contour at a Maximum Trench Depth of: 18-20 inches (Maximum soil cover shall not exceed 36" above the trench bottom)
 (Trench bottoms shall be level to +/- 1/4" in all directions)
 Pump Requirements: _____ ft. TDH vs. _____ GPM
 Aggregate Depth: 6 inches below pipe
2 inches above pipe
12 inches total
 Conditions: _____

**WATER LINES (INCLUDING IRRIGATION) MUST BE 10FT. FROM ANY PART OF SEPTIC SYSTEM OR REPAIR AREA.
NO UTILITIES ALLOWED IN INITIAL OR REPAIR DRAIN FIELD AREA.**

**If applicable: I understand the system type specified is different from the type specified on the application. I accept the specifications of this permit.
Owner/Legal Representative Signature: _____ Date: _____

This Construction Authorization is subject to revocation if the site plan, plat, or the intended use changes. The Construction Authorization shall not be transferred when there is a change in ownership of the site. This Construction Authorization is subject to compliance with the provisions of the Laws and Rules for Sewage Treatment and Disposal and to the conditions of this permit. SEE ATTACHED SITE SKETCH

Authorized State Agent: James E. Manhart Date: 4-13-23
 Construction Authorization Expiration Date: 4-13-28

Application # SFD 2303-0083

Harnett County Department of Public Health Site Sketch

Property Location: 511513 NEEDS CREEK RD

Issued To: Cumberland Home Inc Subdivision SOUTH CREEK Lot # 106

Authorized State Agent: James E. Manhart #128945 Date: 4-13-23

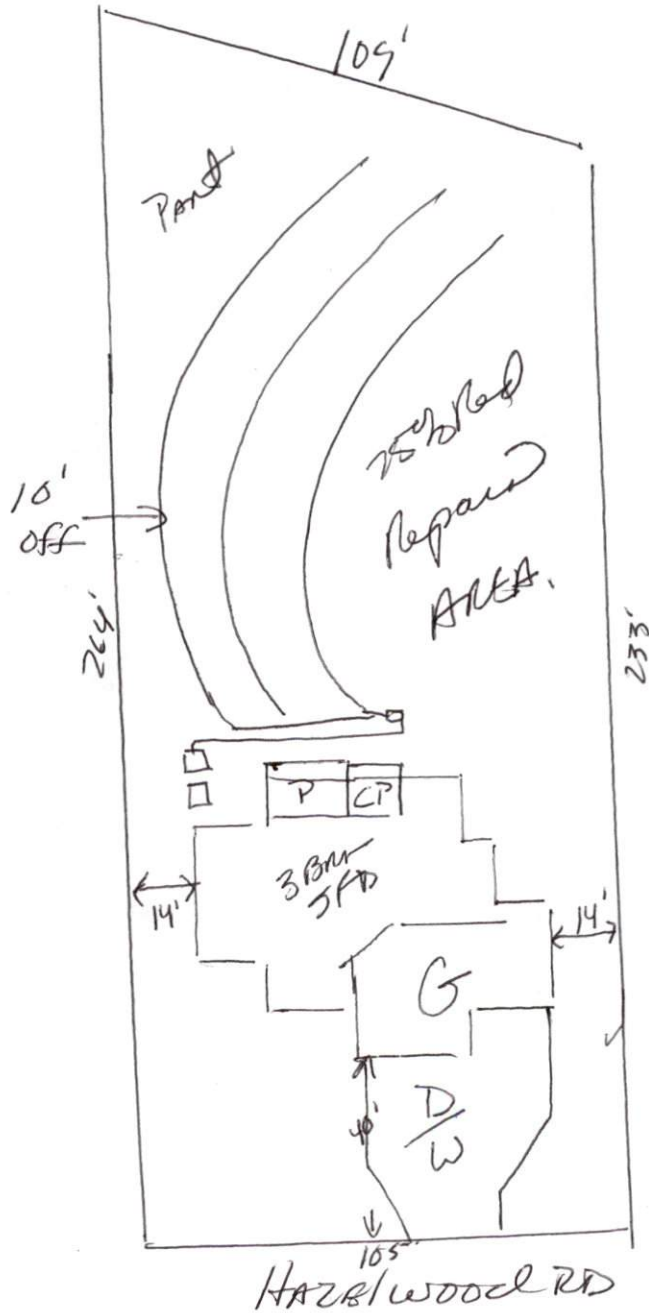

This drawing is for illustrative purposes only. System installation must meet all pertinent laws, rules, and regulations.