

Harnett County Department of Public Health Improvement Permit

7882 NC 22E

A building permit cannot be issued with only an Improvement Permit

PROPERTY LOCATION: Hwy 27E
SUBDIVISION _____ LOT # 5

ISSUED TO: Southern Built LLC
NEW REPAIR EXPANSION

Site Improvements required prior to Construction Authorization Issuance:

Type of Structure: SFD
Proposed Wastewater System Type: 25% REDUCTION
Projected Daily Flow: 360 GPD
Number of bedrooms: 3 Number of Occupants: 6 max

Basement Yes No
Pump Required: Yes No May be required based on final location and elevations of facilities
Type of Water Supply: Community Public Well Distance from well _____ feet
Permit conditions: _____

Permit valid for: Five years
 No expiration

Authorized State Agent: James E. Marshall Date: 4-6-23 SEE ATTACHED SITE SKETCH

The issuance of this permit by the Health Department in no way guarantees the issuance of other permits. The permit holder is responsible for checking with appropriate governing bodies in meeting their requirements. This site is subject to revocation if the site plan, plat, or the intended use changes. The Improvement Permit shall not be affected by a change in ownership of the site. This permit is subject to compliance with the provisions of the Laws and Rules for Sewage Treatment and Disposal and to conditions of this permit.

Construction Authorization (Required for Building Permit)

The construction and installation requirements of Rules .1950, .1952, .1954, .1955, .1956, .1957, .1958, and .1959 are incorporated by references into this permit and shall be met. Systems shall be installed in accordance with the attached system layout.

ISSUED TO: Southern Built LLC PROPERTY LOCATION: Hwy 27E
SUBDIVISION _____ LOT # 5

Facility Type: SFD New Expansion Repair
Basement? Yes No Basement Fixtures? Yes No
Type of Wastewater System** 25% REDUCTION System (Initial) Wastewater Flow: 360 GPD
(See note below, if applicable 25%/50% REDUCTION (Repair))

Installation Requirements/Conditions
Septic Tank Size 1000 gallons
Pump Tank Size 1000 gallons
Number of trenches 3
Exact length of each trench 100 feet
Trench Spacing: 9 Feet on Center
Trenches shall be installed on contour at a
Soil Cover: 6 inches
Maximum Trench Depth of: 20-18 inches (Maximum soil cover shall not exceed 36" above the trench bottom)
(Trench bottoms shall be level to +/- 1/4" in all directions)

Pump Requirements: _____ ft. TDH vs. _____ GPM
Aggregate Depth: 6 inches below pipe
2 inches above pipe
Conditions: * Pump May NOT BE NEEDED pending Plumbing STUB OUT 12 inches total

WATER LINES (INCLUDING IRRIGATION) MUST BE 10FT. FROM ANY PART OF SEPTIC SYSTEM OR REPAIR AREA.
NO UTILITIES ALLOWED IN INITIAL OR REPAIR DRAIN FIELD AREA.

**If applicable: I understand the system type specified is different from the type specified on the application. I accept the specifications of this permit.

Owner/Legal Representative Signature: _____ Date: _____

This Construction Authorization is subject to revocation if the site plan, plat, or the intended use changes. The Construction Authorization shall not be transferred when there is a change in ownership of the site. This Construction Authorization is subject to compliance with the provisions of the Laws and Rules for Sewage Treatment and Disposal and to the conditions of this permit. SEE ATTACHED SITE SKETCH

Authorized State Agent: James E. Marshall Date: 4-6-23
Construction Authorization Expiration Date: 4-6-28

Application # SFD 2303-0076

Harnett County Department of Public Health Site Sketch

Property Location: STATE Hwy 27E

Issued To: Southern Built LLC Subdivision _____ Lot # 5

Authorized State Agent: James E. Manhart ~~PH~~ REAS Date: 4-6-23

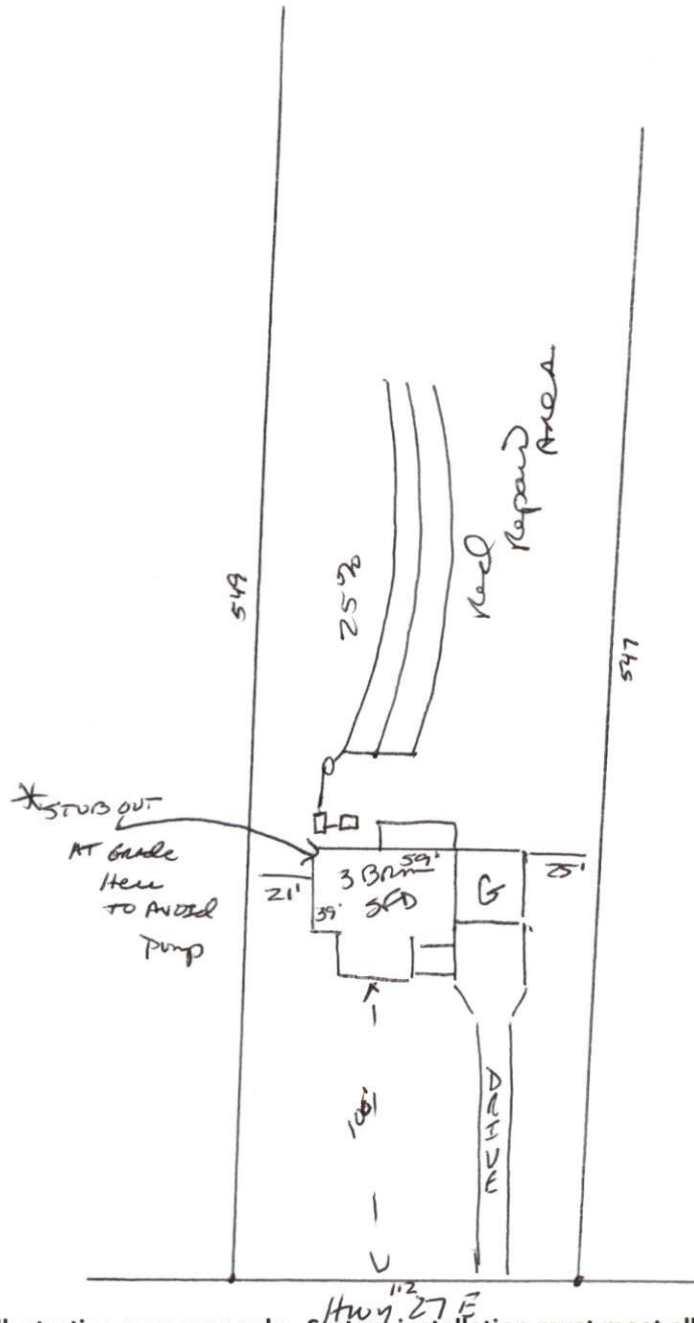

This drawing is for illustrative purposes only. System installation must meet all pertinent laws, rules, and regulations.