

Delma Grimes Road 3-Bedroom Septic Proposal Lot #5

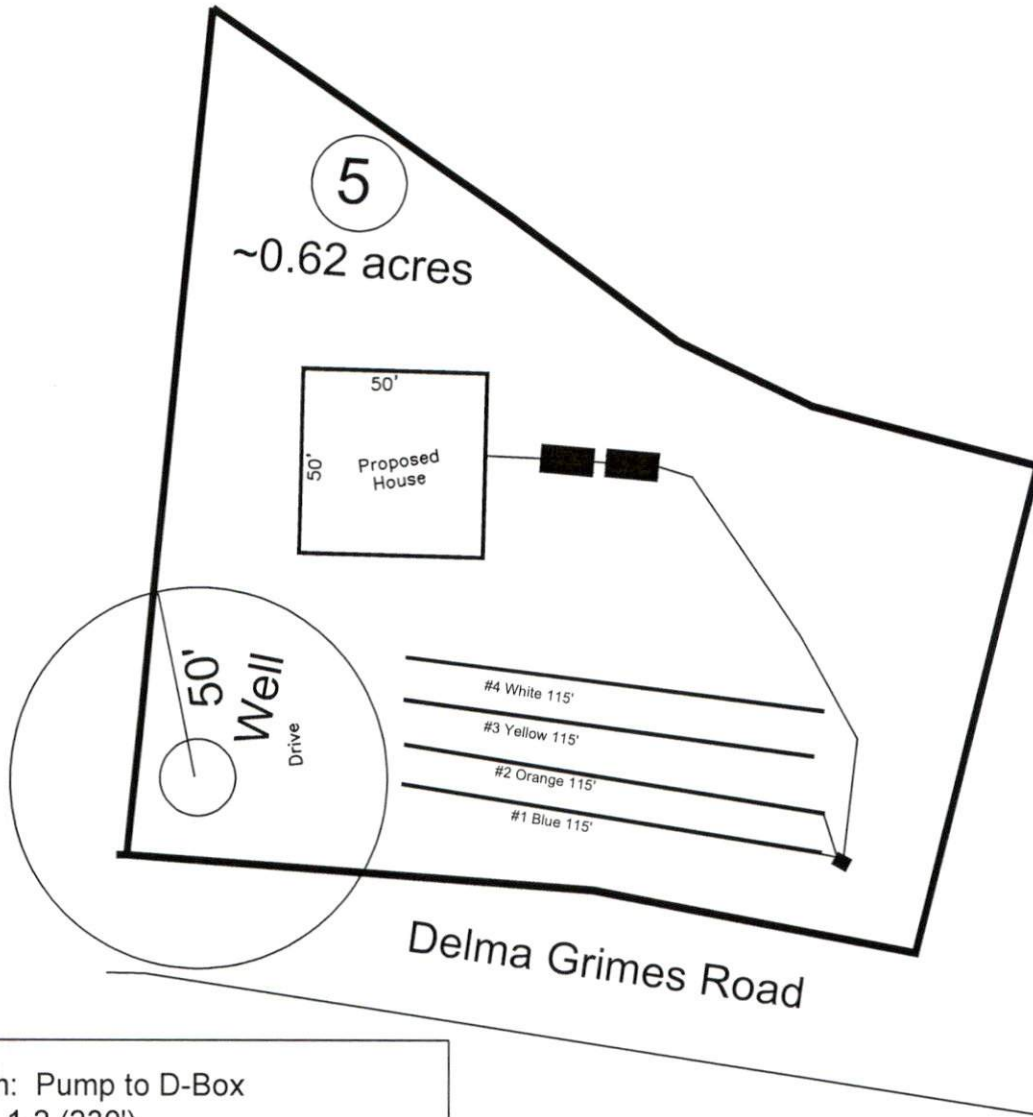

System: Pump to D-Box
Lines: 1-2 (230')
0.4 LTAR
18" Trench Bottom
Accepted Status System
Repair: Pump to D-Box
Lines: 3-4 (230')
0.4 LTAR
18" Trench Bottom
Accepted Status System

GRAPHIC SCALE
1" = 50'



Adams
Soil Consulting
919-414-6761
Job #636